

Tree Protection Detail

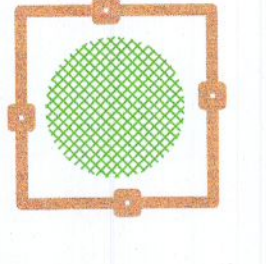

The tree protection fencing is to be erected enclosing the root protection areas around the trees being retained as shown on this drawing and as detailed in appendix 1. In some areas, the site hoarding may be sufficient to act as the fencing for the trees. Any areas where the fencing is not sufficient, the fencing works are discussed and agreed at the initial site meeting.

Where tree protection fencing is needed, this will need to be 2.3m high and constructed in accordance with Figure 2 of BS 5837:2012 (see detail on drawing & specification). The fencing is to be 2.3m wide and made of 100mm x 100mm galvanneal steel mesh panels (fence panels) are to be securely fixed with wire or scaffold chairs.

Signs are to be attached to fence warning people that this is a protective fence and not to be removed or tampered with. Signs are to be placed in accordance with the approved plans and drawings for this development.

Access paths need to be included in each section of fencing to allow for grass and other maintenance works. This should be a section of fencing 3m long which can be unhooked and removed with ease to allow access for maintenance. All other fences are to be kept in place and locked.

Once the protective fence line is erected, then the main construction works can commence on site.

During the construction works the following is required:

- The main contractor or site manager is to brief all people working on site on the use of protective measures and the procedure if work needs to be carried out near the trees.
- Storage of Material. Work, Yards and staff car parking - are to be identified on site and marked with cones and flags. All material, debris or any other equipment are to be stored outside the root protection areas around the trees being retained. The main contractor or site manager is to check the tree protective fencing and carry out any repairs required to ensure it stays upright and secure.
- The main contractor or site manager is to liaise with the project Arboriculturist to ensure that all work is carried out to the correct standards within the root protection areas around the trees.
- Any works to occur within the protection areas such as landscaping is to be carried out manually and the soil levels are not to be lowered or raised. Any works to occur within the protection areas are to be carried out in accordance with the approved plans and drawings for this development. 8 RPA's of the trees being retained are to be identified on drawing & specification. All construction works are to be removed until all the discussions and agreement with the project arborist.

Prohibited Activities:

- The following is a list of activities that are not allowed within the RPA or within the vicinity of the trees being retained:
- Protect trees from wind damage by erecting windbreaks, screens or other structures.
 - Protect root systems from ponding, erosion, or excessive wetting caused by the construction process.
 - Do not store construction materials, debris, or excavated material inside the protection zones. When excavating, place excavated soil on opposite side of protection zones.
 - Do not permit vehicles or foot traffic within tree protection zones; prevent soil compaction over root systems.
 - Do not attach notices, cables or other services to any part of the tree.
 - Do not use high machinery such as Tele-porters, cranes or other equipment close to trees to avoid damage to the crown or any other parts.

LEGEND

Root Protection Area
Tag Number
Crown Spread
Trunk

- BS 5837:2012 - Category Retention Rating
- Category U <10 years useful life expectancy
- Category A 40+ years useful life expectancy
- Category B 20+ years useful life expectancy
- Category C <20 years useful life expectancy

Trees to be retained
Trees to be removed for development
Hedge to be removed
Hedge to be retained

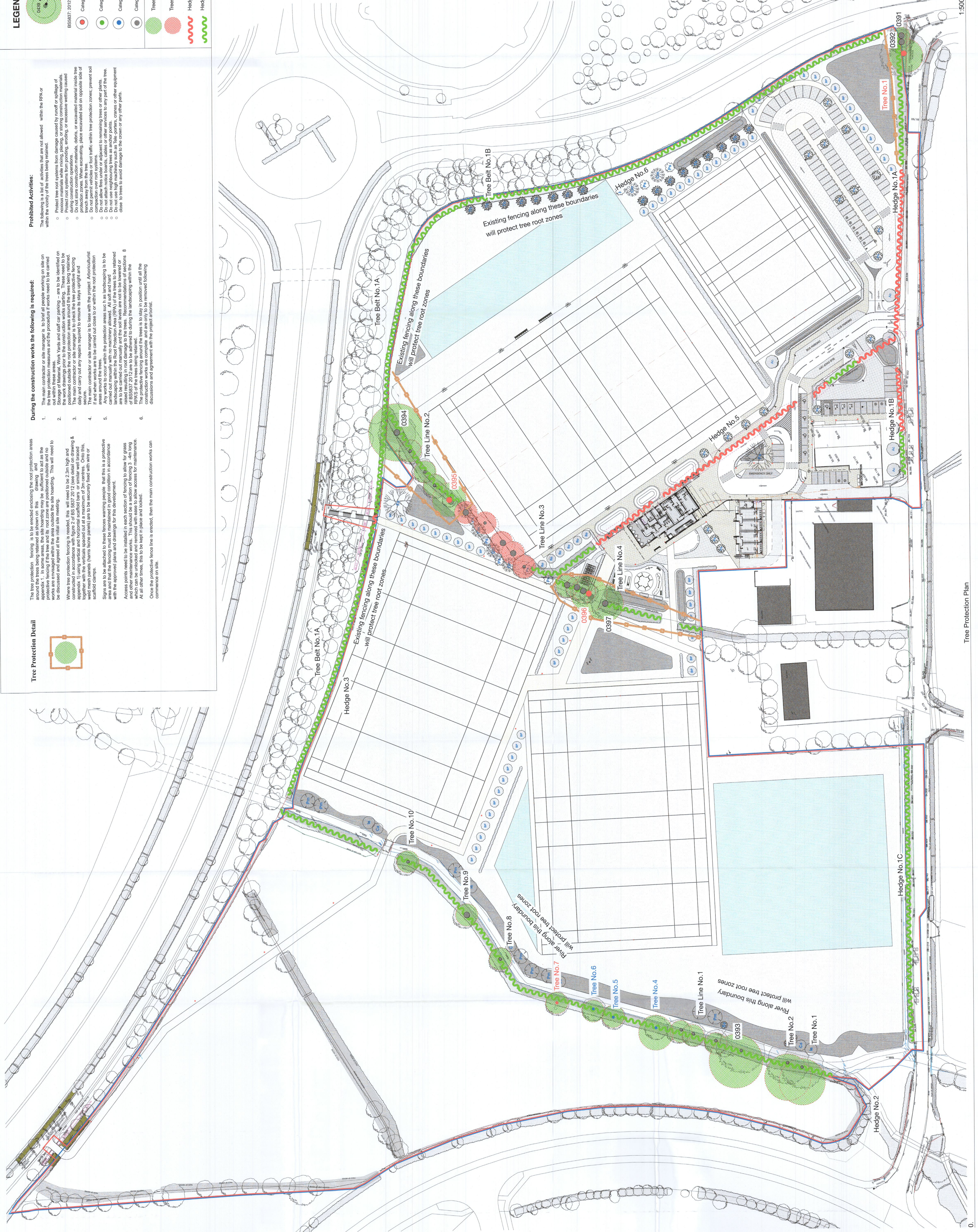

1:500

Tree Protection Plan

0