

Bench Seat Wall Typical Detail
Scale 1:20

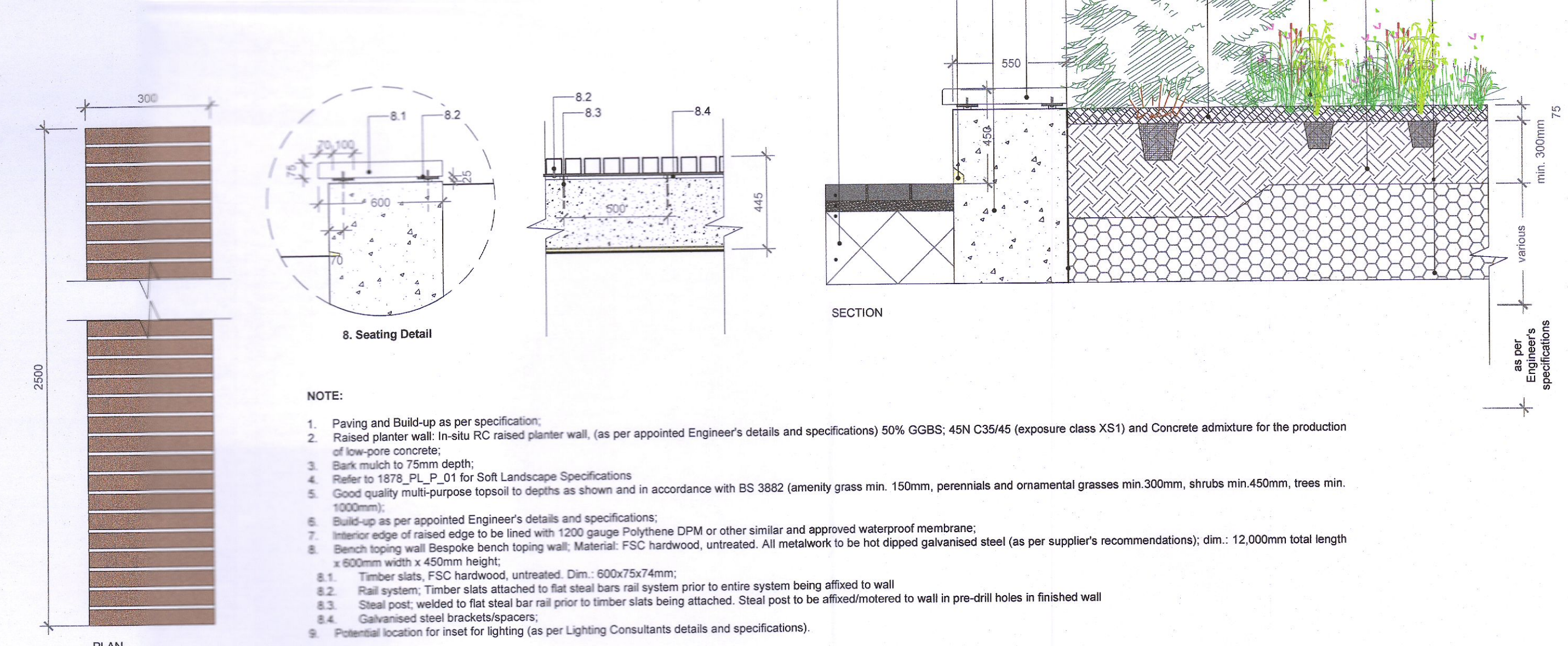

- NOTE:
1. Paving and Build-up as per specification;
 2. Raised planter wall: In-situ RC raised planter wall, (as per appointed Engineer's details and specifications) 50% GGBS, 45N C35/45 (exposure class XS1) and Concrete admixture for the production of low-pore concrete;
 3. Sunk match to 75mm depth;
 4. Refer to 1878_PL_P_01 for Soft Landscape Specifications
 5. Good quality multi-purpose topsoil to depths as shown and in accordance with BS 3882 (amenity grass min. 150mm, perennials and ornamental grasses min.300mm, shrubs min.450mm, trees min. 1000mm);
 6. Build-up as per appointed Engineer's details and specifications;
 7. Interior edge of raised edge to be lined with 1200 gauge Polythene DPM or other similar and approved waterproof membrane;
 8. Bench topping wall Bespoke bench topping wall. Material: FSC hardwood, untreated. All metalwork to be hot dipped galvanised steel (as per supplier's recommendations); dim.: 12,000mm total length x 600mm width x 450mm height;
 - 8.1. Timber slats, FSC hardwood, untreated. Dim.: 600x75x74mm;
 - 8.2. Rail system, Timber slats attached to flat steel bar rail system prior to entire system being affixed to wall
 - 8.3. Steel post; welded to flat steel bar rail prior to timber slats being attached. Steel post to be affixed/rotated to wall in pre-drill holes in finished wall
 - 8.4. Galvanised steel brackets/spacers;
 9. Potential location for inset for lighting (as per Lighting Consultants details and specifications).



Key Plan 1:2000

Handrail to Steps
Scale 1:20

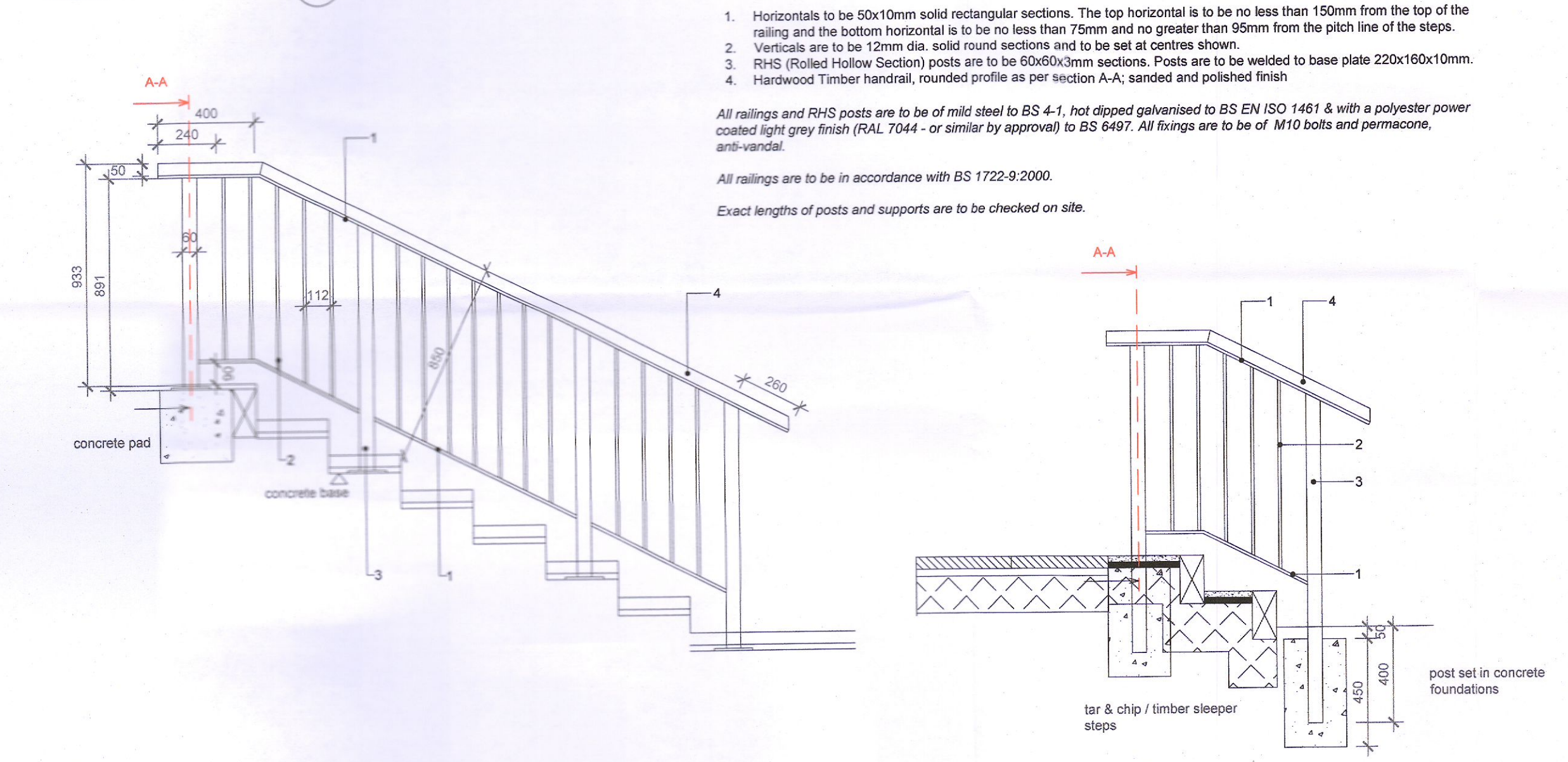

- Notes:
1. Horizontals to be 50x10mm solid rectangular sections. The top horizontal is to be no less than 150mm from the top of the railing and the bottom horizontal is to be no less than 75mm and no greater than 95mm from the pitch line of the steps.
 2. Verticals are to be 12mm dia. solid round sections and to be set at centres shown.
 3. RHS (Rolled Hollow Section) posts are to be 60x60x3mm sections. Posts are to be welded to base plate 220x160x10mm.
 4. Hardwood Timber handrail, rounded profile as per section A-A; sanded and polished finish
- All railings and RHS posts are to be of mild steel to BS 4-1, hot dipped galvanised to BS EN ISO 1461 & with a polyester power coated light grey finish (RAL 7044 - or similar by approval) to BS 6467. All fixings are to be of M10 bolts and permacone, anti-wandal.
- All railings are to be in accordance with BS 1722-9:2000.
- Exact lengths of posts and supports are to be checked on site.

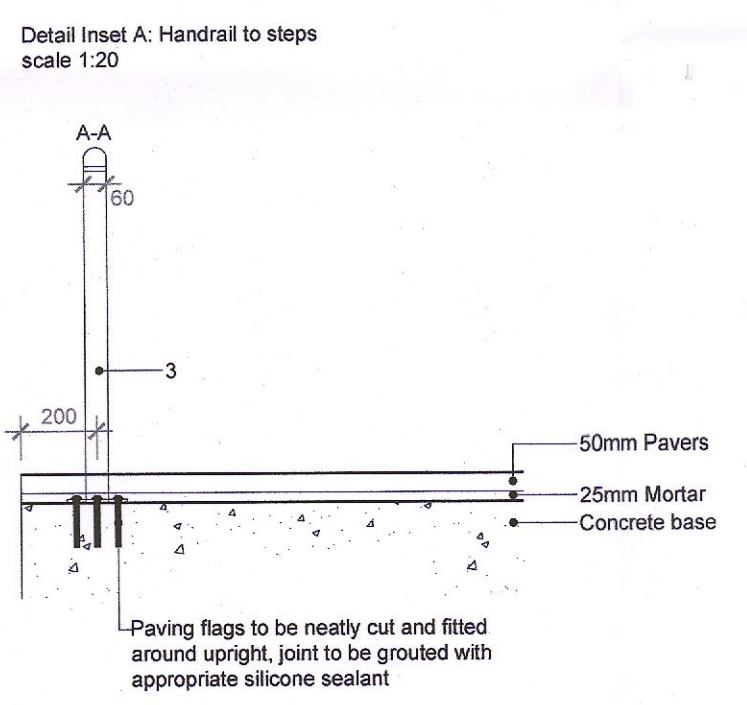

Resin-bound Aggregate To Entrance Plaza
Scale 1:10

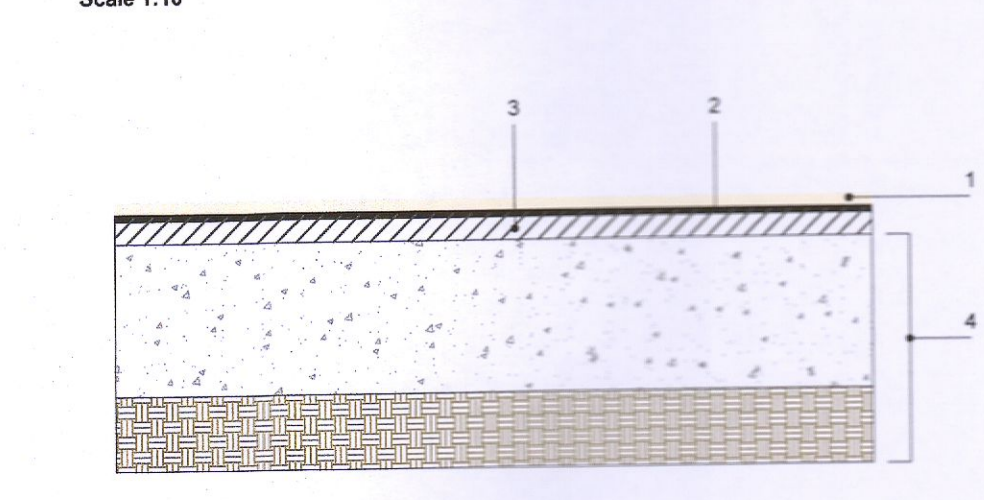

- NOTES:
1. Aggregate surface dressing (Addstone or similar); Depth: 2-6mm; 4-6mm Long Rake Golden Spar aggregate
 2. Surface Protector Coat (e.g. Addstone Surface Protector or similar); is recommended following laying to protect surface from staining and to aid cleaning / chewing gum removal.
 3. Sealer (Addocryl or similar)
 4. 30mm of 10mm Open Graded Macadam Surface Course (Max 125 Pen) to BS 4987 - 1:2003 ref 7.2
 5. Subbase to Engineer's detail

Concrete Block Paving
Scale 1:10

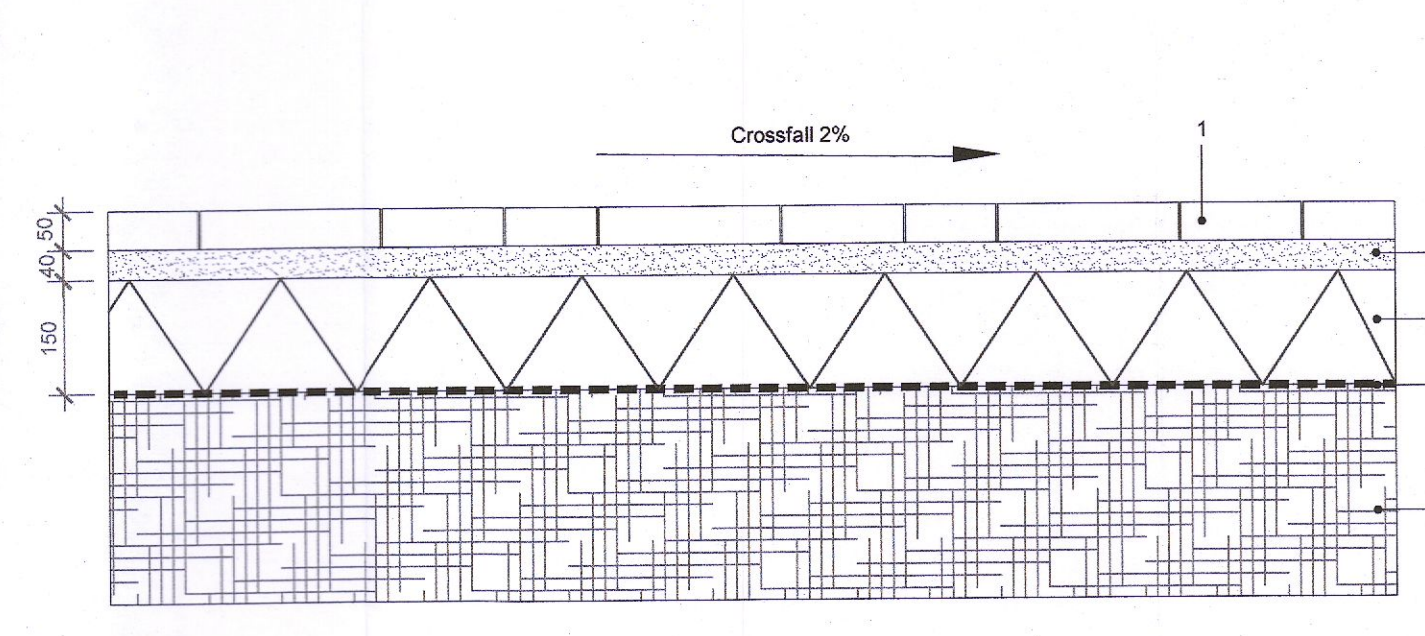

- NOTES:
1. Unit block paving with 2.5mm joints filled with dried kiln jointing sand Kilsaran 'Newgrange' Block Paving or similar and approved. 50x120x160, 50x160x160, 50x240x160mm (3 size mixed). Colour - Silver Granite / Black Granite; Paving surfacing to be laid in accordance with BS 7533-4:2006
 2. Compacted naturally occurring sharp sand or 2-6mm crushed stone grit laying course
 3. Well compacted Clause 804 stone to falls/crossfalls required
 4. Geotextile layer (Terram or similar & approved)
 5. Well compacted sub grade to appropriate level & profile to engineers approval

In-situ Concrete Path Standard
Scale 1:10

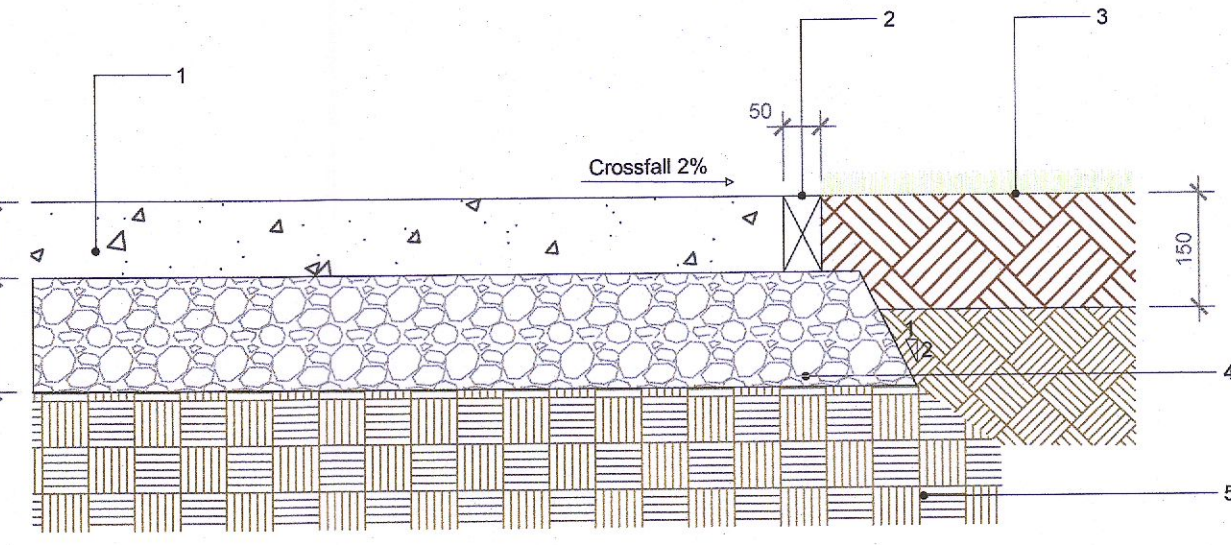

- NOTES:
1. 100mm Concrete to Clause 1106 Sandblasted Finish; Joints to have a maximum spacing of 3m, joint sealant to be Colpor 200 (expansile limited) and/or similar approved
 2. Timber shuttering to be removed on completion
 3. Topsoil reinstated to edge of path
 4. 150mm min. Well compacted Sub-Base Clause 804 stone to appropriate level & profile Engineers' approval
 5. Well consolidated or undisturbed ground; Acceptable material to appendix 6/1 National Roads Authority - Construction details

1. This drawing is intended to show landscape architectural proposals only. Please refer to Architects and Engineers drawings for relevant details of buildings, structures, roads, parking, etc.
2. The copyright of this drawing is vested with Murray & Associates. This drawing may not be copied or reproduced without written consent.
3. All materials referred to on this drawing, including plant species, are indicative and subject to change following detailed site investigation. Significant changes, if any are required, will be referred to the relevant authority for agreement.
4. This drawing is not suitable for use for construction purposes.
5. Discrepancies to be referred to Murray & Associates for clarification.

murray & associates
landscape architecture

19 The Seapoint Building, 44-46 Cornhill Road, Dublin 3, D03 RFB3
murray@murray-associates.com
www.murray-associates.com
+353 (0)1 854 0000

B	06/09/22	RFI	IV	IMB
A	23/08/22	RFI	IV	IMB
O	01/04/22	Planning Issue	HT	IMB
REV	DATE	REVISION	DRAWN	CHECKED

CLIENT
Blackwin Limited

PROJECT TITLE
Warehousing / Logistics and Office Development at Calmount Road

SHEET TITLE		SHEET SIZE	
Landscape Details Sheet 2 of 3 Hard Landscape Details		A1	
SHEET NO.		REVISION	
As Shown		B	
DATE		DATE	
PLANNING		06/09/22	