

A1

DO NOT SCALE

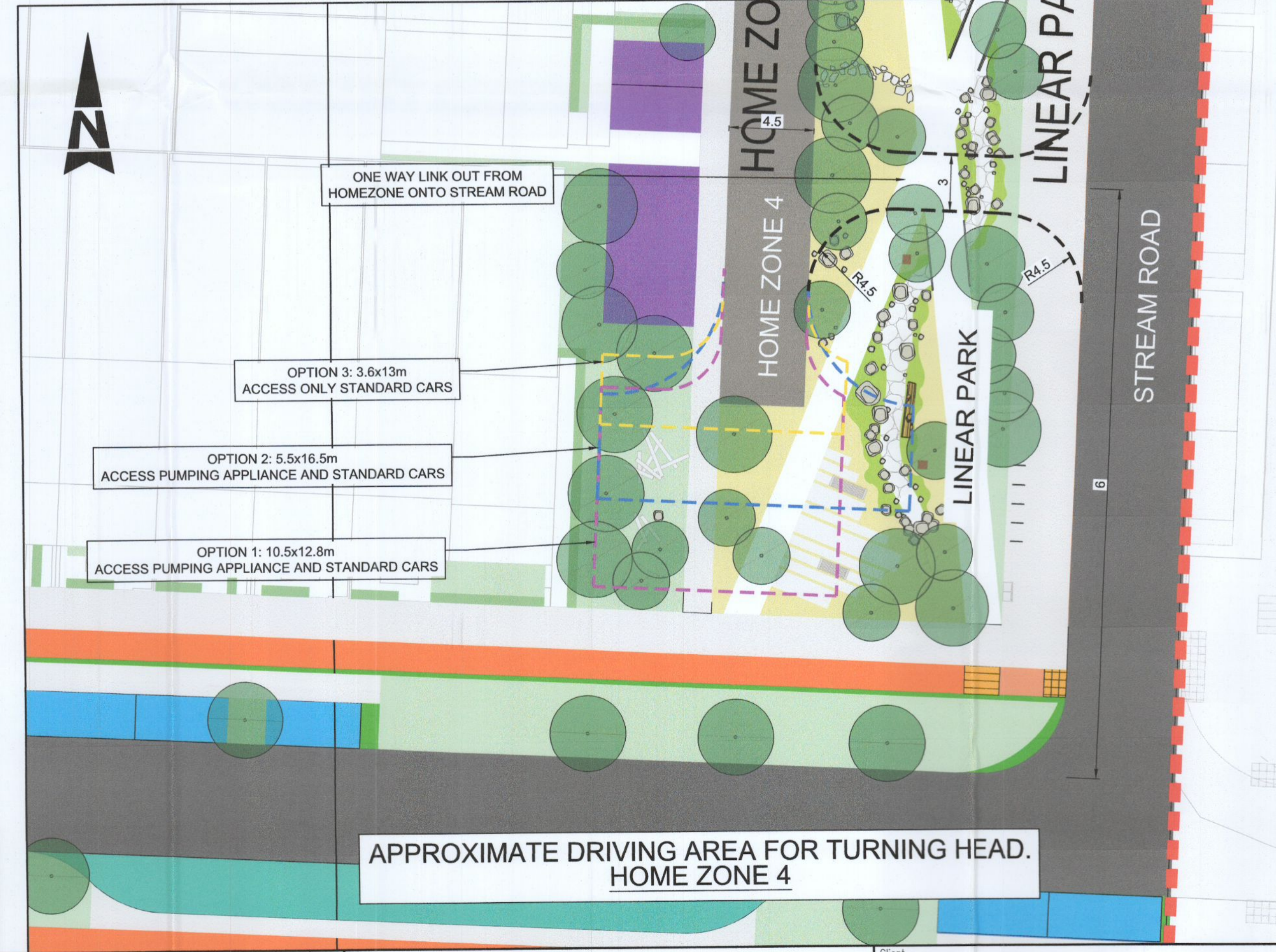

- GENERAL NOTES
1. ALL DIMENSIONS ARE IN MILLIMETRES UNLESS NOTED OTHERWISE
 2. ONLY WRITTEN DIMENSIONS SHALL BE USED. NO DIMENSIONS SHALL BE SCALED FROM THE DRAWINGS
 3. ALL LEVELS ARE IN METRES AND ARE TO MALIN HEAD DATUM
 4. ALL COORDINATES ARE IN METRES AND ARE TO IRISH TRANSVERSE MERCATOR

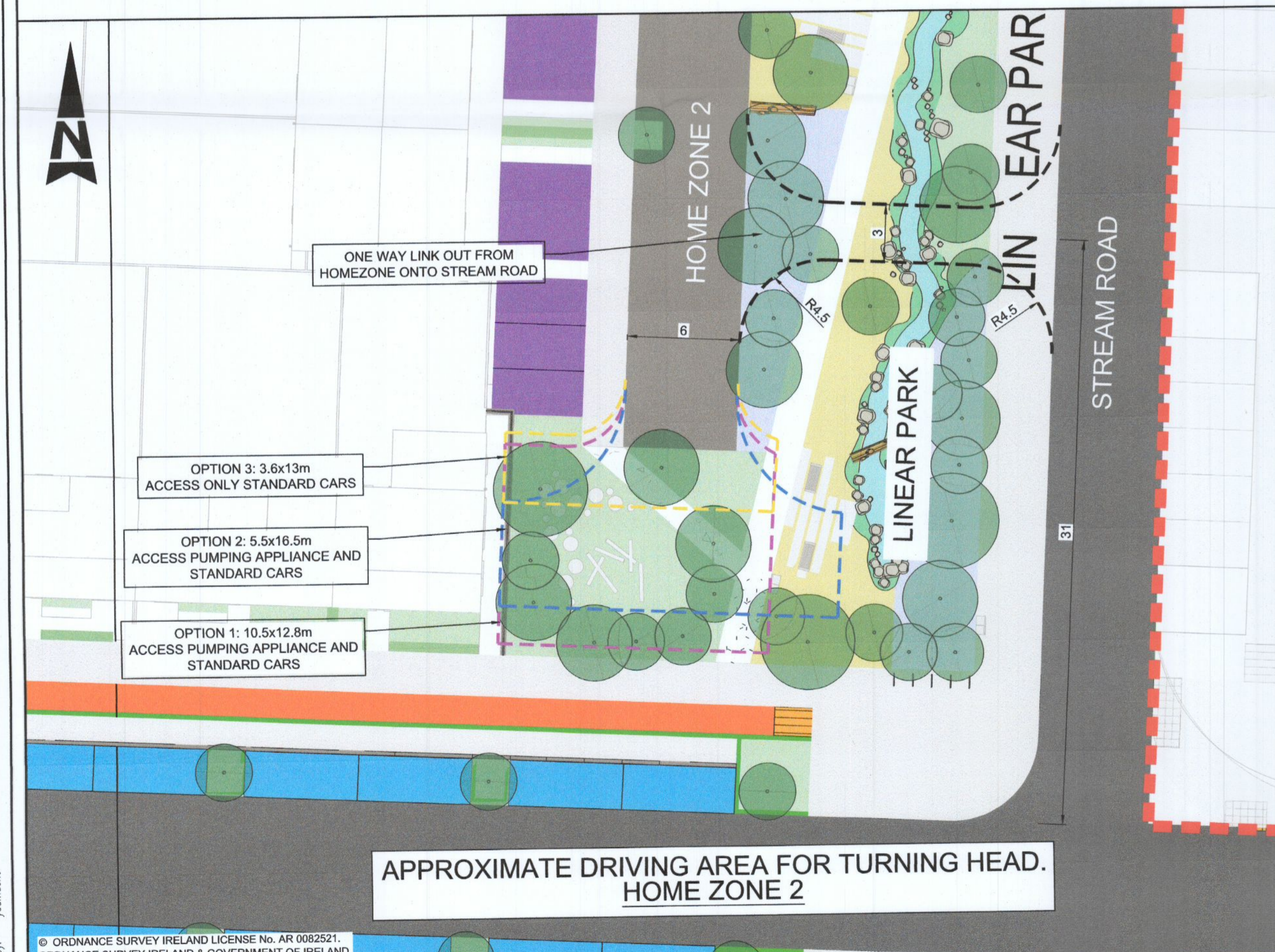
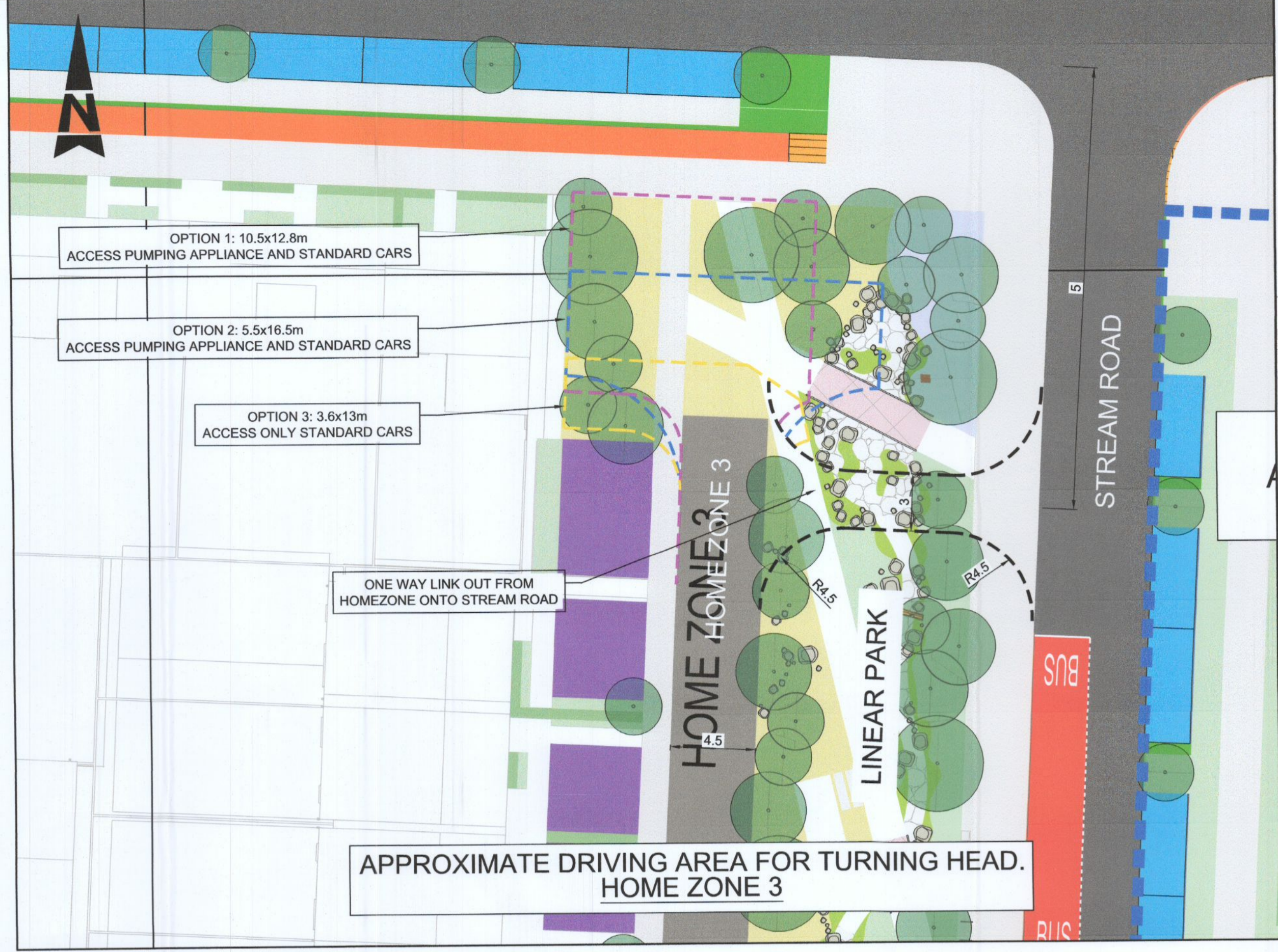
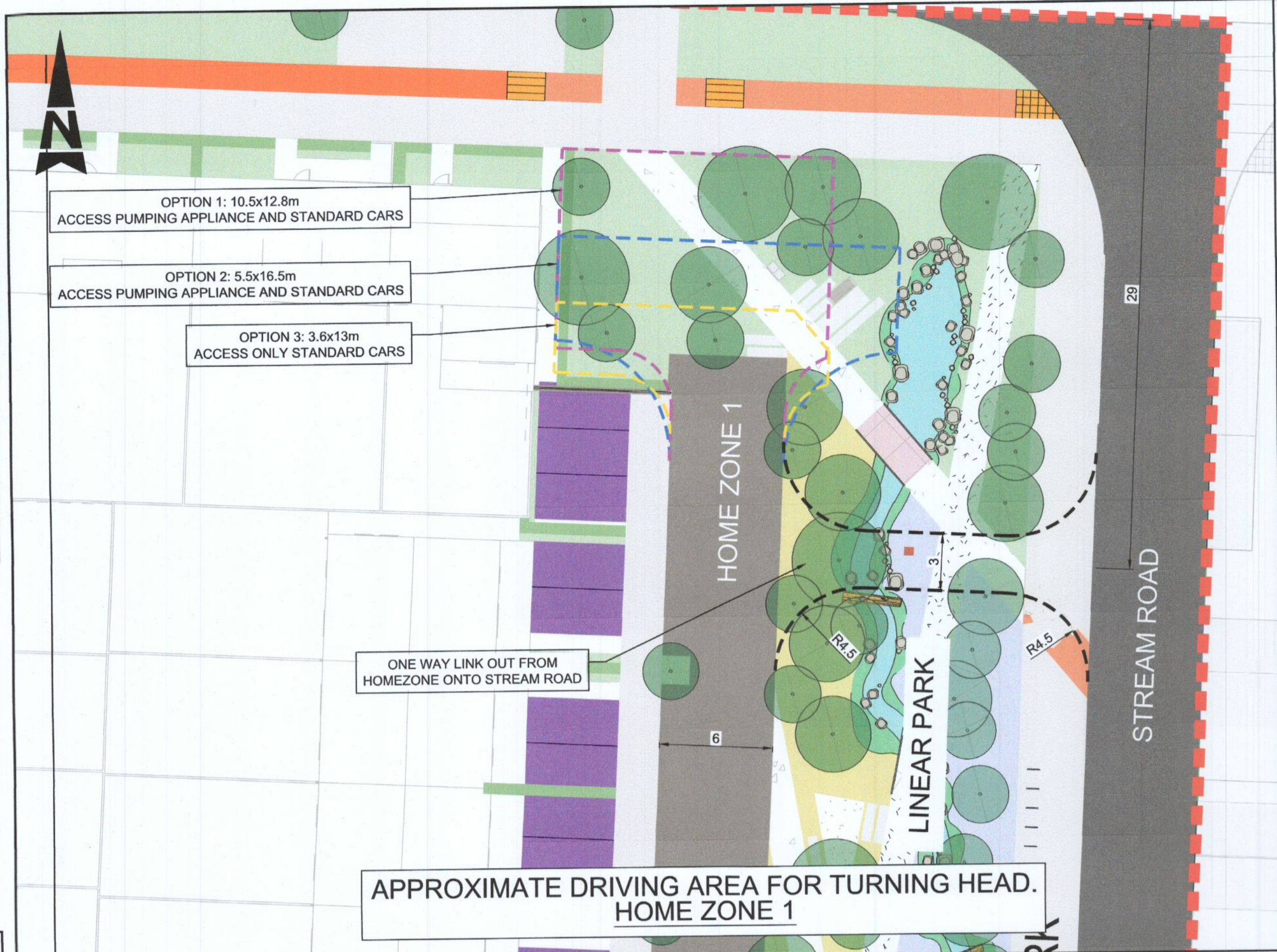

DRAFT

- LEGEND:
- PROPOSED CARRIAGEWAY (AVENUE)
 - PROPOSED CARRIAGEWAY (LOCAL STREET)
 - PROPOSED CYCLE LANE
 - PROPOSED FOOTPATH
 - PROPOSED TRAFFIC PATH
 - PROPOSED PARKING DEVELOPMENT
 - PROPOSED PUBLIC PARKING
 - BUFFER AREA
 - PROPOSED SHARE SPACE
 - RAISED TABLE
 - PROPOSED BUS STOP
 - PROPOSED BUS SETDOWN AREA
 - TACTILE PAVING - BUFF
 - TACTILE PAVING - RED
 - PROPOSED VERGE
 - LANDSCAPE ARCHITECT DETAILS
 - LANDSCAPE ARCHITECT DETAILS
 - LOADING BAY
 - PROPOSED BUS STOP AREA
 - APPLICATION BOUNDARY

Purpose PLANNING

Title		TURNING HEAD OPTIONS	
Original Scale	Design/Drawn	Checked	Authorised
1:200 at A1	YC	PF	KB
	Date 12.07.22	Date 12.07.22	Date 12.07.22
Status	Drawing Number	Rev	
P	5150924 / HTR / SK / 0001	-	

© ORDNANCE SURVEY IRELAND LICENSE No. AR 0082521
 ORDNANCE SURVEY IRELAND & GOVERNMENT OF IRELAND

File: 5150924_HTR_10_SK_0001.dwg
 Date: Jul 13, 2022 - 2:06pm
 Plotted by: yamacho

Rev	Description	By	Date	Chk'd	Auth
-	FOR PLANNING	YC	12.07.22	PF	KB

ATKINS
 Member of the SNC-Lavalin Group

Atkins House, 150-155 Aislaide Business Park, Swords, Co. Dublin
 Tel (+353) 01 810 8000 Fax (+353) 01 810 8001

Unit 2B, 2200 Cork Airport Business Park, Cork
 Tel (+353) 021 429 0300 Fax (+353) 021 429 0360

1st Floor Technology House Parkmore Technology Park, Galway
 Tel (+353) 091 786 050 Fax (+353) 091 779 630

Client
 ADAMSTOWN STATION & BOULEVARD LTD

Project
 ADAMSTOWN BOULEVARD PHASE 1 - DEVELOPMENT