

1. All boundaries, dimensions and levels are to be checked on site before construction and any discrepancies are to be reported to the Architect.
 2. Partial Services: Any discrepancies with site or other information is to be advised to the Architect and direction or approval is to be sought before the implementation of the detail.
 3. Block and site plans are reproduced under license from the Ordnance Survey.
 4. Do not scale this drawing.
 5. For the purpose of coordination, all relevant parties must check this information prior to implementation and report any discrepancies to the Architect.

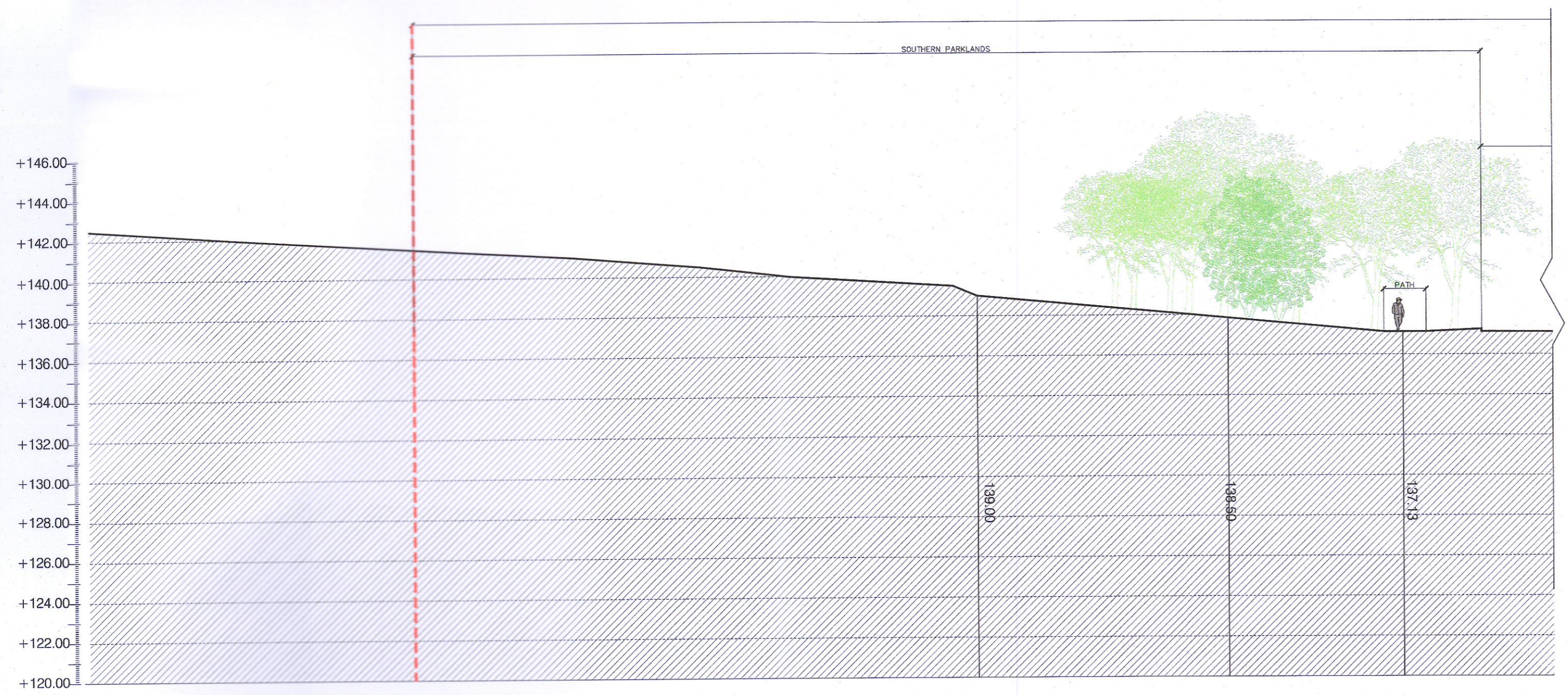

PROPOSED CONTEXTUAL 3 - EAST (PART 1 OF 2)
 SCALE 1:200



PROPOSED CONTEXTUAL 4 - NORTH (PART 1 OF 2)
 SCALE 1:200



PROPOSED CONTEXTUAL 4 - NORTH (PART 2 OF 2)
 SCALE 1:200

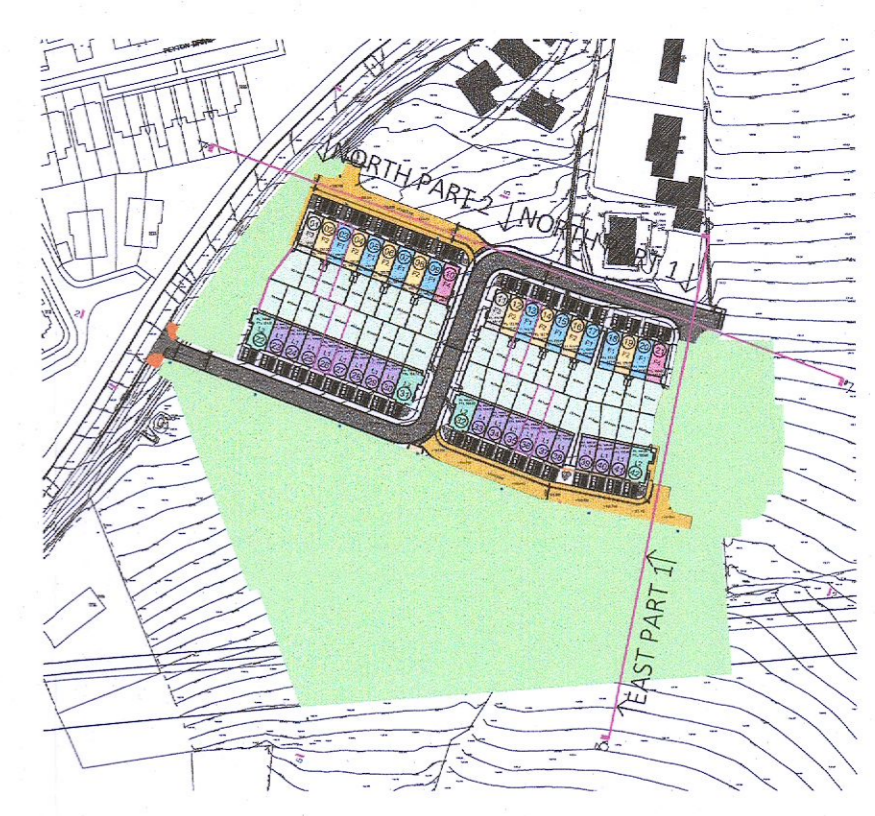

LEGEND

- SITE BOUNDARY: 2.9 HA (7.19 AC)
- OTHER LANDS IN POSSESSION OF APPLICANT

AREA SCHEDULE

AREA	AREA (SQ. M)	AREA (ACRES)
SITE AREA (DEVELOPABLE AREA)	12,700	3.150
ROADWAY AREA	11,600	2.900
NON DEVELOPABLE AREA (STONEY HILL ROAD)	3,300	0.77
TOTAL RESERVE SITE AREA	24,300	6.05

Planning

Adrian Hill Architects
 No. 15 The Seapoint Building,
 44/45 Clontarf Road, Dublin 3.
 t: +353 1 479 3141
 w: adrianhill.ie

Client
 Romeville Developments Ltd

Project
 Stoney Hill Road, Rathcoole, Co. Dublin

Drawing
 PROPOSED SITE CONTEXTUALS EAST PART 1
 PROPOSED SITE CONTEXTUALS NORTH

Job No	Reg No	Rev No	Status
2227	(P)311	-	Planning

Scale	Date	Drawn by	Checked by
1:200@A1	Aug-22	EOS	JFK

Revisions	REV No	DATE	NOTE

