



- NOTES:
- DO NOT SCALE. USE FIGURED DIMENSIONS ONLY.
 - THIS DRAWING IS TO BE READ IN CONJUNCTION WITH ALL OTHER RELEVANT ARCHITECTURAL AND ENGINEERING DRAWINGS.

LEGEND

- EXTENT OF WORKS
- PROPOSED ROAD CHAINAGE & LEVELS
- EXISTING ROAD CHAINAGE (CURRENTLY UNDER CONSTRUCTION)
- ▲ XX.XX HP PROPOSED HIGH POINT ROAD LEVEL
- ▼ XX.XX LP PROPOSED LOW POINT ROAD LEVEL
- 1:150 PROPOSED ROAD GRADIENT
- FFL + XX.XXX FINISHED FLOOR LEVEL (SET BY ARCHITECT)
- UNCONTROLLED CROSSING TACTILE PAVING
- CORDUROY TACTILE PAVING ARRANGEMENT
- PROPOSE RAMP
- ROAD SECTION (SEE DRG. 21-058 P1125)

*NOTE - FINISHED FLOOR LEVELS PROVIDED BY ARCHITECT, SEE DRG. TL2-MOLA-XX-ZZ-DR-AR-0102 FOR REFERENCE

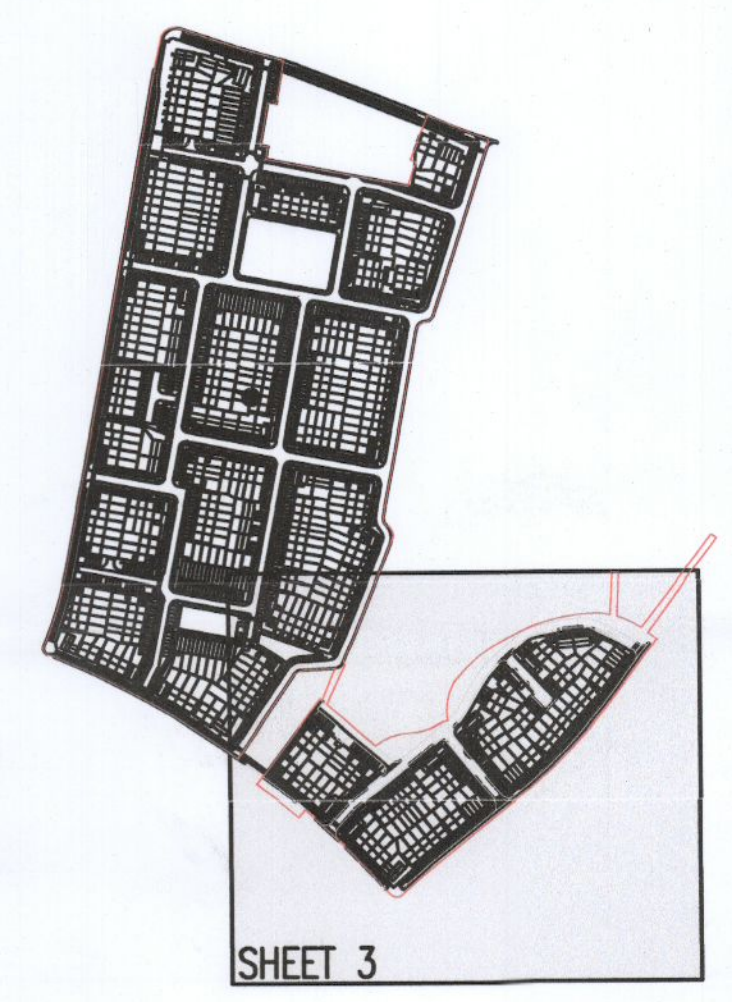

KEYPLAN
SCALE 1:5000

Ordnance Survey Ireland Licence
No. EN 0006022 © Ordnance Survey Ireland/Government of Ireland.

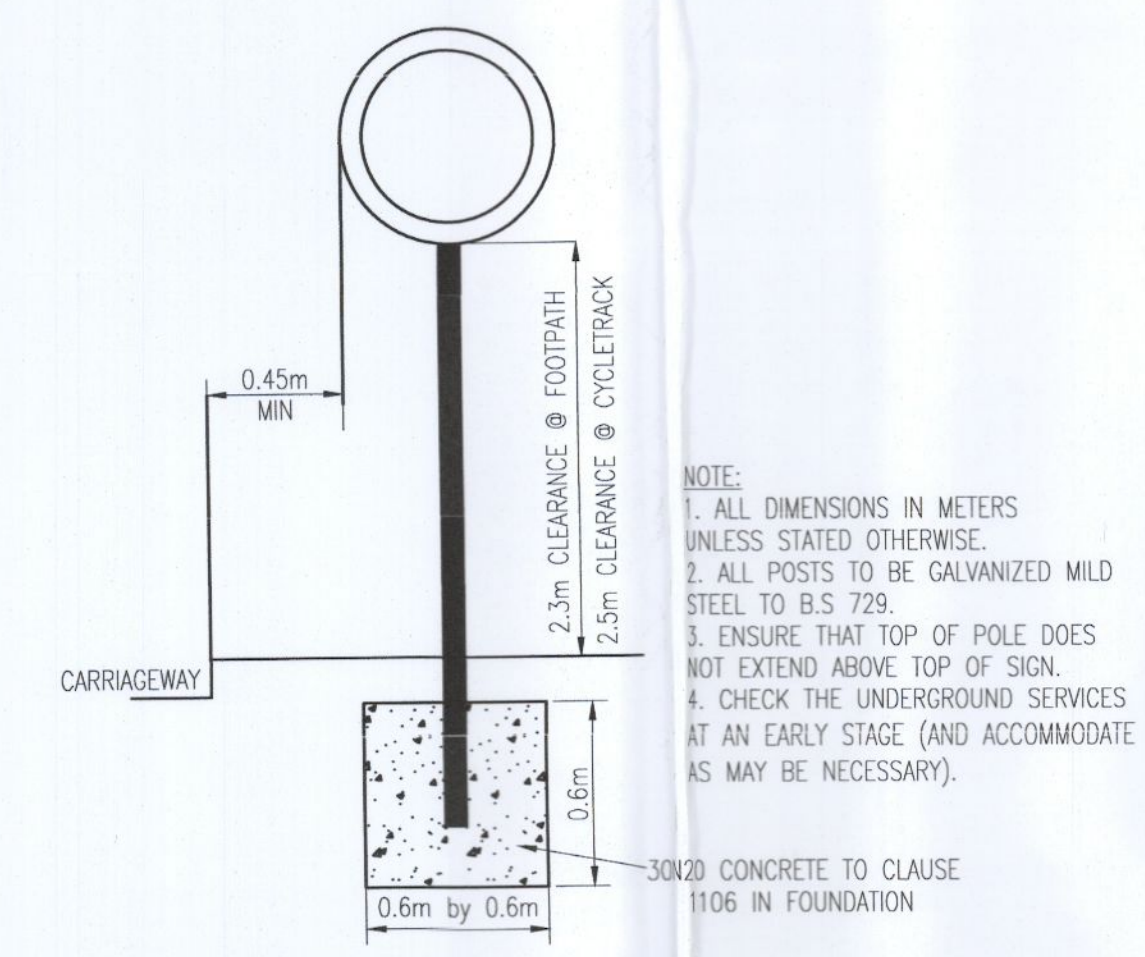
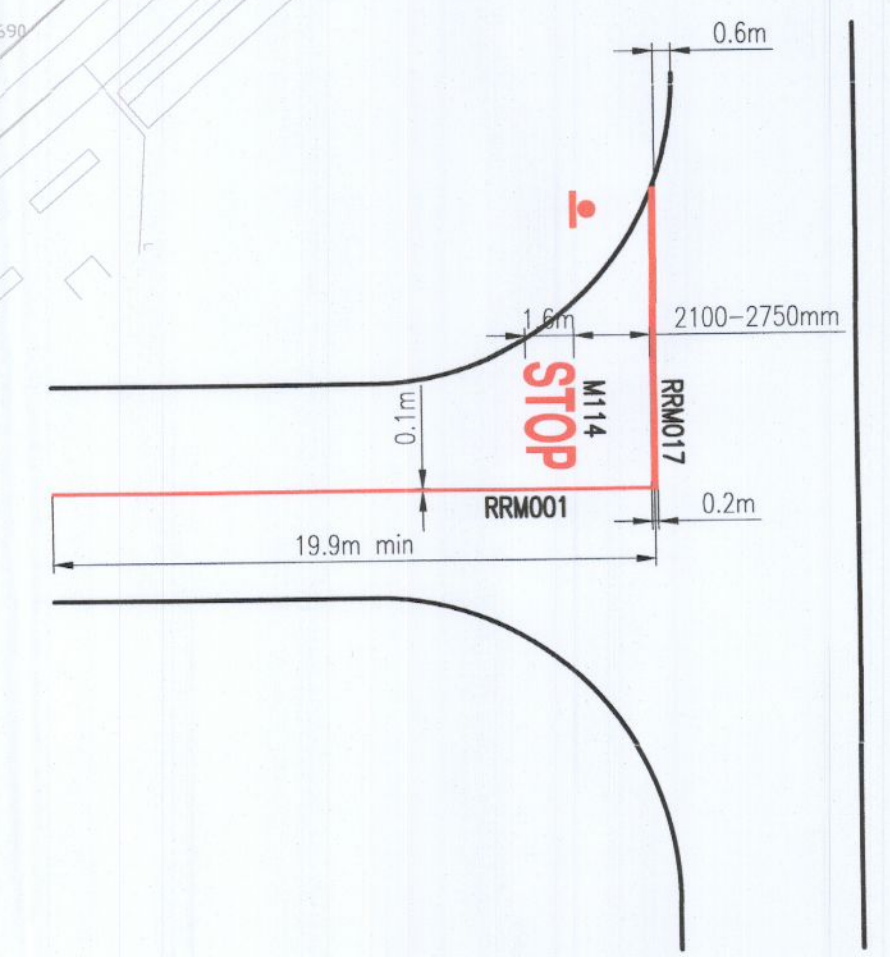
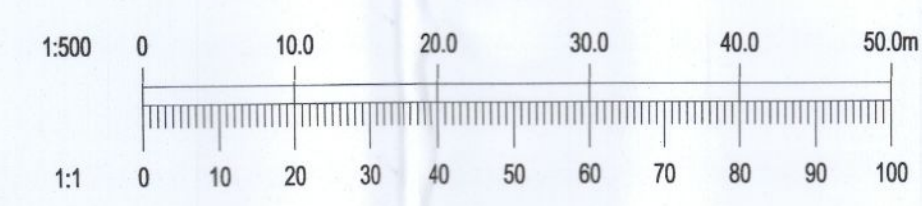

- NOTE:
- ALL DIMENSIONS IN METERS UNLESS STATED OTHERWISE.
 - ALL POSTS TO BE GALVANIZED MILD STEEL TO B.S 729.
 - ENSURE THAT TOP OF POLE DOES NOT EXTEND ABOVE TOP OF SIGN.
 - CHECK THE UNDERGROUND SERVICES AT AN EARLY STAGE (AND ACCOMMODATE AS MAY BE NECESSARY).

TYPICAL SIGN MOUNTING ARRANGEMENT IN FOOTPATH
NTS

Fig 7.35 PRIORITY CONTROLLED STOP JUNCTION

STATUS **FOR PLANNING ONLY NOT FOR CONSTRUCTION**

Waterman Moylan
Engineering Consultants
BLOCK 5, EASTPOINT BUSINESS PARK, ALFIE BYRNE ROAD, DUBLIN D03 H3F4 IRELAND. Tel: (01) 664 8900
Email: info@waterman-moylan.ie www.waterman-moylan.ie

CLIENT	QUINTAIN DEVELOPMENTS IRELAND Ltd.		
ARCHITECT	MOLA ARCHITECTS		
PROJECT	TANDY'S LANE VILLAGE - PHASE 2		
TITLE	GENERAL ARRANGEMENT AND ROAD LEVELS SHEET 3 OF 3		

DRAWN PW	DESIGNED KO	APPROVED EC	DATE AUG. 2022
SCALE 1:500 0A1	JOB NO. 21-058	DRG. NO. P1102	REVISION -