

- NOTES:
- DO NOT SCALE. USE FIGURED DIMENSIONS ONLY.
  - THIS DRAWING IS TO BE READ IN CONJUNCTION WITH ALL OTHER RELEVANT ARCHITECTURAL AND ENGINEERING DRAWINGS.

**LEGEND**

- 2.4m x 45m SIGHTLINE
- 2.4m x 49m SIGHTLINE
- 2.4m x 23m SIGHTLINE

DESIGN SPEED (km/h)	SSD STANDARD (m)
10	7
20	14
30	23
40	33
50	45-49 BUS
60	59

**FORWARD VISIBILITY**  
DESIGN MANUAL FOR URBAN ROADS  
AND STREETS - TABLE 4.2

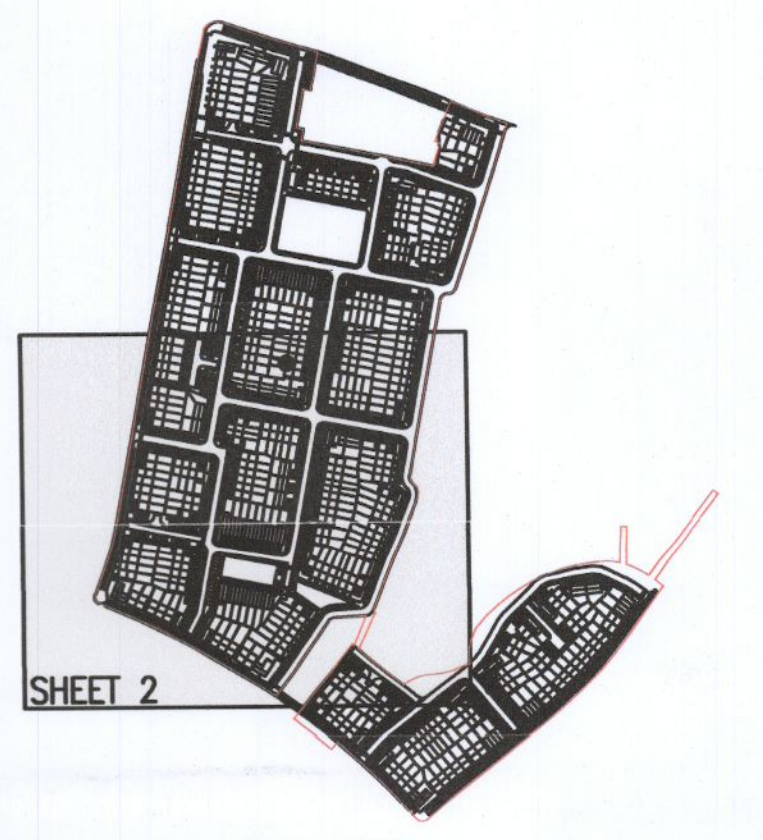

**KEYPLAN**  
SCALE 1:5000

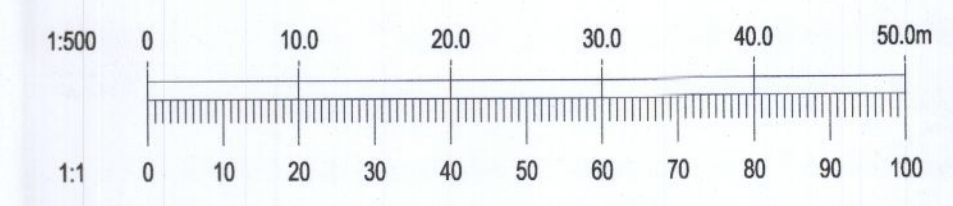

**Ordnance Survey Ireland** Licence No. EN 0006022 © Ordnance Survey Ireland/Government of Ireland.

REV.	DATE	AMENDMENT	DRN	APPD
25/08/22		RFI RESPONSE	PW	IW

**STATUS FOR PLANNING ONLY NOT FOR CONSTRUCTION**

**Waterman Moylan**  
Engineering Consultants  
BLOCK 5, EASTPOINT BUSINESS PARK, ALFIE BYRNE ROAD,  
DUBLIN D03 H3F4 IRELAND Tel: (01) 864 8600  
Email: info@waterman-moylan.ie www.waterman-moylan.ie

CLIENT: QUINTAIN DEVELOPMENTS IRELAND Ltd.  
ARCHITECT: MOLA ARCHITECTS

PROJECT: TANDY'S LANE VILLAGE - PHASE 2

TITLE: PROPOSED VISIBILITY SPLAYS  
SHEET 2 OF 3

DRAWN	DESIGNED	APPROVED	DATE
PW	KO	EC	AUG. 2022
SCALE	JOB NO.	DRG. NO.	REVISION
1:500 @A1	21-058	P1121	-

GE. ADAMSTOWN, LUCAN, Co. DUBLIN  
TOPOGRAPHICAL SURVEY FOR PHASE 2