

WASTEWATER

NOTE: THE CONTRACTOR IS RESPONSIBLE FOR ENSURING ALL WORKS ARE CARRIED OUT IN ACCORDANCE WITH THE FOLLOWING CODES OF PRACTICE AND STANDARD DETAILS;

- CODE OF PRACTICE FOR WASTEWATER INFRASTRUCTURE VERSION IW-CDS-5030-03 (REVISION 2) - JULY 2020
- WASTEWATER INFRASTRUCTURE STANDARD DETAILS VERSION IW-CDS-5030-01 (REVISION 4) - JULY 2020 AND QUALITY ASSURANCE REGIME;
- QUALITY ASSURANCE (QA) DESIGN REQUIREMENTS MANUAL IW-CDS-5010-01 (REVISION 3) - AUGUST 2020
- QUALITY ASSURANCE (QA) FIELD INSPECTION REQUIREMENTS MANUAL IW-CDS-5010-02 (REVISION 3) - AUGUST 2020

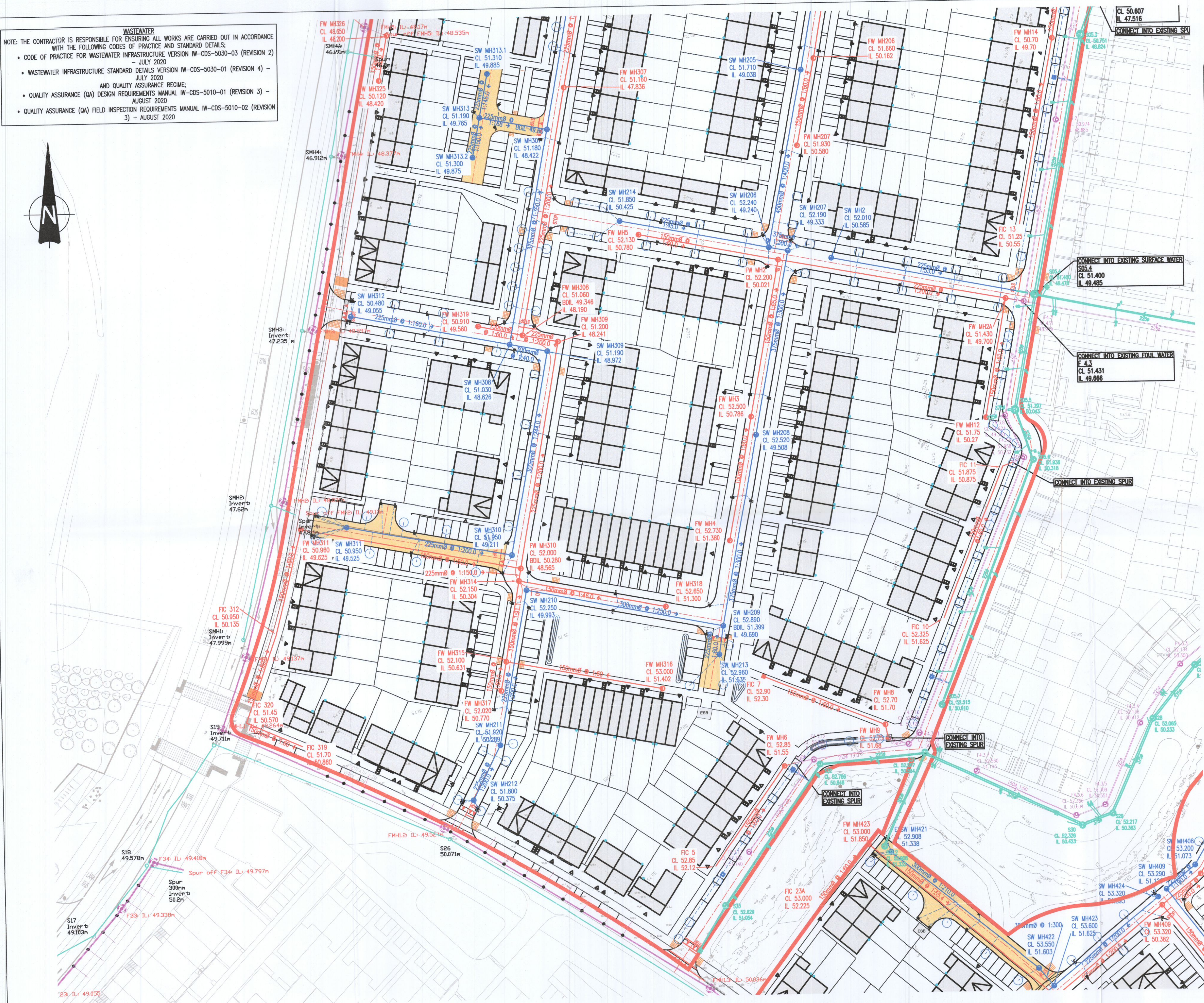
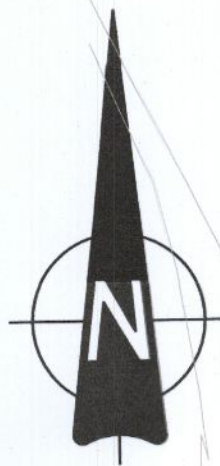

NOTES:

- DO NOT SCALE. USE FIGURED DIMENSIONS ONLY.
- THIS DRAWING IS TO BE READ IN CONJUNCTION WITH ALL OTHER RELEVANT ARCHITECTURAL AND ENGINEERING DRAWINGS.

LEGEND:

Symbol/Color	Description
Red line	EXTENT OF WORKS
Green line with 'S X X' label	EXISTING FOUL WATER SEWER WITH PIPE SIZE, GRADE, MANHOLE REF. AND INVERT LEVEL
Blue line with 'S X X' label	EXISTING SURFACE WATER SEWER WITH PIPE SIZE, GRADE, MANHOLE REF. AND INVERT LEVEL
Red line with 'FW MH X' label	PROPOSED FOUL WATER SEWER WITH PIPE SIZE, GRADE, MANHOLE REF. AND INVERT LEVEL AND WAYLEAVE
Blue line with 'SW MH X' label	PROPOSED SURFACE WATER SEWER WITH PIPE SIZE, GRADE, MANHOLE REF. AND INVERT LEVEL
Red square with 'FC X' label	PROPOSED FOUL WATER HOUSE DRAIN AND ACCESS CHAMBER
Blue square with 'FC X' label	PROPOSED SURFACE WATER HOUSE DRAIN AND ACCESS CHAMBER
Red dashed line	PROPOSED #100mm FOUL WATER PIPE
Blue dashed line	PROPOSED ROAD GULLY
Blue circle	PROPOSED BIORETENTION TREE PIT
Blue line	PROPOSED SWALES
Blue square	PROPOSED WATER BUTTS

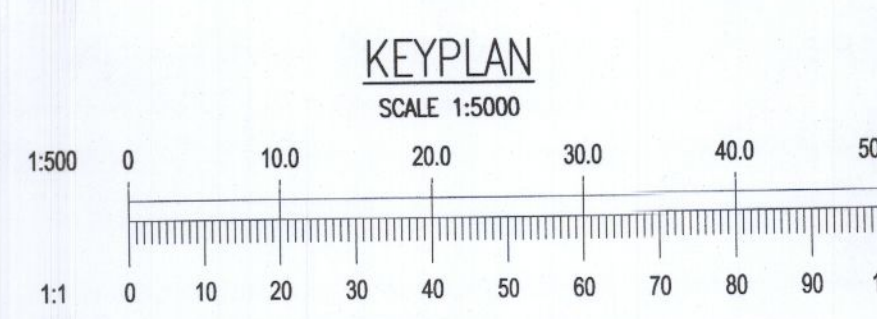
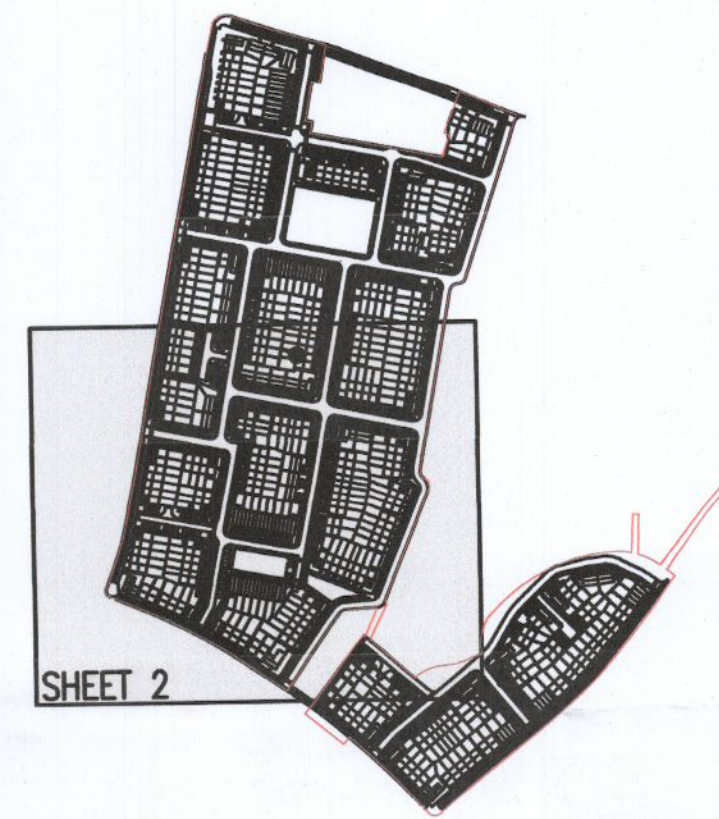

Ordnance Survey Ireland Licence No. EN 0006022 © Ordnance Survey Ireland/Government of Ireland.

REV.	DATE	AMENDMENT	DRN	APPD
25/08/22		RFI RESPONSE		PW IW

STATUS: **FOR PLANNING ONLY NOT FOR CONSTRUCTION**

Waterman Moylan
Engineering Consultants
BLOCK 8, EASTPOINT BUSINESS PARK, ALFIE BYRNE ROAD, DUBLIN D03 H3F4 IRELAND. Tel: (01) 664 8900
Email: info@waterman-moylan.ie www.waterman-moylan.ie

CLIENT: QUINTAN DEVELOPMENTS IRELAND Ltd.
ARCHITECT: MOLA ARCHITECTS
PROJECT: TANDY'S LANE VILLAGE - PHASE 2

TITLE: PROPOSED DRAINAGE LAYOUT SHEET 2 OF 3

DRAWN PW	DESIGNED KO	APPROVED EC	DATE AUG. 2022
SCALE 1:500 @A1	JOB NO. 21-058	DRG. NO. P1201	REVISION -