



**Note:**  
All drainage from wash down areas to discharge through silt traps and oil separators before discharging to sewerage network - refer to engineers drawings for further information

 New  
 Existing



Proposed ground Floor  
1:50

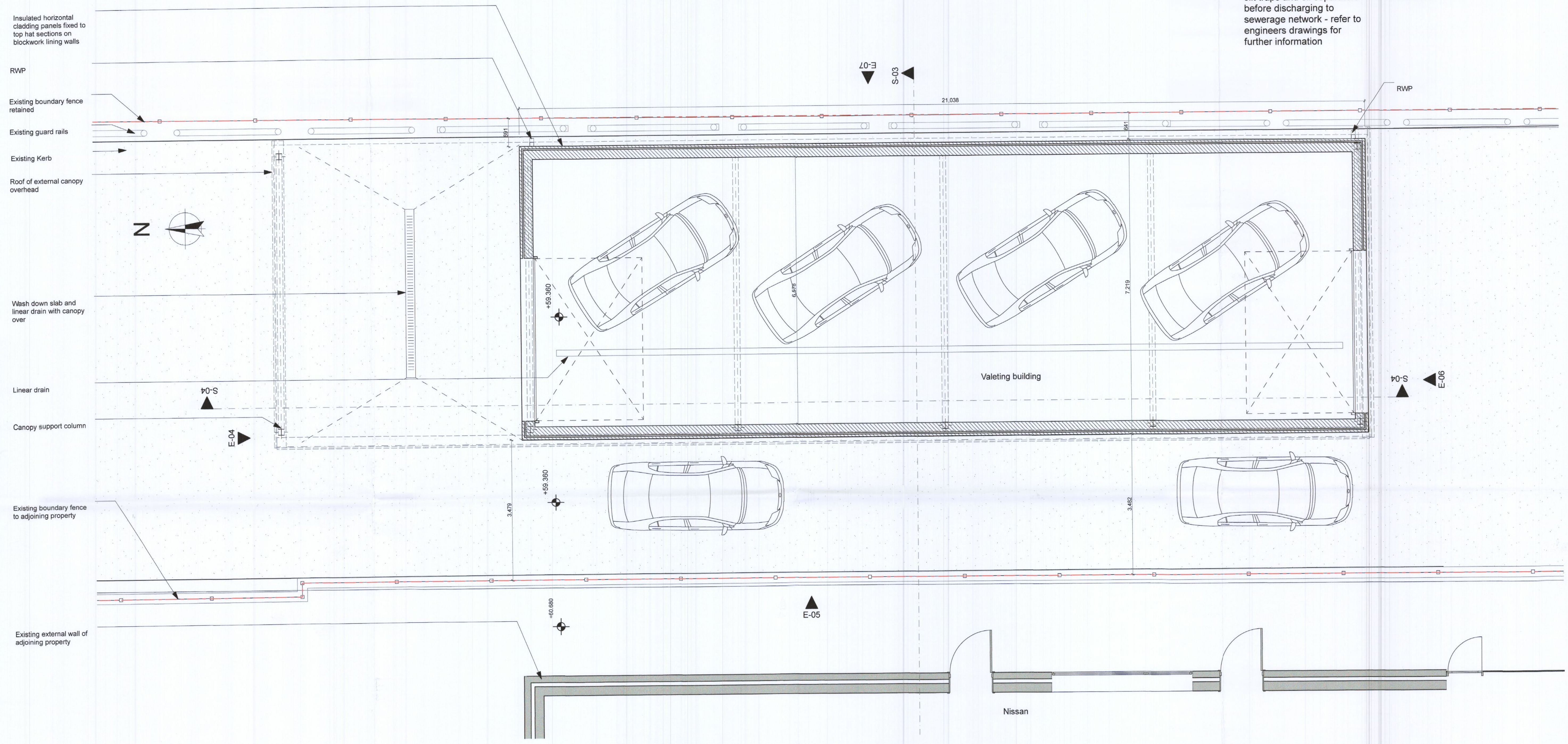
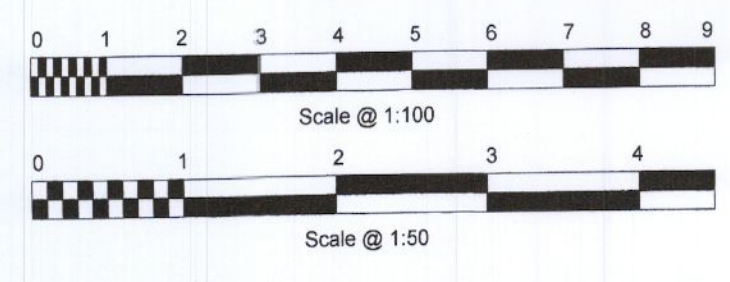

RevID	Description	Date

Purpose of Issue	status	Scales @ A1	Project No.
		1:50	2209

Originator	Project
HODGINS ARCHITECTS Annull, Rocky Road Wicklow Town, Co. Wicklow A67 F74G 088 8133456 hodginsarchitects@gmail.com	KIA LIFFEY VALLEY Showroom and Valeting Buildings Valley Motor Mall, Dublin 22

Client	Layout Title
GABRIEL KEANE MOTORS	Ground Floor Plan

Drawing Number	project	originator	number	rev
2209 -HA-			A.3	A