

NOTES:
 THIS DRAWING IN WHOLE OR IN PART SHALL NOT BE COPIED WITHOUT THE PRIOR PERMISSION OF McArdle DOYLE LTD.
 ALL WORKS TO COMPLY WITH THE CURRENT BUILDING REGULATIONS.
 DO NOT SCALE.
 ORDNANCE SURVEY IRELAND LICENCE No. AR 0105722
 © ORDNANCE SURVEY IRELAND / GOVERNMENT OF IRELAND

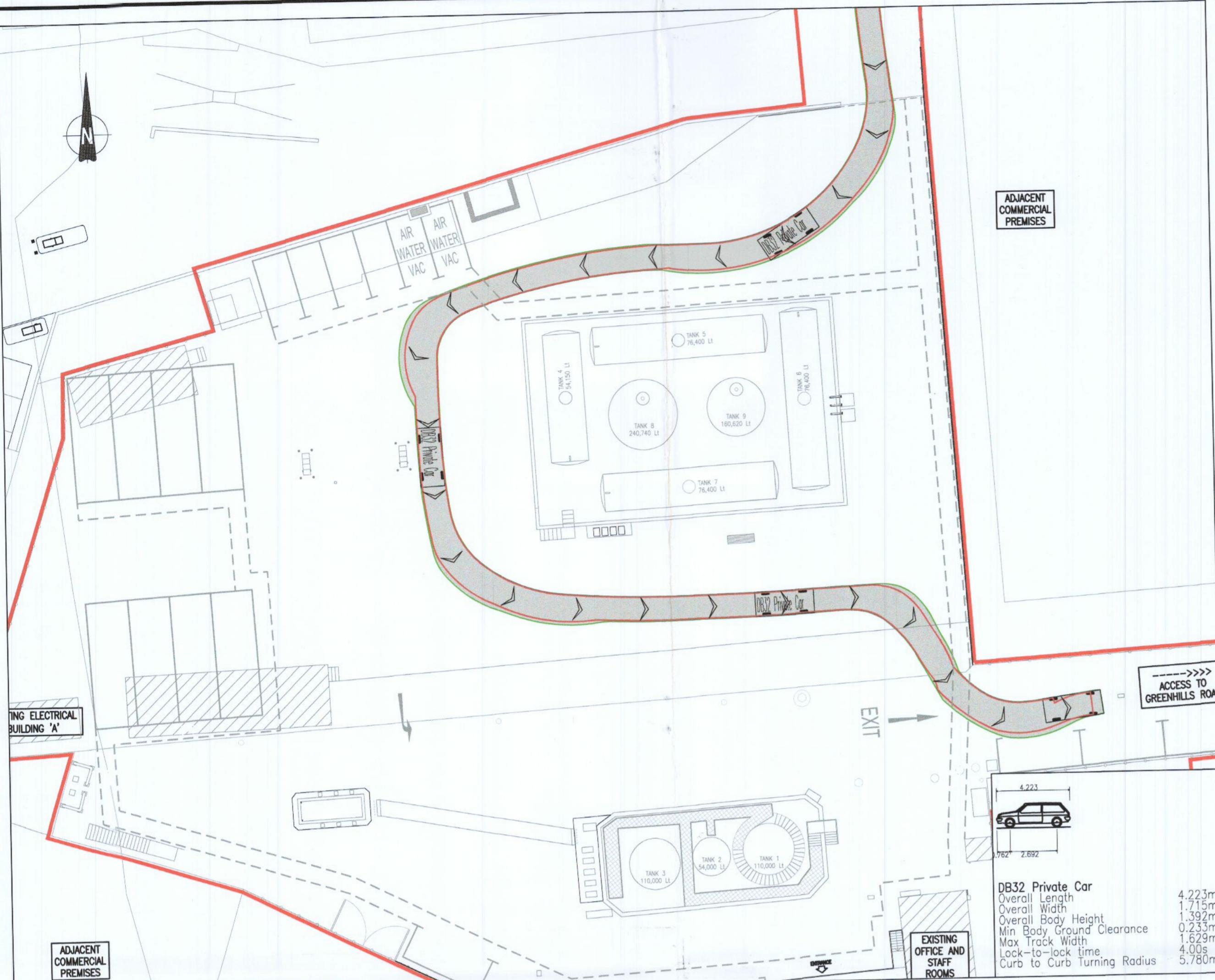

DB32 Private Car
 Overall Length 4.223m
 Overall Width 1.715m
 Overall Body Height 1.392m
 Min Body Ground Clearance 0.233m
 Max Track Width 1.629m
 Lock-to-lock time 4.00s
 Curb to Curb Turning Radius 5.780m

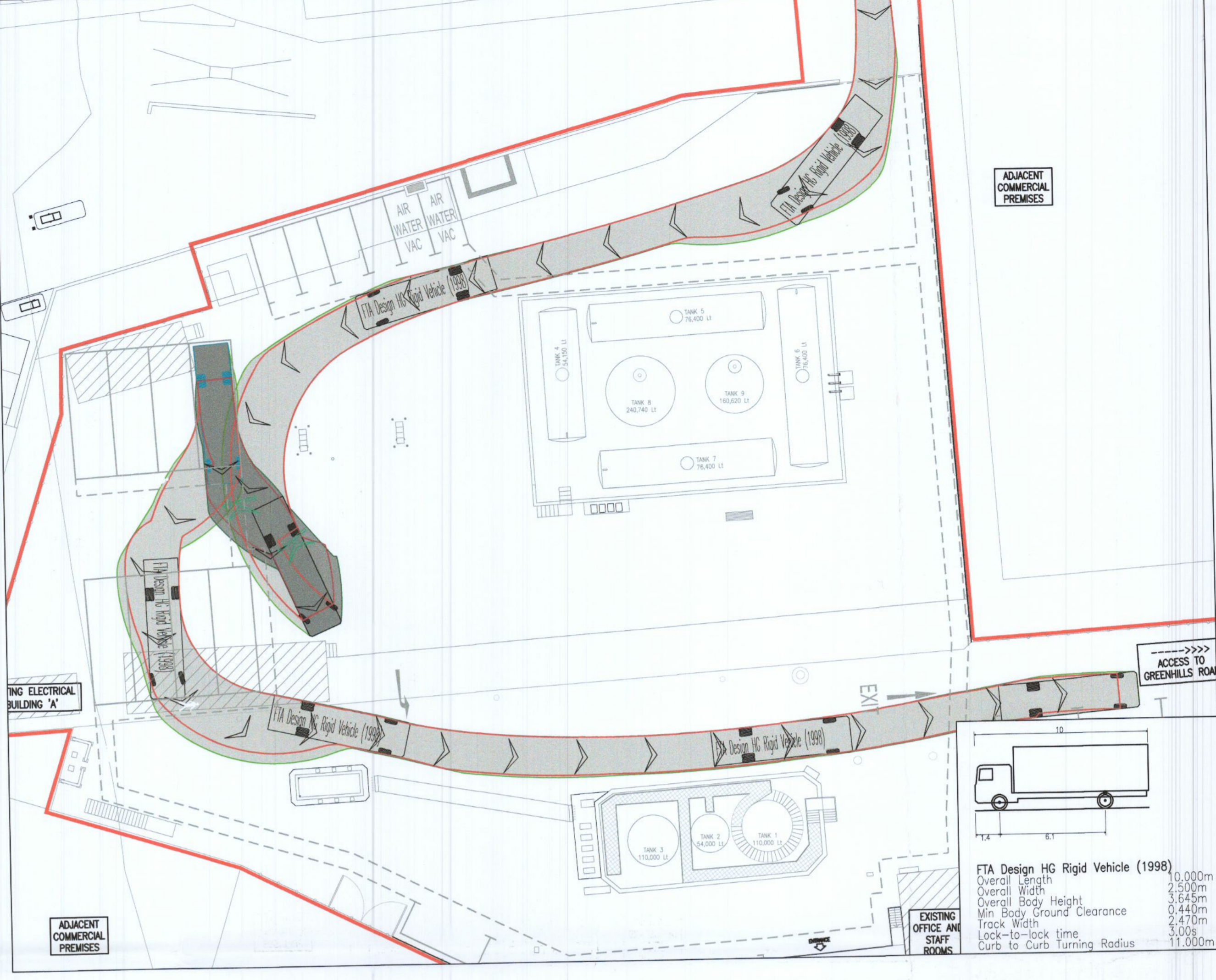

FTA Design HG Rigid Vehicle (1998)
 Overall Length 10.000m
 Overall Width 2.500m
 Overall Body Height 3.620m
 Min Body Ground Clearance 0.440m
 Track Width 2.470m
 Lock-to-lock time 3.00s
 Curb to Curb Turning Radius 11.000m

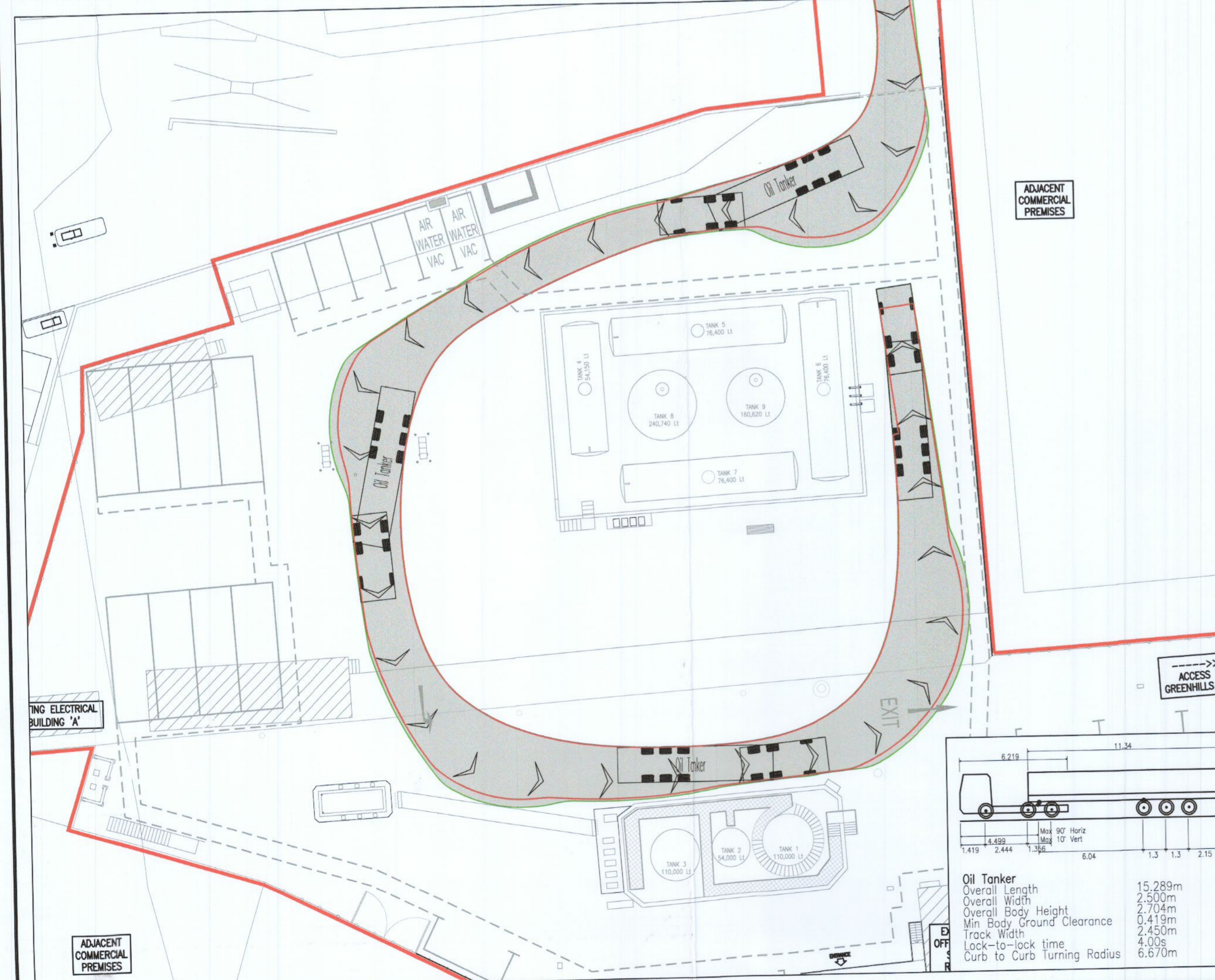

Oil Tanker
 Overall Length 15.289m
 Overall Width 2.500m
 Overall Body Height 2.704m
 Min Body Ground Clearance 0.419m
 Track Width 2.450m
 Lock-to-lock time 4.00s
 Curb to Curb Turning Radius 6.670m

ISSUED FOR PLANNING	GDR	12/07/22
Rev. Description	By	Date

McArdle Doyle
 Second Floor
 Exchange Building
 The Long Walk
 Dundalk, Co. Louth

Chartered Engineers
 Architectural Services
 & Project Managers

mail@mcardedoyle.ie
 +353(0) 42 942 9052

PROJECT: **FUEL DEPOT**
 24 GREENHILLS Rd,
 TALLAGHT, Co. DUBLIN

CLIENT: **JONES OIL**

DRAWING TITLE: **PROPOSED AUTOTRACKS**

Date	Drawn	Checked	Approved
12/07/22	GDR	GR	RMcA
Scale at A1	Drawing Number	Status	Rev.
1:250	P2224.C12	PL	-