

PARKING LEVEL 1
■ 215 SPACES - NON-RESIDENTIAL

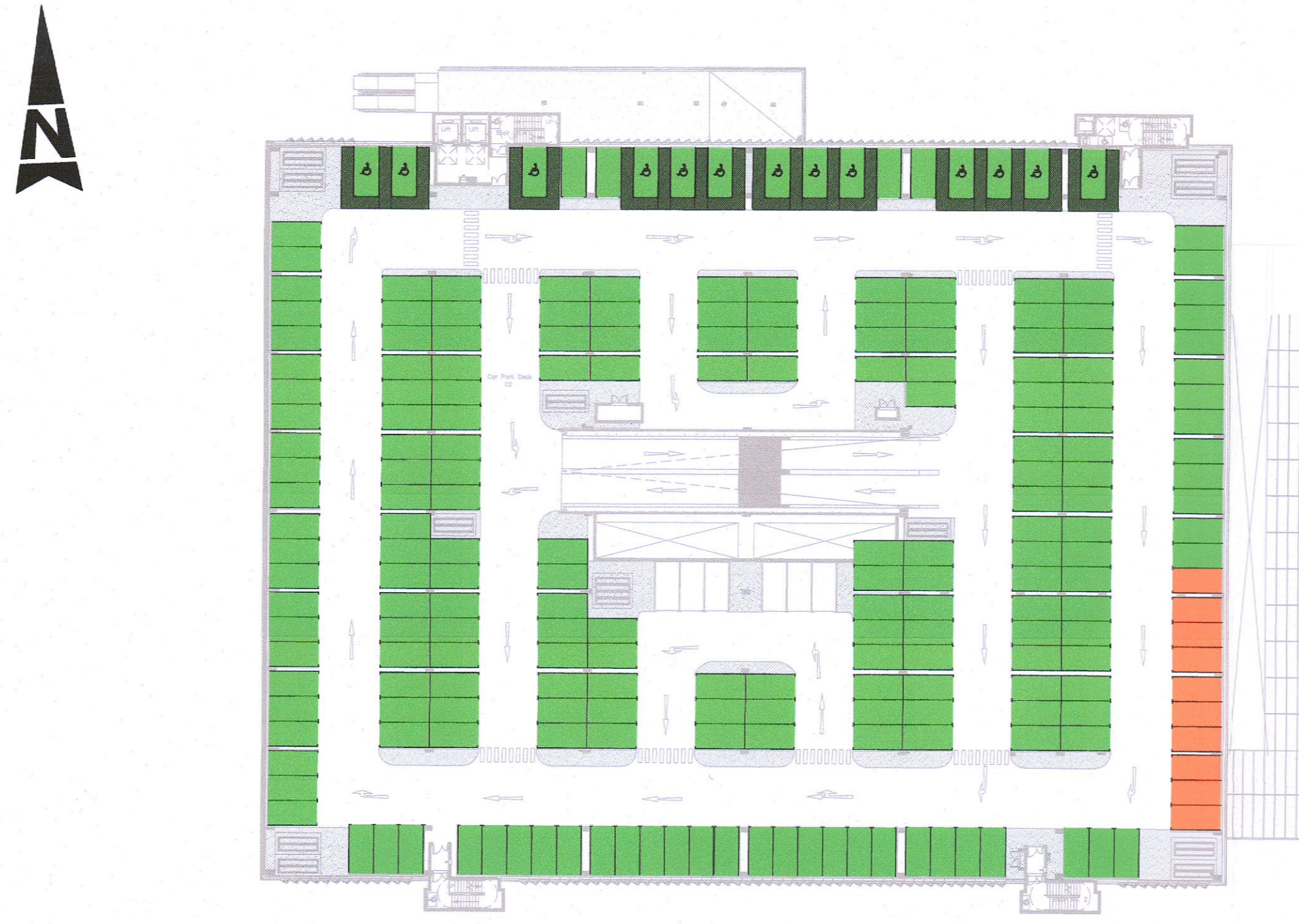

PARKING LEVEL 2
■ 214 SPACES - NON-RESIDENTIAL
■ 10 SPACES - HEALTH CENTRE



PARKING LEVEL 3
■ 72 SPACES - PARKING ASSIGNED TO BLOCK ACD
■ 66 SPACES - PARKING ASSIGNED TO BLOCK B&E
■ 76 SPACES - PARKING ASSIGNED TO BLOCK G SPACES
■ 12 SPACES - PARKING ASSIGNED TO BLOCK H 12 SPACES
■ 8 SPACES - NON-RESIDENTIAL PARKING SPACES

- GENERAL NOTES**
- ALL DIMENSIONS ARE IN MILLIMETRES UNLESS NOTED OTHERWISE
 - ONLY WRITTEN DIMENSIONS SHALL BE USED. NO DIMENSIONS SHALL BE SCALED FROM THE DRAWINGS
 - ALL LEVELS ARE IN METRES AND ARE TO MALIN HEAD DATUM
 - ALL COORDINATES ARE IN METRES AND ARE TO IRISH TRANSVERSE MERCATOR
 - DRAWINGS ARE TO BE READ IN CONJUNCTION WITH THE SPECIFICATION

- NOTES:**
- INFORMATION SHOWN IS CORRECT AS AT 16/11/2021.
 - BLOCK G AMENDMENT PLANNING APPLICATION UNDER CONSIDERATION BY SDCC.
 - BLOCK ACD AND QUADRANT H STILL IN DESIGN

Purpose: INFORMATION

Title: CAR PARK BLOCK F ALLOCATION PLAN

Client: QUINTAIN DEVELOPMENTS IRELAND LTD

Project: ADAMSTOWN STATION MASTERPLAN CAR PARKING REQUIREMENTS

Original Scale	Drawn	Checked	Reviewed	Authorised
1:500 at A1 1:1000 at A3	YC	PF	PF	KB
Date: 16.11.21	Date: 16.11.21	Date: 16.11.21	Date: 16.11.21	Date: 16.11.21
Status	Drawing Number			Rev
I	5150924 / HTR / 08 / SK / 039			E

Rev	Description	By	Date	Chk'd	Rev'd	Auth
E	PLANNING	YC	28.07.22	NVDB		KB
D	PLANNING	YC	30.06.22	PF		KB
C	PLANNING	YC	01.06.22	PF		KB
B	PARKING SPACES UPDATED	YC	15.02.22	PF		KB
A	ISSUED FOR INFORMATION	YC	16.11.21	PF		KB
-	FOR INFORMATION	YC	16.11.21	PF		KB

ATKINS
 Member of the SNC-Lavalin Group

Atkins House, 150-155 Airside Business Park, Swords, Co. Dublin
 Tel (+353) 01 810 8000 Fax (+353) 01 810 8001

Unit 2B, 2200 Cork Airport Business Park, Cork
 Tel (+353) 021 429 0300 Fax (+353) 021 429 0360

1st Floor Technology House Parkmore Technology Park, Galway
 Tel (+353) 091 786 050 Fax (+353) 091 779 830

© ORDNANCE SURVEY IRELAND LICENSE NR. AR 0082521. ORDNANCE SURVEY IRELAND & GOVERNMENT OF IRELAND
 ATKINS WILL NOT BE HELD LIABLE FOR THE USE OF THIS DATA ON ANY PROJECT OTHER THAN THE PROJECT:

Risk Level
■ Atkins Base Line - Low Risk
■ Atkins Sensitive - Medium Risk
■ Atkins Private - High Risk
■ Client Critical - Already Marked