

EXISTING LAYOUT
SCALE 1:250

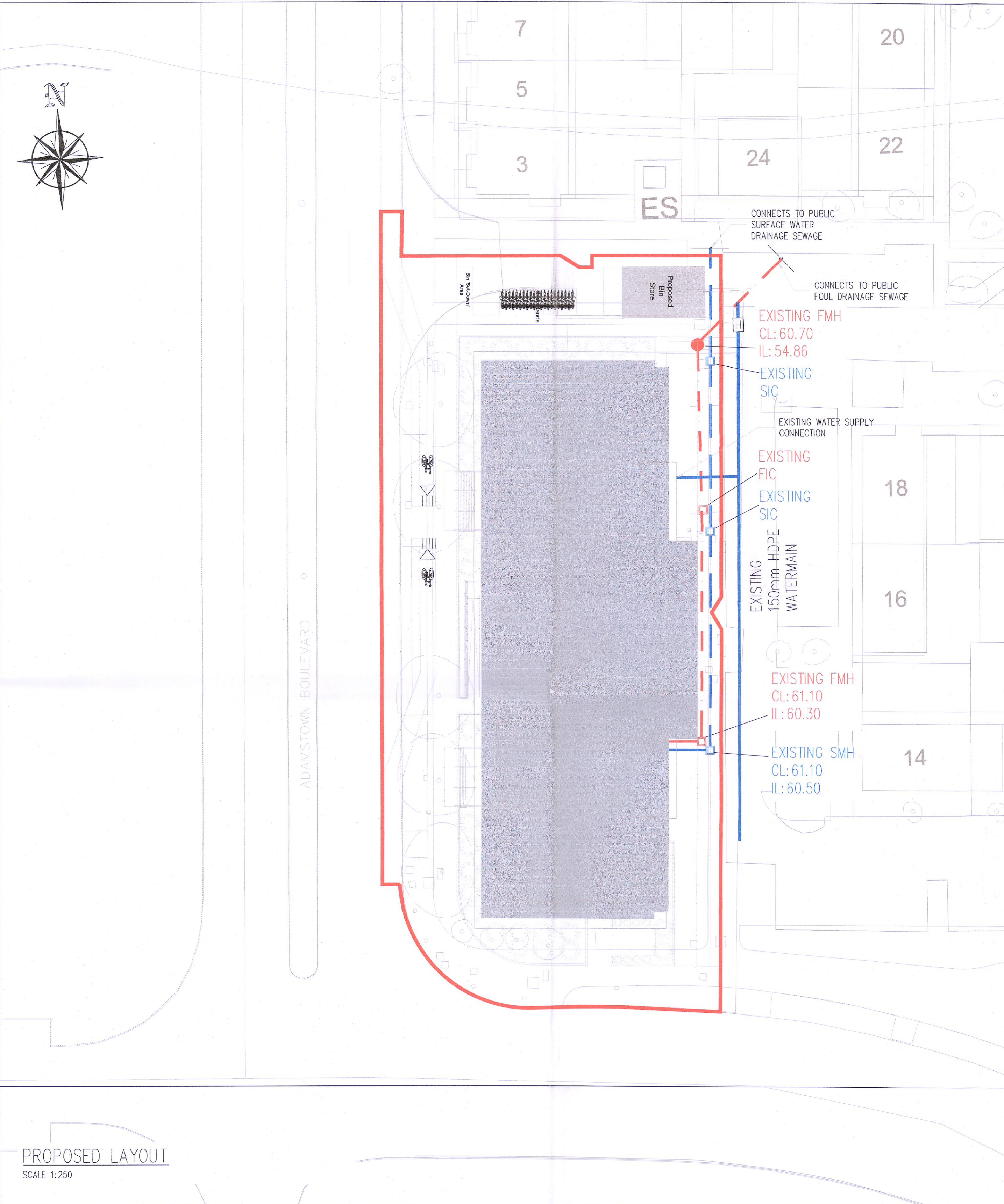

PROPOSED LAYOUT
SCALE 1:250

PLANNING DRAWING.
NOT FOR CONSTRUCTION.
ALL LEVELS GIVEN ARE
RELATIVE TO ORDNANCE DATUM.
THIS DRAWING HAS BEEN ISSUED FOR INFORMATION
PURPOSES ONLY AND MUST NOT BE USED
FOR CONSTRUCTION UNDER ANY CIRCUMSTANCES

- NOTES**
- For setting out refer to Architect's drawings.
 - This drawing to be read in conjunction with all other Architectural and Engineering drawings and all other relevant drawings and Specifications.
 - DO NOT SCALE THIS DRAWING. Use figured dimensions only.
 - No part of this document may be reproduced or transmitted in any form or stored in any retrieval system of any nature without the written permission as copyright holder except as agreed for use on the project for which the document was originally issued.
 - Ordnance Survey Ireland Licence Number EN 0074022

Rev. No.	Date	REVISION NOTE	Dim. By	Chkd. By
P1	22.07.2022	PLANNING ISSUE	PB	SS

Architect	Quinn Architects
Project	Adamstown Health Centre No.1 Adamstown Boulevard, Adamstown, Lucan
Title	Existing and Proposed Site Layout.
Dwg. No.	D020-CSC-ZZ-XX-DR-C-0001
Date	June 2022
Dim by	PB
Chkd by	SS
App'd by	MMc
Scale	1:250 @ A1
Revision	P1

CS Consulting Group
DUBLIN | LONDON | LIMERICK

Head Office
19-22 Dame Street, Dublin 2.
T: +353 (0)1 5480863
e: info@csconsulting.ie
w: www.csconsulting.ie

NSAI Certified

Quality
Environment I.S. EN ISO 9001:2008
Energy I.S. EN ISO 14001:2004
Health & Safety I.S. EN ISO 50001:2011
OHSAS 18001:2007