

**DATE:** 9 August 2022  
**DESIGNER:** Graham Sheehan  
**PROJECT No:** SES 17821 Rev E  
**PROJECT NAME:** St Edmund's Moykerr Limited



Designed in accordance with ISEN13201-2:2015 Class P4 for public roads. P5 for private courtyards.

Rev A: Latest site layout used.

Rev B: Latest site layout used.

Rev C: Some column positions revised and bollards added to private courtyards.

Rev D: Courtyard bollards relocated.

Rev E: Private courtyards lighting removed.

## Outdoor Lighting Report

**PREPARED BY:** Sabre Electrical Services Ltd.  
Unit 11 Bellevue Ind. Est.  
Finglas  
Dublin 11.  
Email: [graham@sabrelighting.ie](mailto:graham@sabrelighting.ie)  
Ph: 01 8110875

## Layout Report

### General Data

Dimensions in Metres Angles in Degrees  
 Grid Origin 595.0m x 578.0m  
 Area 201.0m x 225.0m  
 Sample Spacing 1.50m x 1.50m

### Luminaires



#### Luminaire A Data

Supplier	C U Phosco
Type	P852-12-F3-WW-CA0700-27W
Lamp(s)	730C WW
Lamp Flux (klm)	3.02
File Name	P852-12-F3-WW-CA0700-27W.ies
Maintenance Factor	0.83
Imax70,80,90(cd/klm)	693.4, 572.2, 102.0
No. in Project	6



#### Luminaire B Data

Supplier	C U Phosco
Type	P852-12-F2-WW-CA0700-27W
Lamp(s)	730C WW
Lamp Flux (klm)	3.08
File Name	P852-12-F2-WW-CA0700-27W.ies
Maintenance Factor	0.83
Imax70,80,90(cd/klm)	750.5, 280.0, 34.0
No. in Project	6



#### Luminaire C Data

Supplier	C U Phosco
Type	P852-12-R3B-WW-CA0200-9W
Lamp(s)	730C WW
Lamp Flux (klm)	1.04
File Name	P852-12-R3B-WW-CA0200-9W.ies
Maintenance Factor	0.83
Imax70,80,90(cd/klm)	876.7, 56.5, 1.7
No. in Project	14

### Layout

ID	Type	X	Y	Height	Angle	Tilt	Cant	Out-reach	Target X	Target Y	Target Z
1	B	608.26	691.46	6.00	272.00	0.00	0.00	0.40			
2	B	636.80	672.60	6.00	92.00	0.00	0.00	0.40			
3	B	665.14	687.80	6.00	272.00	0.00	0.00	0.40			
4	B	689.57	669.21	6.00	87.00	0.00	0.00	0.40			
5	B	717.95	674.64	6.00	157.00	0.00	0.00	0.40			
6	A	717.57	695.78	6.00	357.00	0.00	0.00	0.40			
7	A	724.86	734.98	6.00	0.00	0.00	0.00	0.40			
8	A	726.75	764.40	6.00	359.00	0.00	0.00	0.40			
9	B	736.70	785.95	6.00	268.00	0.00	0.00	0.40			
10	B	753.58	784.70	6.00	272.00	0.00	0.00	0.40			

**Layout Continued**

ID	Type	X	Y	Height	Angle	Tilt	Cant	Out-reach	Target X	Target Y	Target Z
11	B	745.54	762.86	6.00	90.00	0.00	0.00	0.40			
12	C	733.55	676.15	6.00	62.00	0.00	0.00	0.40			
13	C	769.95	655.29	6.00	62.00	0.00	0.00	0.40			
14	C	753.82	664.18	6.00	58.00	0.00	0.00	0.40			
16	C	615.84	659.99	6.00	357.00	0.00	0.00	0.40			
17	C	613.40	638.78	6.00	356.00	0.00	0.00	0.40			
18	C	611.98	612.99	6.00	350.00	0.00	0.00	0.40			
19	A	615.49	721.21	6.00	358.00	0.00	0.00	0.40			
20	A	613.95	700.40	6.00	357.00	0.00	0.00	0.40			
21	C	665.74	700.65	6.00	158.00	0.00	0.00	0.40			
22	C	627.59	596.44	6.00	82.00	0.00	0.00	0.40			
23	C	659.81	594.59	6.00	98.00	0.00	0.00	0.40			
24	C	686.88	598.37	6.00	100.00	0.00	0.00	0.40			
25	C	712.22	600.49	6.00	104.00	0.00	0.00	0.40			
26	C	726.51	616.95	6.00	167.00	0.00	0.00	0.40			
27	C	734.16	636.82	6.00	162.00	0.00	0.00	0.40			
28	C	741.85	656.43	6.00	161.00	0.00	0.00	0.40			
29	A	719.05	718.73	6.00	359.00	0.00	0.00	0.40			

# Horizontal Illuminance (lux)

Grid 1



## Results

Eav	5.10
Emin	1.22
Emax	13.36
Emin/Emax	0.09
Emin/Eav	0.24

# Horizontal Illuminance (lux)

Grid 1

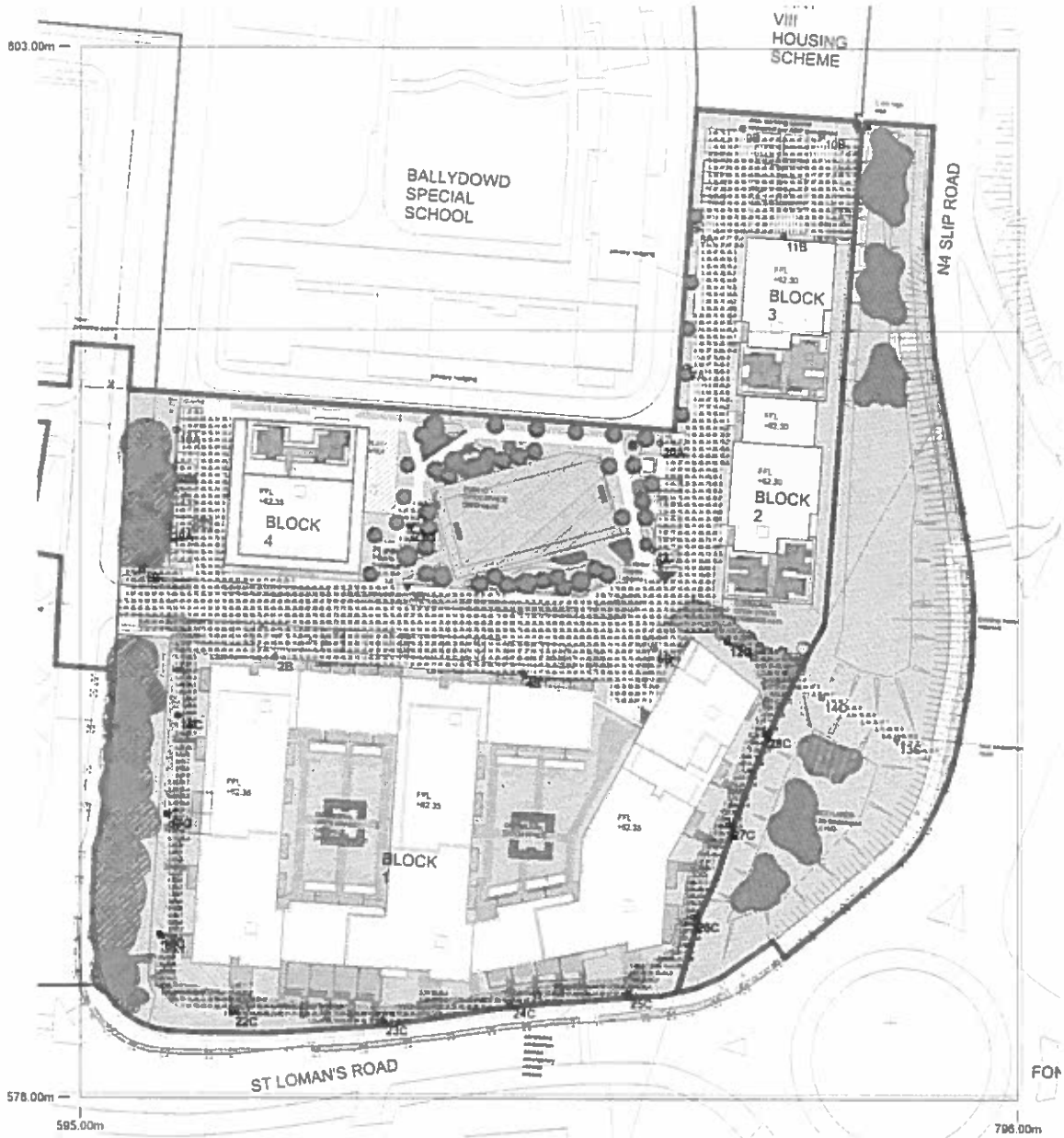

## Results

Eav	5.10
Emin	1.22
E <sub>max</sub>	13.36
E <sub>min</sub> /E <sub>max</sub>	0.09
E <sub>min</sub> /E <sub>av</sub>	0.24