

EXTERNAL WALKWAY

16100

8275

7825

375

C1

D

Do not scale - Use figured dimensions only - All dimensions are in millimeters -  
 All dimensions to be checked on site - Any discrepancies are to be reported  
 in writing to the Designer immediately. No part of this drawing may be reproduced  
 in any form or by any means without the written permission of Loscher Moran Consulting Engineers as copyright holder except as agreed  
 for use on the project for which the document was originally issued. ©

LEGEND:

- EXTENT OF VACANT RETAIL UNIT (B SUBJECT OF THIS CHANGE OF USE APPLICATION (PROPOSED MEDICAL CENTRE))
- EXISTING WALLS
- NEW STUD PARTITIONS
- EXISTING FOUL DRAINAGE PIPES
- PROPOSED NEW FOUL DRAINAGE PIPES (ALL TO BE BOXED OUT LOCALLY ABOVE EXISTING FLOOR)

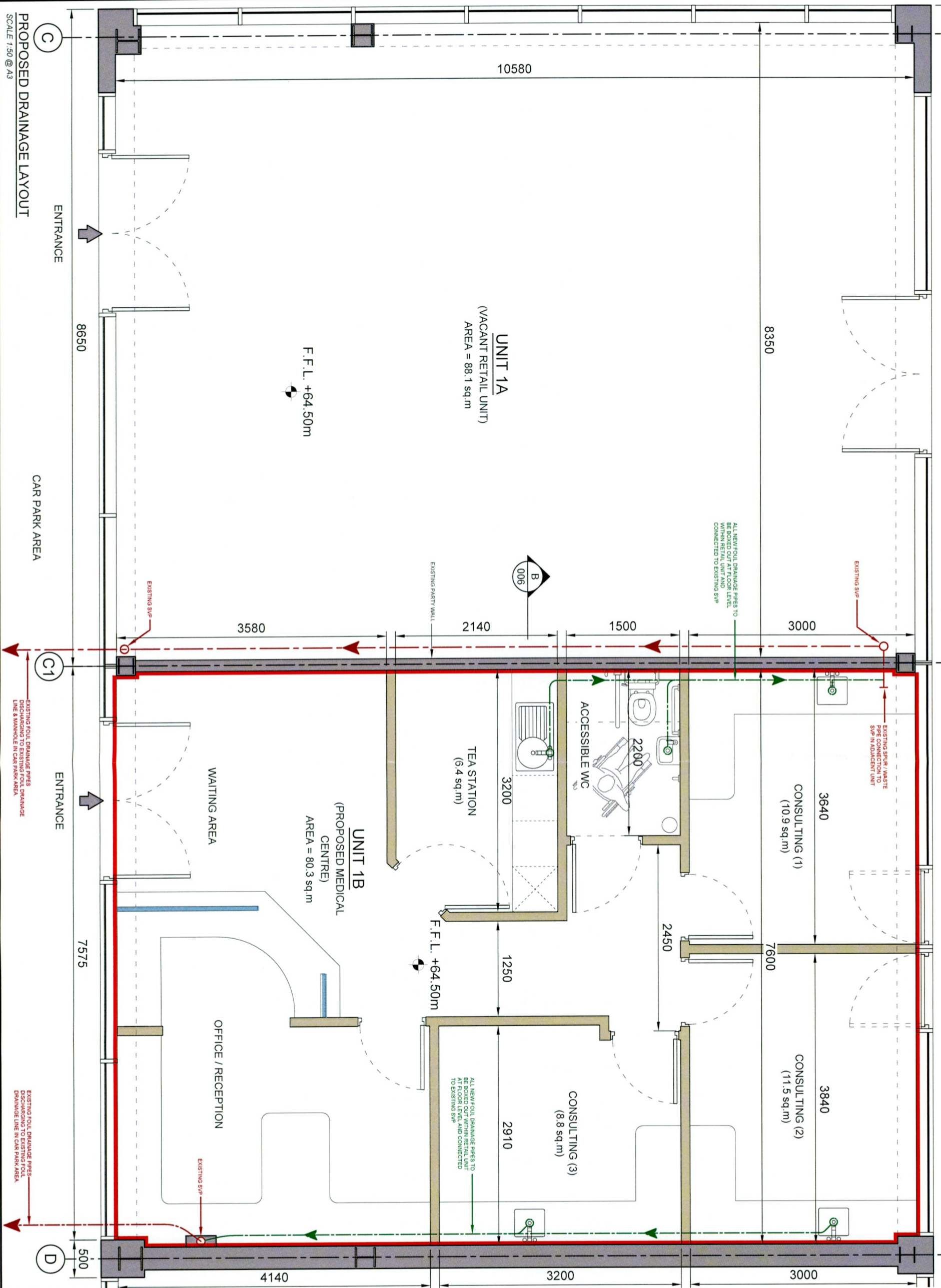

PROPOSED DRAINAGE LAYOUT

SCALE 1:50 @ A3

REV	DATE	DESCRIPTION	MT	KL
A	24.08.22	Additional Information		

**LOSCHER MORAN**  
DESIGN PRACTICE  
Address: Providence House, Blanchardstown Corporate Park, D15  
Tel: 015175959 Email: info@lmc.ie Web: www.lmc.ie

CLIENT NAME: Elaine Mulqueen  
PROJECT TITLE: Proposed Medical Centre  
LOCATION: Unit 1B - Tesco Extra, Liffey Valley  
DRAWN BY: MT CHKD BY: KL STATUS: Planning  
DATE: 24.08.22 SCALE: 1:50 @ A3  
DRG. No.: S1534-A-011