



A1 A

B

C

D

E

F

7500

5600

16100

16100

16100

BOUNDARY FENCE

BOUNDARY FENCE

7470

5090

70100

11130

10580

65260

4720

65260

ENTRANCE

ENTRANCE

CAR PARK

64.500

64.50

EXISTING FOUL DRAINAGE LINE

LOCATION OF SITE NOTICE 2

LOCATION OF SITE NOTICE 1

OUTLINE OF TESCO STORE OVERHEAD DASHED GREEN

Do not scale - Use figured dimensions only - All dimensions are in millimetres - All dimensions to be checked on site - Any discrepancies are to be reported immediately to the client and the design team - No part of this drawing is to be used in any form or stored in any retrieval system of any nature without the written permission of Loscher Moran Consulting Engineers as copyright holder except as agreed by use on the project for which the document was originally issued. ©

NOTES:

- SITE BOUNDARY SUBJECT OF THIS PLANNING APPLICATION
- OUTLINE OF TESCO RETAIL STORE ABOVE CAR PARK AREA
- LANDS IN OWNERSHIP OF TESCO IRELAND LTD. REFER TO SITE LOCATION MAPS FOR FULL EXTENT.
- EXISTING FOUL DRAINAGE PIPES (NO CHANGES PROPOSED)
- NOTE: ALL NEW DRAINAGE PROPOSED TO NEW FLOOR TO BE LOCATED ABOVE EXISTING FLOOR SLAB AND CONNECTED TO EXISTING FOUL DRAINAGE SYSTEM (SEE DWG S1534A-011 FOR DETAILS)

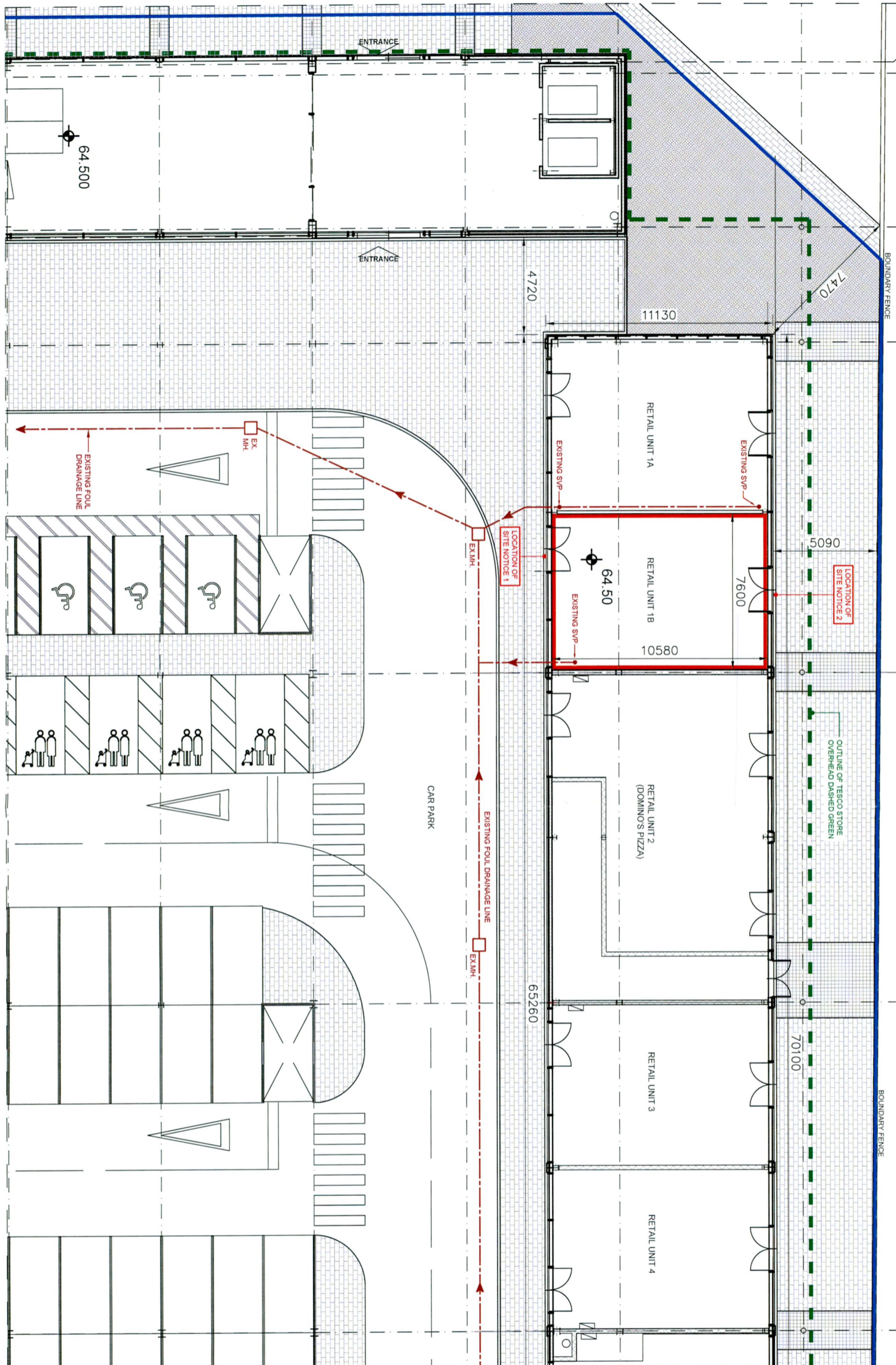

SITE PLAN
SCALE 1:200 @ A3

NO.	DATE	DESCRIPTION	ISSUED BY	CHECKED BY
B	24.05.22	Additional Information	MT	KL
A	26.05.22	Issued for Planning	MT	KL
			dm	ghd

LOSCHER MORAN
DESIGN PRACTICE

Address: Providence House, Blanchardstown Corporate Park, D15
Tel: 015179299 Email: info@loscher.com Website: www.loscher.com

CLIENT NAME Elaine Mulqueen
PROJECT TITLE Proposed Medical Centre
LOCATION Unit 1B - Tesco Extra, Liffey Valley
DRAWING TITLE Site Plan
DRAWN BY MT **CHKD BY** KL **STATUS** Planning
DATE 26.05.22 **SCALE** 1:200 @ A3
DRG. No. S1534A-003 **REV.** B