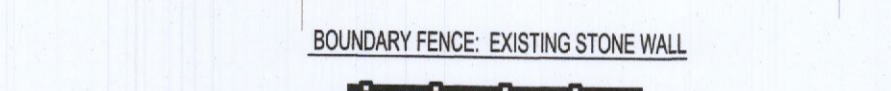
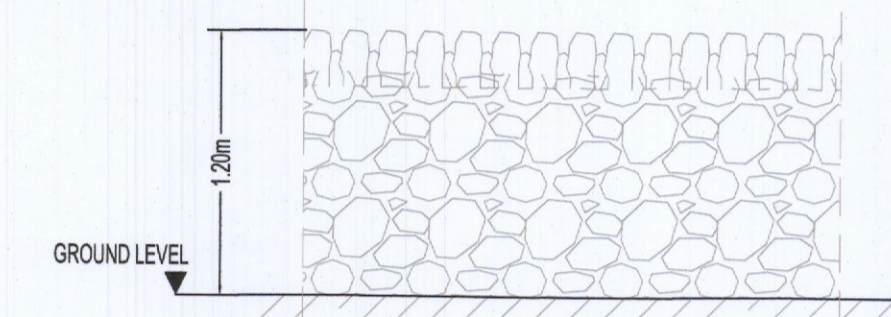
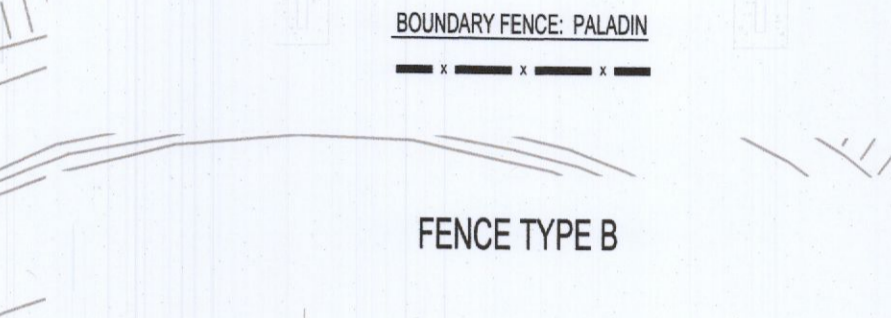
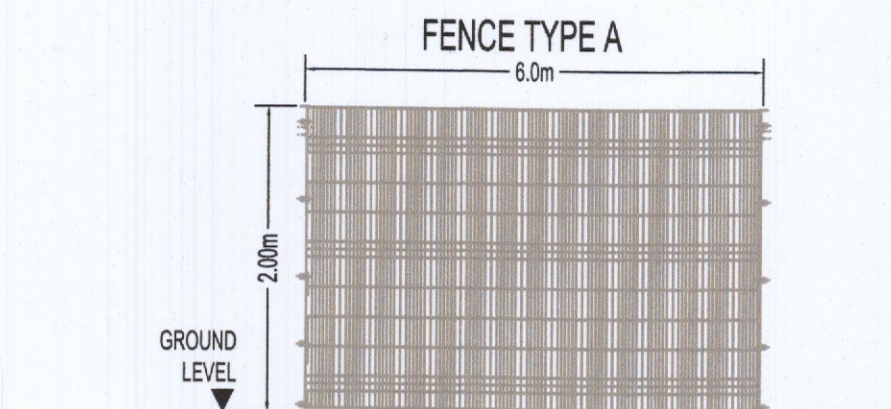
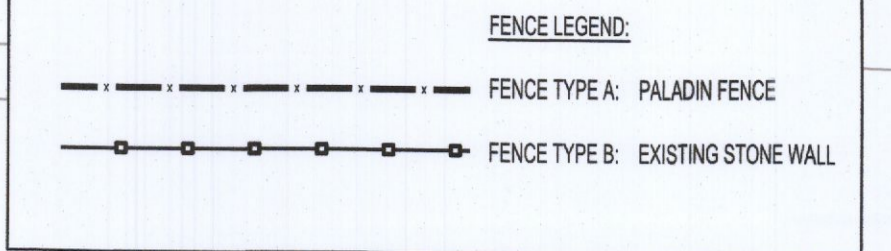
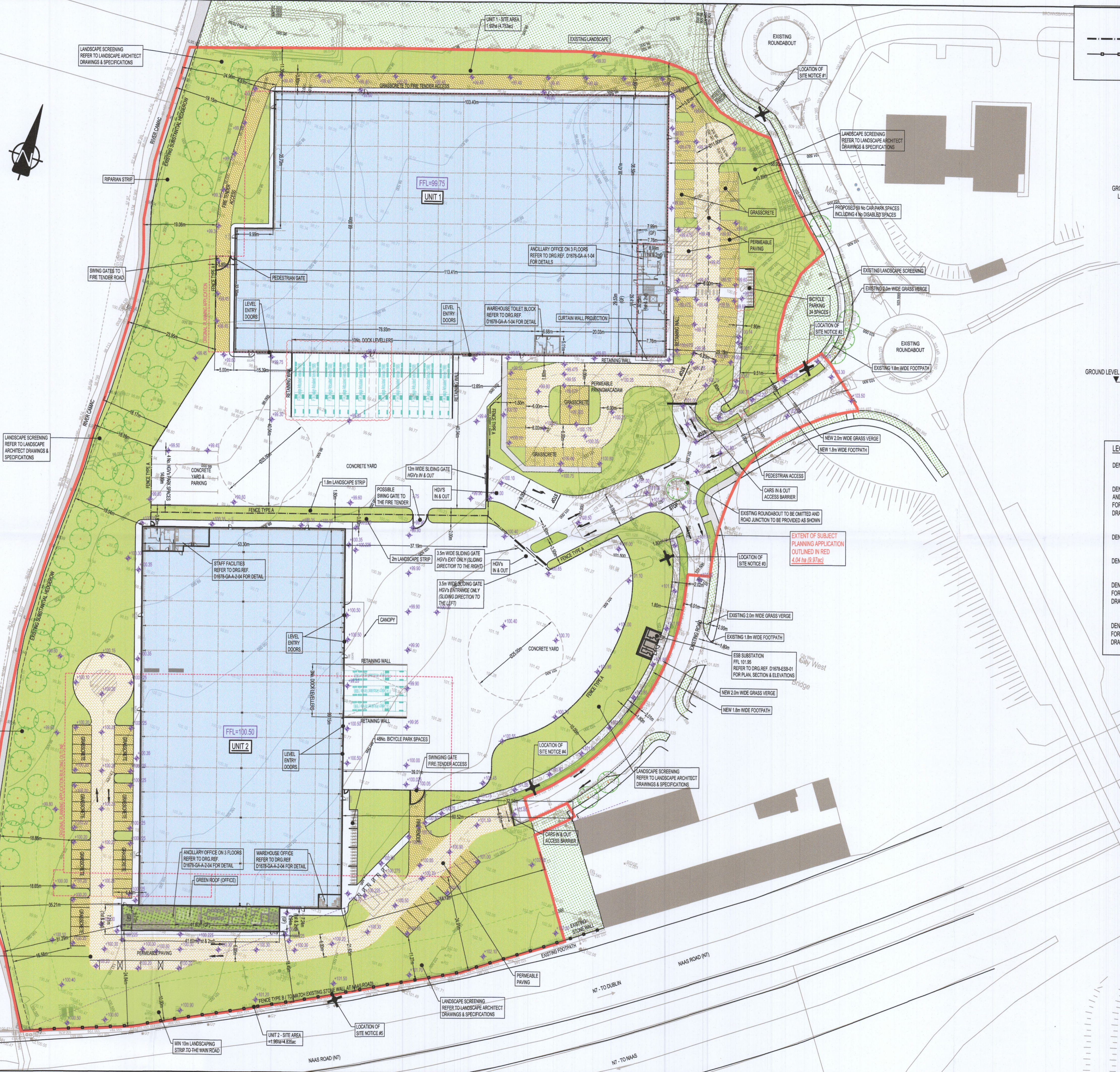

TABLE OF GROSS INTERNAL FLOOR AREAS & USES:

UNIT 1	OFFICE	STAFF FACILITIES	WAREHOUSE	TOTAL PROP.
GROUND FLOOR	249 m ² 2,687 sq.ft	6,983 m ² 75,164 sq.ft	7,232 m ² 77,864 sq.ft	
1ST FLOOR	181 m ² 1,948 sq.ft	74 m ² 796 sq.ft	255 m ² 2,744 sq.ft	
2ND FLOOR	181 m ² 1,948 sq.ft	74 m ² 796 sq.ft	255 m ² 2,744 sq.ft	
TOTAL	362 m ² 3,883 sq.ft	387 m ² 4,177 sq.ft	6,983 m ² 75,164 sq.ft	7,742 m ² 83,357 sq.ft

TABLE OF GROSS INTERNAL FLOOR AREAS & USES:

UNIT 2	OFFICE	STAFF FACILITIES	WAREHOUSE	TOTAL PROP.
GROUND FLOOR	150 m ² 1,614 sq.ft	247 m ² 2,659 sq.ft	5,148 m ² 55,417 sq.ft	5,545 m ² 59,690 sq.ft
1ST FLOOR	226 m ² 2,417 sq.ft	103 m ² 1,108 sq.ft	308 m ² 3,329 sq.ft	367 m ² 3,954 sq.ft
2ND FLOOR	226 m ² 2,417 sq.ft	103 m ² 1,108 sq.ft	308 m ² 3,329 sq.ft	367 m ² 3,954 sq.ft
TOTAL	582 m ² 6,245 sq.ft	453 m ² 4,875 sq.ft	5,148 m ² 55,417 sq.ft	6,183 m ² 66,539 sq.ft



LEGEND

- Denotes PERMEABLE SURFACING TO ROAD
- Denotes GRASSCRETE TO FIRE TENDER ROAD AND CAR PARKING FOR DETAILS REFER TO LANDSCAPE ARCHITECT DRAWINGS AND SPECIFICATIONS
- Denotes GREEN ROOF TO UNIT 2 OFFICE ROOF
- Denotes CONCRETE TO PROPOSED FOOTPATH
- Denotes LANDSCAPING FOR DETAILS REFER TO LANDSCAPE ARCHITECT DRAWINGS AND SPECIFICATIONS
- Denotes EXISTING LANDSCAPING FOR DETAILS REFER TO LANDSCAPE ARCHITECT DRAWINGS AND SPECIFICATIONS

Mark	Date	By	Chk.	App.	Revision
PL10	15/02/2021	TK	-	PK	ISSUED FOR PLANNING ADDITIONAL INFORMATION
PL9	08/08/2020	ED	-	PK	ISSUED FOR PLANNING

Drawing Status: **PLANNING A1**

Job Title: **WAREHOUSE DEVELOPMENT AT BROWNSBARN, CITYWEST CAMPUS, DUBLIN 24**

Drawing Title: **SITE PLAN**

Architect/Client: **Exeter Ireland Property IV B Limited**

KAVANAGH BURKE
CONSULTING ENGINEERS

Tel. 01 - 450 0694 Unit G3, Calmount Pk.
Ballymount, Dublin 12.
Fax. 01 - 426 4340
Email: pkavanagh@kavanaghuburke.ie

Dm	ED	Checked	Approved	PK
1:500; NTS				
Scale			Date	FEBRUARY 2022
Job No.	D1678	Drawing No.	D3	Rev.
				PL10