

**GENERAL NOTES:**  
 A. THIS DRAWING IS TO BE READ IN CONJUNCTION WITH ALL RELEVANT ARCHITECTURAL DRAWINGS, THE SPECIFICATION, AND ALL RELEVANT STANDARD DETAIL DRAWINGS.  
 B. THIS DRAWING IS TO BE READ IN CONJUNCTION WITH ALL RELEVANT CIVIL, STRUCTURAL, MECHANICAL AND ELECTRICAL DRAWINGS TOGETHER WITH THE SPECIFICATIONS AND SCHEDULES.  
 C. ALL DIMENSIONS IN MILLIMETRES. DO NOT SCALE FROM THIS DRAWING. USE FIGURED DIMENSIONS ONLY.  
 D. CONTRACTOR MUST VERIFY ALL DIMENSIONS ON SITE BEFORE SETTING OUT, COMMENCING WORK, OR PRODUCING ANY SHOP DRAWINGS.

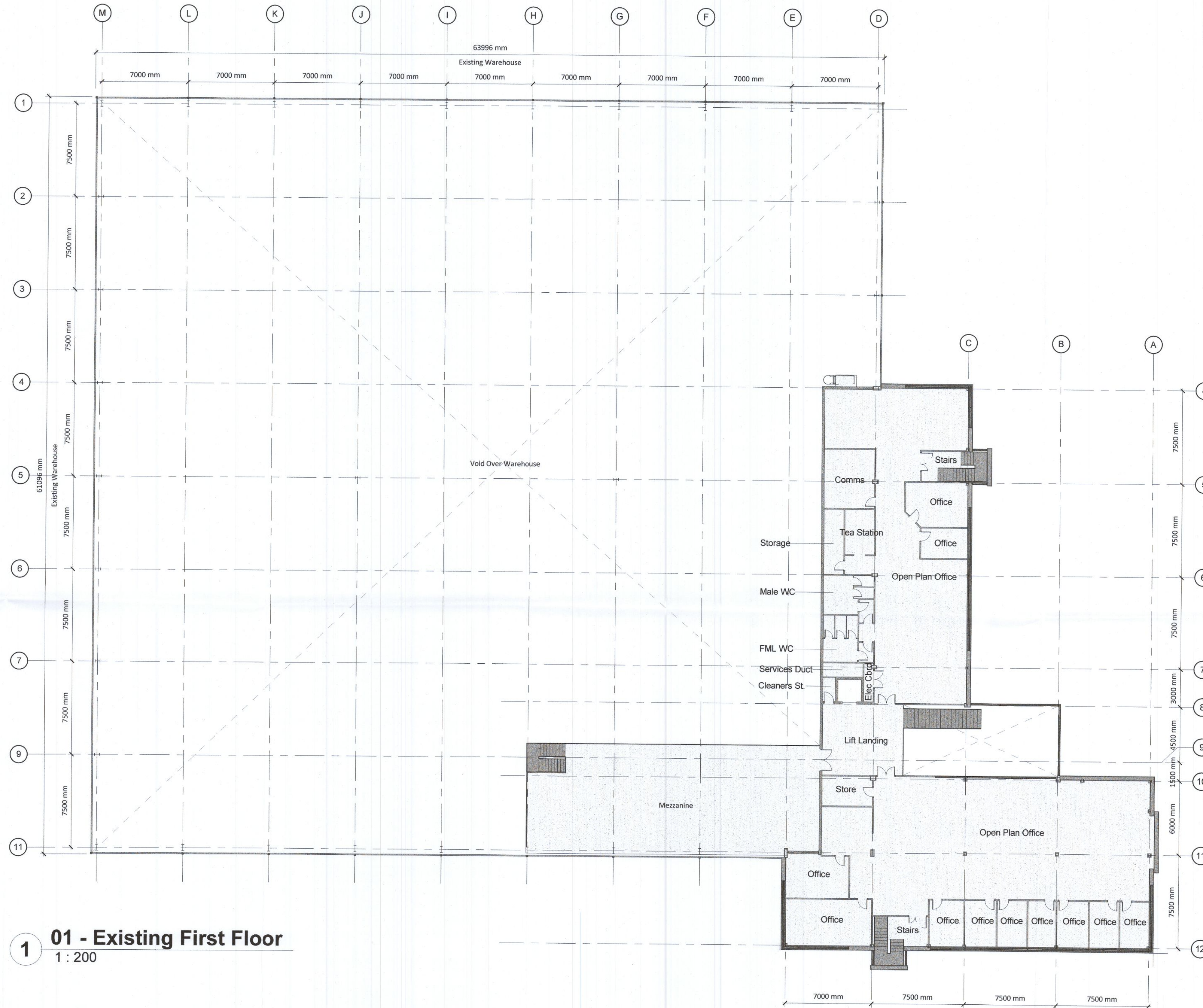

**1 01 - Existing First Floor**  
 1 : 200

**Planning**

Rev	Description	By	Clk	Date

**e ml architects**

20 Cruises Street  
 Limerick  
 V94 R6P9  
 Ireland  
 limerick@eml.ie  
 (061) 312249

37 Fitzwilliam Pl.  
 Dublin 2  
 D02 Y152  
 Ireland  
 dublin@eml.ie  
 (01) 6707677  
 www.eml.ie

Client	Origo Distribution Limited	Date	02/08/2022
Job	3561 - Origo Warehouse Extension	Scale @ A1	1 : 200
Sheet Title	Existing First Floor	Drawn by	JW
		Checked by	TMC
Job No.	3561	Stage	S2
		Drawing No.	3561-EML-XX-01-DR-A-102
			Project - Originator - Zone - Level - Doc Type - Role - Number
		Suitability	Rev