

GENERAL NOTES:

A. THIS DRAWING IS TO BE READ IN CONJUNCTION WITH ALL RELEVANT ARCHITECTURAL DRAWINGS, THE SPECIFICATION, AND ALL RELEVANT STANDARD DETAIL DRAWINGS.

B. THIS DRAWING IS TO BE READ IN CONJUNCTION WITH ALL RELEVANT CIVIL, STRUCTURAL, MECHANICAL AND ELECTRICAL DRAWINGS TOGETHER WITH THE SPECIFICATIONS AND SCHEDULES.

C. ALL DIMENSIONS IN MILLIMETRES. DO NOT SCALE FROM THIS DRAWING. USE FIGURED DIMENSIONS ONLY.

D. CONTRACTOR MUST VERIFY ALL DIMENSIONS ON SITE BEFORE SETTING OUT, COMMENCING WORK, OR PRODUCING ANY SHOP DRAWINGS.

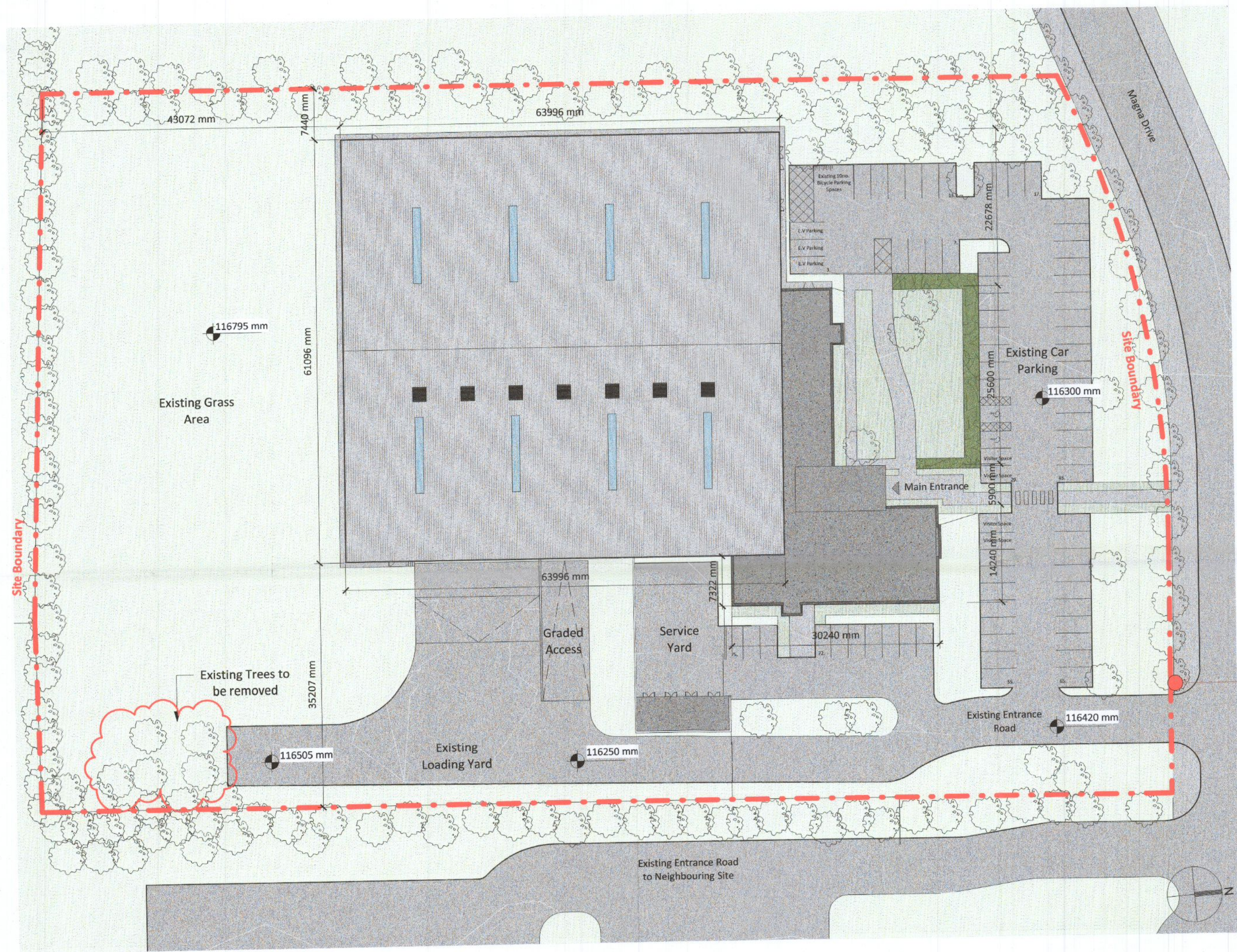

1 0 - Existing Site Layout
1 : 500

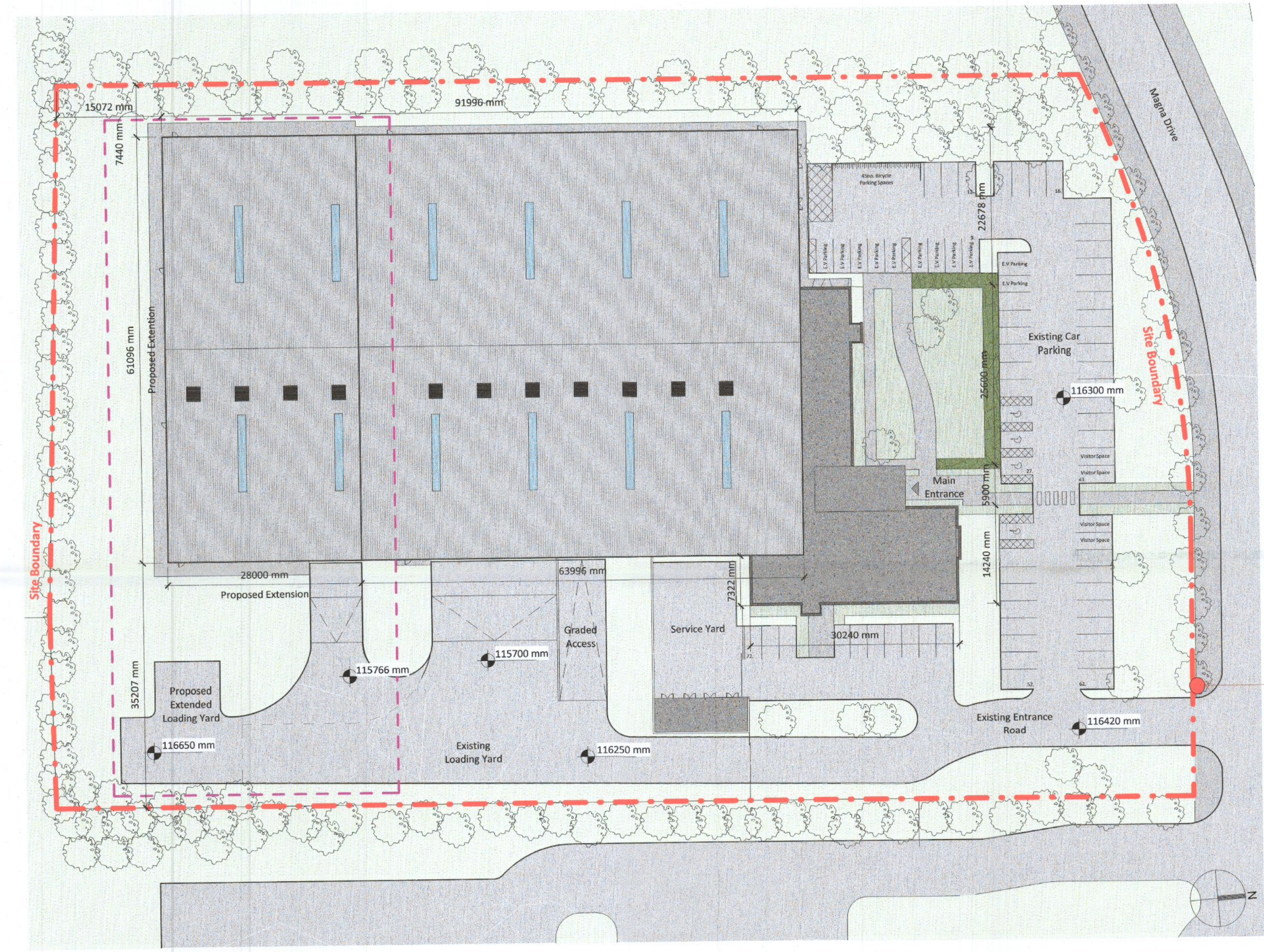

2 0 - Proposed Site Layout
1 : 500

Location of Site Notice

Location of Site Notice

Site Boundary - - - - -

Legend
1 : 500

Planning

Rev	Description	By	Ckd	Date
Revision 1				

20 Cruises Street
Limerick
V54 R6P9
Ireland

37 Fitzwilliam Pl.
Dublin 2
D02 YT52
Ireland

(061) 312248
limerick@eml.ie

(01) 6707677
dublin@eml.ie

www.eml.ie

Client	Origo Distribution Limited	Date	02/08/2022
Scale @ A1	1 : 500	Drawn by	JW
Job	3561 - Origo Warehouse Extension	Checked by	TMC
Sheet Title	Existing & Proposed Site Layout		
Job No.	3561	Stage	S2
Drawing No.	3561-EML-XX-00-DR-A-002		Suitability Rev
Project - Originator - Zone - Level - Doc Type - Role - Number			