

- All boundaries, dimensions and levels are to be checked on site before construction and any discrepancies are to be reported to the Architect.
- Partial Service: Any discrepancies with site or other information is to be advised to the Architect and direction or approval is to be sought before the implementation of the detail.
- Block and site plans are reproduced under license from the Ordnance Survey.
- Do not scale this drawing.
- For the purpose of coordination, all relevant parties must check this information prior to implementation and report any discrepancies to the Architect.

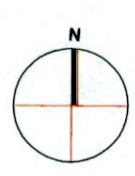

AREA SCHEDULE

ORIGINAL DWELLING - GROUND FLOOR AREA	50.4	50.47
ORIGINAL DWELLING - FIRST FLOOR AREA	4.2	4.73,6
REQUESTED DEVELOPMENT - GROUND FLOOR AREA	3.7	398.2
REQUESTED DEVELOPMENT - FIRST FLOOR AREA	0	0
AREA FOR RETENTION - GROUND FLOOR AREA	6	64.5
AREA FOR RETENTION - FIRST FLOOR AREA	0	0
TOTAL GROUND FLOOR AREA	87	935.3
TOTAL FIRST FLOOR AREA	4.2	452.0

LEGEND.

- AREA FOR RETENTION
- INDICATES LIMIT OF PROPERTY
- INDICATES EXTENT OF RETENTION

RETENTION

Adrian Hill Architects
 No. 13 The Seapoint Building,
 44/45 Clonarr Road, Dublin 3,
 t: +353 1 479 3141
 w: adrianhill.ie

Client
 NICK POLLY & ELSA JONES

Project
 12 AIRPARK RISE, RATHFARNHAM,
 DUBLIN 16

Drawing
 ROOF PLAN

Job No	Reg No	Rev No	Status
1757	(P)22	-	RETENTION
Scale	Date	Drawn by	Checked by
1:100@A1	Jul-22	JC	AH

REV/NO	DATE	NOTE

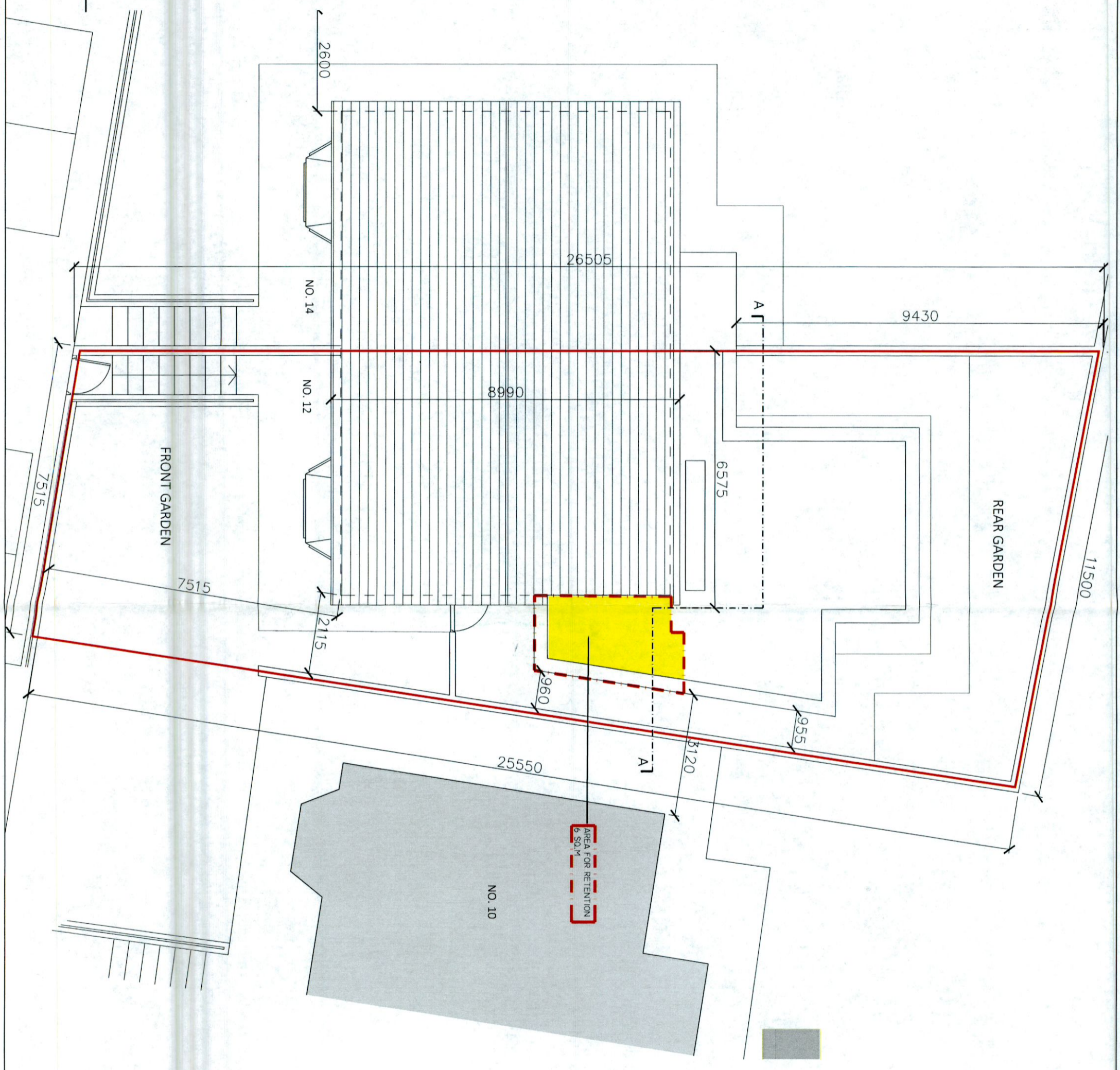

ROOF PLAN
 SCALE 1:100