

1. All boundaries, dimensions and levels are to be checked on site before construction and any discrepancies are to be reported to the Architect.
2. Partial Service: Any discrepancies with site or other information is to be advised to the Architect and direction or approval is to be sought before the implementation of the detail.
3. Block and site plans are reproduced under license from the Ordnance Survey.
4. Do not scale this drawing.
5. For the purpose of coordination, all relevant parties must check this information prior to implementation and report any discrepancies to the Architect.

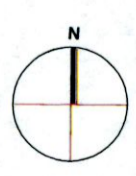

**AREA SCHEDULE**

ORIGINAL DWELLING GROUND FLOOR AREA	53.4	59.27
ORIGINAL DWELLING FIRST FLOOR AREA	4.4	4.73, 6
EXEMPTED DEVELOPMENT - GROUND FLOOR AREA	37	398.2
EXEMPTED DEVELOPMENT - FIRST FLOOR AREA	0	0
AREA FOR RETENTION - GROUND FLOOR AREA	5	54.5
AREA FOR RETENTION - FIRST FLOOR AREA	3	0
TOTAL GROUND FLOOR AREA	87	936.5
TOTAL FIRST FLOOR AREA	4.2	452.0

**LEGEND.**

- ORIGINAL DWELLING
- EXEMPTED DEVELOPMENT
- AREA FOR RETENTION
- INDICATES LIMIT OF PROPERTY
- INDICATES EXTENT OF RETENTION

**RETENTION**

**Adrian Hill Architects**  
 No. 13 The Seapoint Building,  
 44/45 Conlar Road, Dublin 3.  
 t: +353 1 479 3141  
 w: adrianhill.ie

Client  
**NICK POLLY & ELSA JONES**

Project  
**12 AIRPARK RISE, RATHFARNHAM,  
 DUBLIN 16**

Drawing  
**FIRST FLOOR PLAN**

Job No	Reg No	Rev No	Status
1757	(P)201	-	RETENTION

Scale	Date	Drawn by	Checked by
1:100@A1	JUL-22	JC	AH

Revisions	REV No	DATE	NOTE

PROPOSED FIRST FLOOR PLAN  
 SCALE 1:100

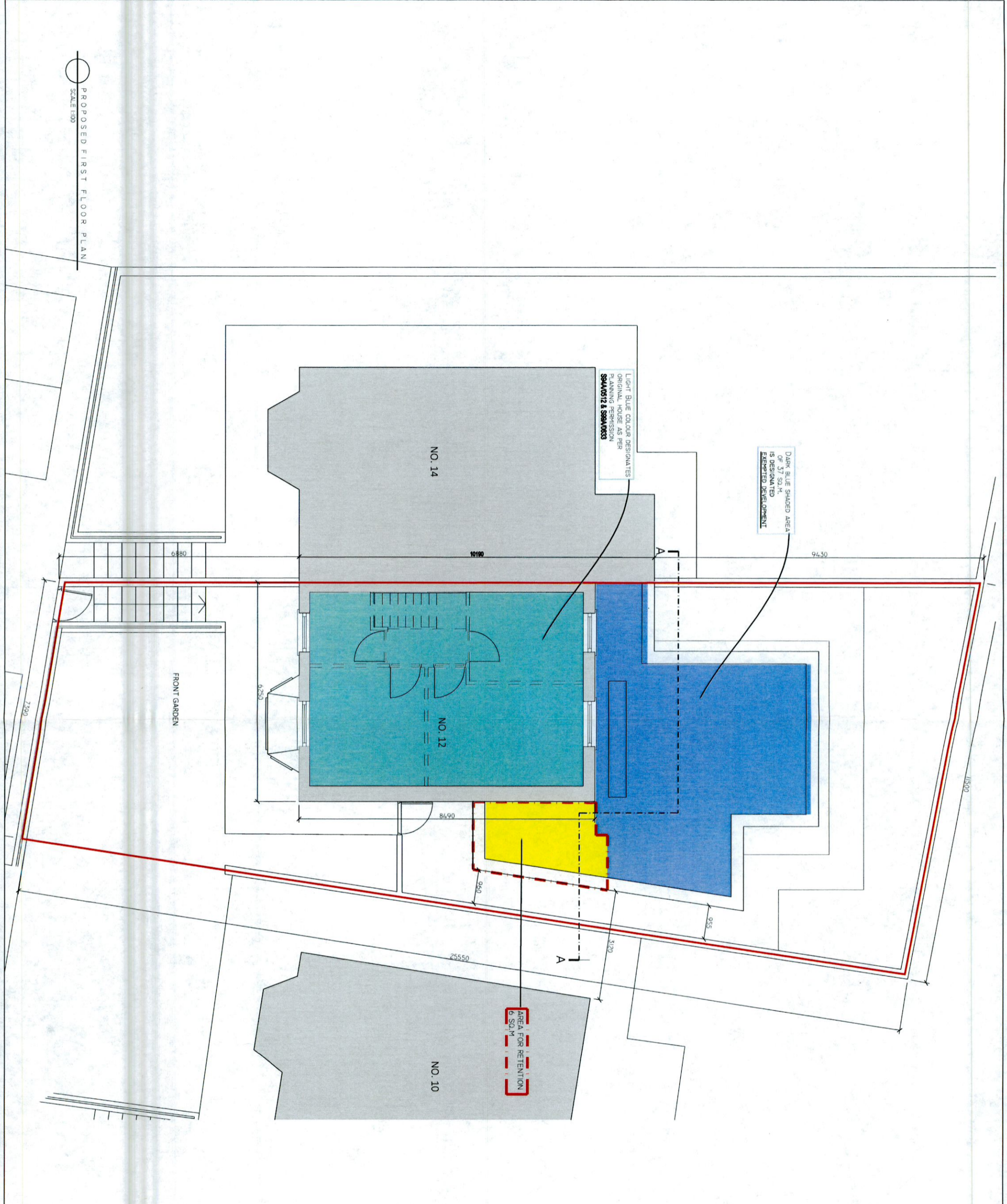

DARK BLUE SHADED AREA OF 37 SQ.M. IS DESIGNATED EXEMPTED DEVELOPMENT

LIGHT BLUE COLOUR DESIGNATES ORIGINAL HOUSE AS PER PLANNING PERMISSION S94A0512 & S94A0533

AREA FOR RETENTION 6 SQ.M