

- All boundaries, dimensions and levels are to be checked on site before construction and any discrepancies are to be reported to the Architect.
- Partial Services: Any discrepancies with site or other information is to be advised to the Architect and direction or approval is to be sought before the implementation of the detail.
- Block and site plans are reproduced under license from the Ordnance Survey.
- Do not scale this drawing.
- For the purpose of coordination, all relevant parties must check this information prior to implementation and report any discrepancies to the Architect.



**AREA SCHEDULE**

	SQ.M	SQ.FT
ORIGINAL DWELLING GROUND FLOOR AREA	44.6	473.6
ORIGINAL DWELLING FIRST FLOOR AREA	4.2	45.2
EXEMPTED DEVELOPMENT - GROUND FLOOR AREA	37	398.2
EXEMPTED DEVELOPMENT - FIRST FLOOR AREA	0	0
AREA FOR RETENTION - GROUND FLOOR AREA	6	64.5
AREA FOR RETENTION - FIRST FLOOR AREA	0	0
TOTAL GROUND FLOOR AREA	87	926.5
TOTAL FIRST FLOOR AREA	4.2	45.2

**LEGEND.**

- ORIGINAL DWELLING
- EXEMPTED DEVELOPMENT
- AREA FOR RETENTION
- INDICATES LIMIT OF PROPERTY
- INDICATES EXTENT OF RETENTION

**RETENTION**

**Adrian Hill Architects**  
 No. 13 The Seapoint Building,  
 44/45 Clonharf Road, Dublin 3.  
 t: +353 1 479 3141  
 w: adrianhill.ie

**Client**  
 NICK POLLY & ELSA JONES

**Project**  
 12 AIRPARK RISE, RATHFARNHAM,  
 DUBLIN 16

**Drawing**  
 GROUND FLOOR PLAN

Job No	Reg No	Rev No	Status
1757	(P)200	-	RETENTION

Scale	Date	Drawn by	Checked by
1:100@A1	Jul-22	JC	AH

Revisions  
 REV No DATE NOTE

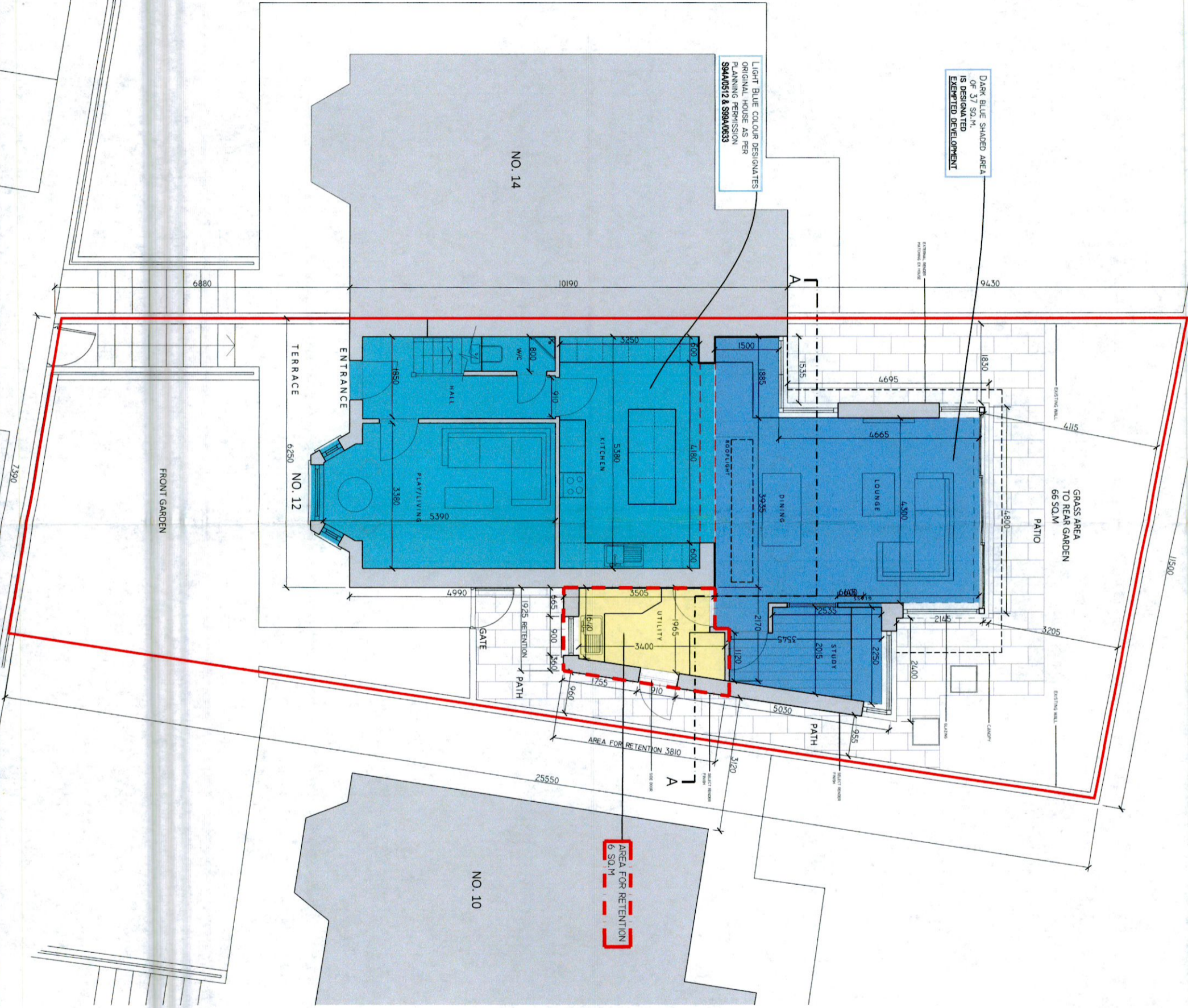

DARK BLUE SHADED AREA OF 37 SQ.M. IS DESIGNATED EXEMPTED DEVELOPMENT

LIGHT BLUE COLOUR DESIGNATES ORIGINAL HOUSE AS PER PLANNING PERMISSION S94A0512 & S98A0633

PROPOSED GROUND FLOOR PLAN  
 SCALE 1:100