

- Room Legend**
- Cloaks
 - Dining Room
 - Family Room
 - Hall
 - Kitchen
 - Living Room
 - Porch
 - Utility Room
 - WC

1 Level 0 Ground Floor CF
1 : 200

Room Schedule Existing		
Level	Name	Area

Level 0 Ground Floor	Living Room	1	20 m ²
Level 0 Ground Floor	Kitchen	2	21 m ²
Level 0 Ground Floor	Hall	3	10 m ²
Level 0 Ground Floor	Porch	4	3 m ²
Level 0 Ground Floor	Dining Room	5	14 m ²
Level 0 Ground Floor	Family Room	6	13 m ²
Level 0 Ground Floor	WC	8	1 m ²
Level 0 Ground Floor	Utility Room	9	2 m ²
Level 0 Ground Floor	Cloaks	10	1 m ²
85 m ²			

Level 1 First Floor			
Level 1 First Floor	Master Bedroom	11	15 m ²
Level 1 First Floor	Bedroom 2	12	11 m ²
Level 1 First Floor	Bedroom 3	13	7 m ²
Level 1 First Floor	Bathroom	14	4 m ²
Level 1 First Floor	Landing	15	8 m ²
Level 1 First Floor	Hot Press	16	1 m ²
Level 1 First Floor	Bedroom 1	17	9 m ²
Level 1 First Floor	Bedroom 1	18	9 m ²
Level 1 First Floor	Closet	18	1 m ²
Level 1 First Floor	Closet	19	1 m ²
57 m ²			

Level 2 Second Floor			
Level 2 Second Floor	Attic Storage	20	60 m ²
60 m ²			
Total Floor Area			
203 m ²			

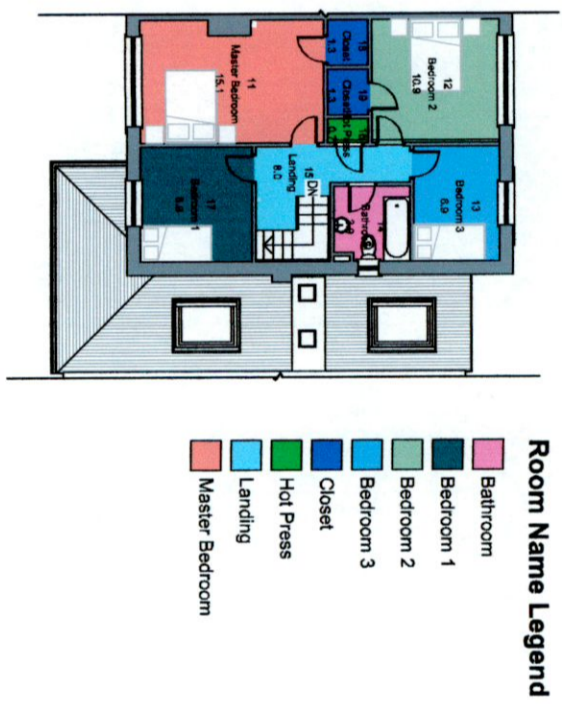

- Room Name Legend**
- Bathroom
 - Bedroom 1
 - Bedroom 2
 - Bedroom 3
 - Closet
 - Hot Press
 - Landing
 - Master Bedroom

2 Level 1 First Floor CF
1 : 200

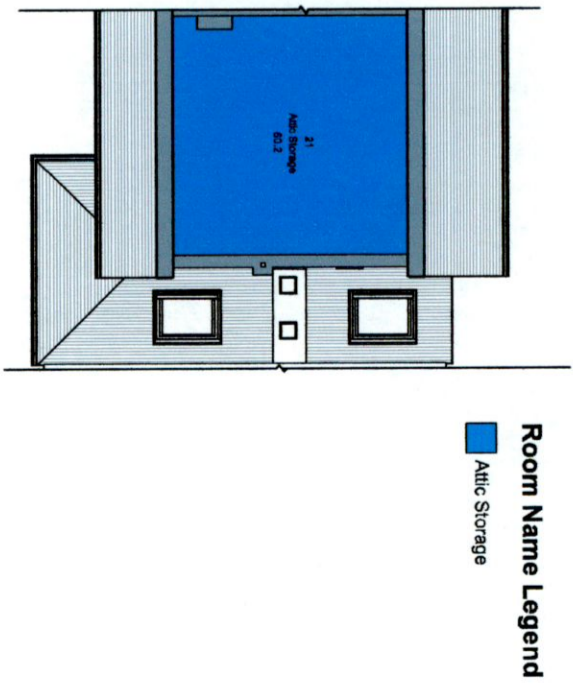

- Room Name Legend**
- Attic Storage

3 Level 2 Second Floor CF
1 : 200

REF.	DATE	Revision
Peter Brennan Hayfield House, Knocklyon Road, Templeogue, Dublin 16		
North Point		
PROJECT: Proposed Hipped Roof to the Side over the Single Storey		
PROJECT NO.: PRJ079		
CLIENT: Rachel Glennon		
ADDRESS: 12 Templeogue Wood, Dublin SW, DSW W304		
DRAWN BY: Peter Brennan		
DATE: 09/07/22		
SCALE: 1 : 200		
DRG. No. P111		
DRAWING: Colour Fill Plans Proposed		
DO NOT SCALE FROM DRAWING STATUS: Planning		