









THE INFORMATION ON THIS DRAWING IS TO THE ORDNANCE SURVEY IRELAND ITM COORDINATE SYSTEM

LEGEND

-  Outline of Proposed Site Works
-  PEDESTRIAN ROUTES & PLAY AREAS
-  ROADS
-  CARPARKING (PERMEABLE PAVING)
-  PLANTING AREA
-  ROAD GULLY
-  GRADIENT MAGNITUDE AND DIRECTION
-  DROPPED KERBS

NOTES:

1. FIGURED DIMENSIONS ONLY TO BE TAKEN FROM THIS DRAWING.
2. ALL DRAWINGS TO BE CHECKED BY THE CONTRACTOR ON SITE.
3. ENGINEER/EMPLOYERS REPRESENTATIVE, AS APPROPRIATE, TO BE INFORMED BY THE CONTRACTOR OF ANY DISCREPANCIES BEFORE ANY WORK COMMENCES.
4. THE CONTRACTOR SHALL UNDERTAKE A THOROUGH CHECK FOR THE ACTUAL LOCATION OF ALL SERVICES/UTILITIES, ABOVE AND BELOW GROUND, BEFORE ANY WORK COMMENCES.
5. ALL LEVELS SHOWN RELATE TO ORDNANCE SURVEY DATUM AT MALIN HEAD.

Rev	Date	Description	By	Chkd.
A	13.02.2017	PLANNING	CS	AM

Client: Department of Education and Skills

Project: 6.1 Clondalkin Old Nangor Road Clondalkin Dublin 22

Title: PROPOSED ROADS LAYOUT

Scale @ A1: 1:500
 Prepared by: CS Checked: AM Date: FEB 2017
 Project Director: CIARAN MCGOVERN
 Drawing Status: PLANNING

TOBIN
 Patrick J. Tobin & Co. Ltd.
 TOBIN Consulting Engineers,
 2nd Floor, Elgee Building, Market Square,
 Dundalk, Co. Louth, Ireland.
 tel: +353-(0)42-9335107
 fax: +353-(0)42-9331715
 e-mail: dundalk@tobin.ie
 www.tobin.ie

TOBIN Consulting Engineers will not be liable for any use of this document for any purpose other than that for which it was originally prepared and provided. Except where specifically and expressly agreed in writing by TOBIN Consulting Engineers, no copyright, trademark, or other intellectual property rights shall be transferred in any form and no document shall be relied upon by any third party for any purpose.
 Drawing No.: 8064-2503 Revision: A

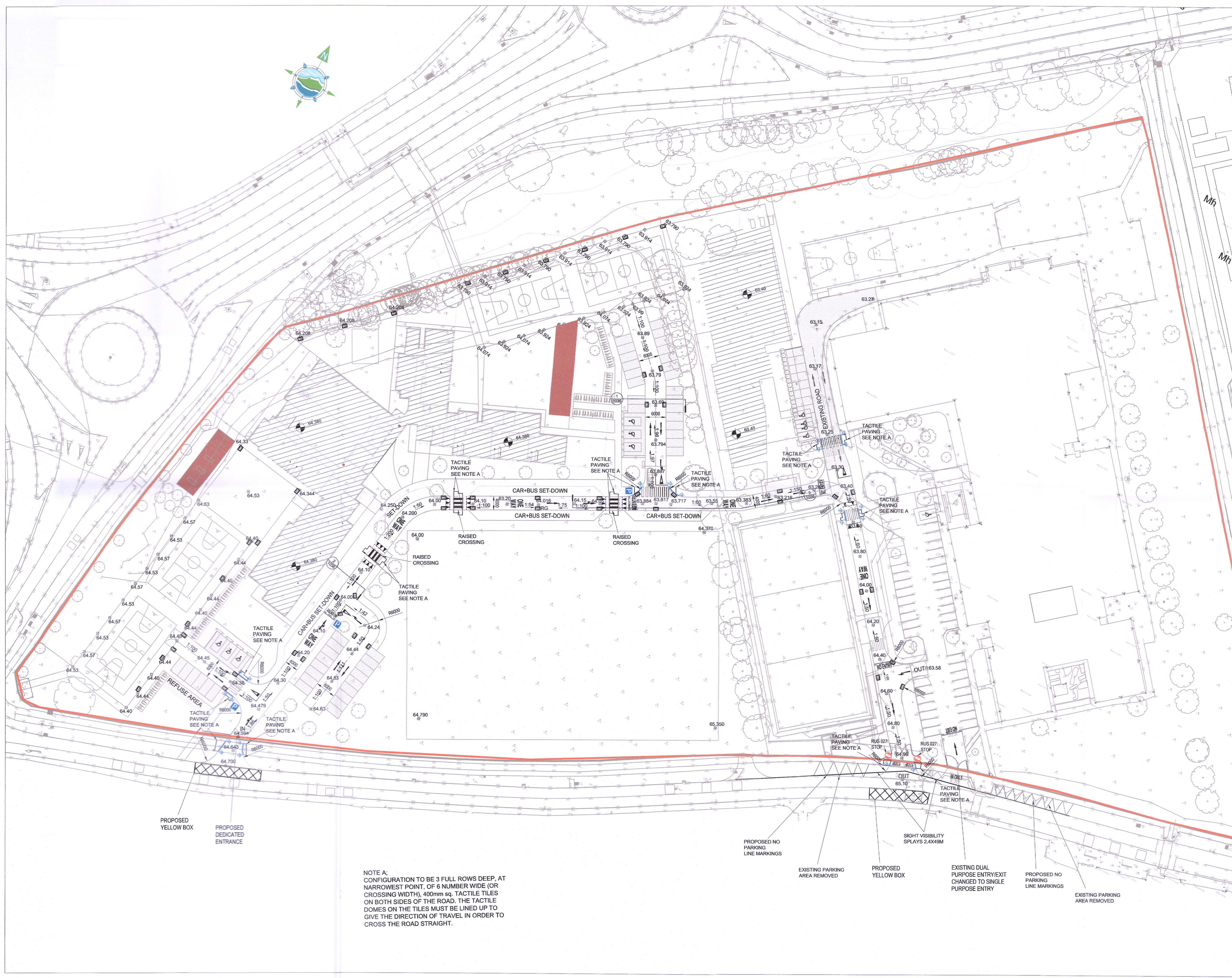

NOTE A:
 CONFIGURATION TO BE 3 FULL ROWS DEEP, AT NARROWEST POINT, OF 6 NUMBER WIDE (OR CROSSING WIDTH), 400mm sq. TACTILE TILES ON BOTH SIDES OF THE ROAD. THE TACTILE DOMES ON THE TILES MUST BE LINED UP TO GIVE THE DIRECTION OF TRAVEL IN ORDER TO CROSS THE ROAD STRAIGHT.

PROPOSED YELLOW BOX
 PROPOSED DEDICATED ENTRANCE

PROPOSED NO PARKING LINE MARKINGS
 EXISTING PARKING AREA REMOVED
 PROPOSED YELLOW BOX
 EXISTING DUAL PURPOSE ENTRY/EXIT CHANGED TO SINGLE PURPOSE ENTRY
 PROPOSED NO PARKING LINE MARKINGS
 EXISTING PARKING AREA REMOVED

SIGHT VISIBILITY SPLAYS 2.4X49M

RUS 027 STOP

RUS 027 STOP

TACTILE PAVING SEE NOTE A