

(C) No dimensions to be scaled from this drawing. All dimensions to be checked by the contractor on site, any errors or discrepancies to be reported to the Architects.

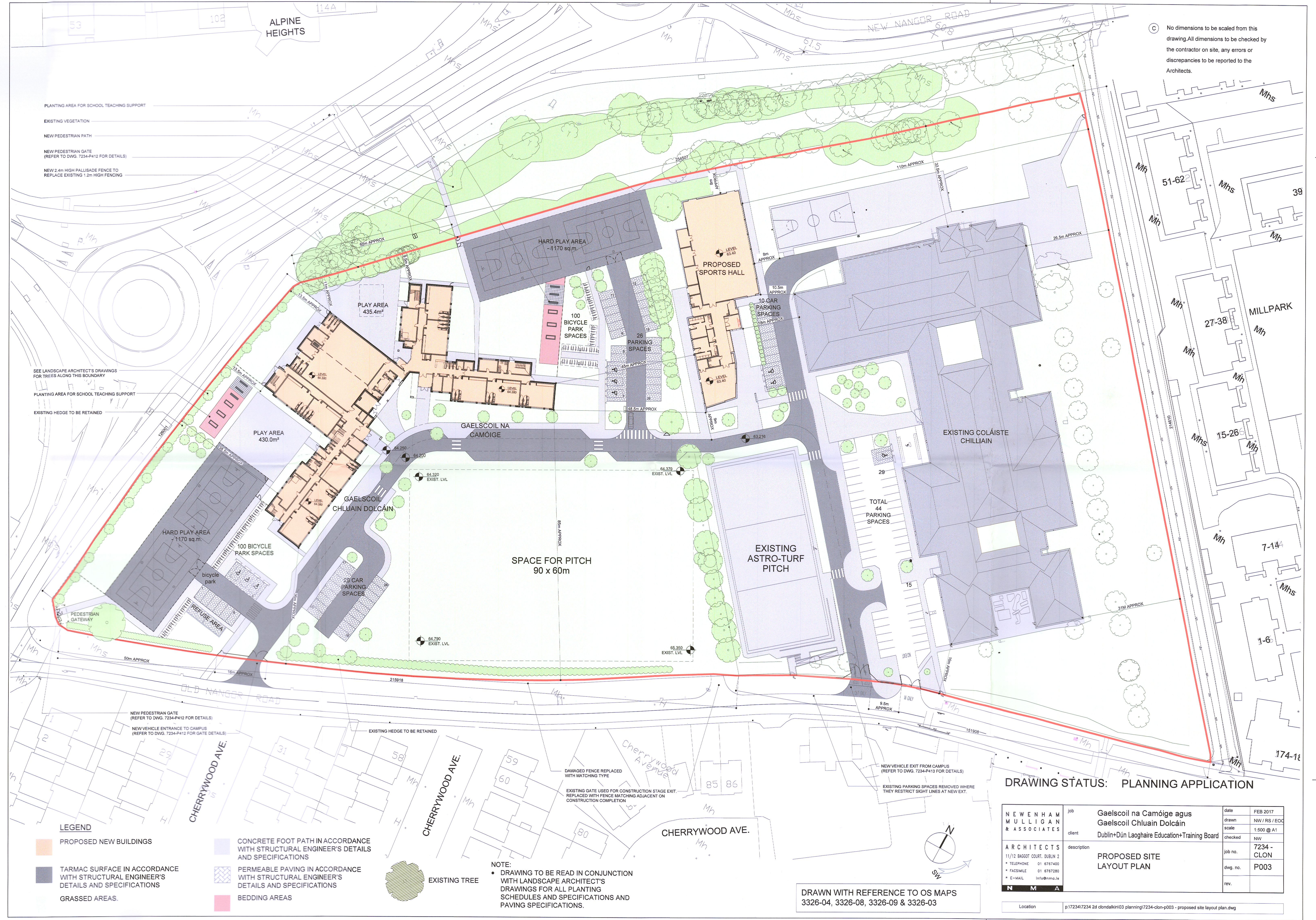

PLANTING AREA FOR SCHOOL TEACHING SUPPORT
 EXISTING VEGETATION
 NEW PEDESTRIAN PATH
 NEW PEDESTRIAN GATE (REFER TO DWG. 7234-P412 FOR DETAILS)
 NEW 2.4m HIGH PALLISADE FENCE TO REPLACE EXISTING 1.2m HIGH FENCING

SEE LANDSCAPE ARCHITECT'S DRAWINGS FOR TREES ALONG THIS BOUNDARY
 PLANTING AREA FOR SCHOOL TEACHING SUPPORT
 EXISTING HEDGE TO BE RETAINED

NEW PEDESTRIAN GATE (REFER TO DWG. 7234-P412 FOR DETAILS)
 NEW VEHICLE ENTRANCE TO CAMPUS (REFER TO DWG. 7234-P412 FOR GATE DETAILS)

DAMAGED FENCE REPLACED WITH MATCHING TYPE
 EXISTING GATE USED FOR CONSTRUCTION STAGE EXIT. REPLACED WITH FENCE MATCHING ADJACENT ON CONSTRUCTION COMPLETION

NEW VEHICLE EXIT FROM CAMPUS (REFER TO DWG. 7234-P413 FOR DETAILS)
 EXISTING PARKING SPACES REMOVED WHERE THEY RESTRICT SIGHT LINES AT NEW EXIT.

LEGEND

- PROPOSED NEW BUILDINGS
- CONCRETE FOOT PATH IN ACCORDANCE WITH STRUCTURAL ENGINEER'S DETAILS AND SPECIFICATIONS
- TARMAC SURFACE IN ACCORDANCE WITH STRUCTURAL ENGINEER'S DETAILS AND SPECIFICATIONS
- PERMEABLE PAVING IN ACCORDANCE WITH STRUCTURAL ENGINEER'S DETAILS AND SPECIFICATIONS
- GRASSED AREAS.
- BEDDING AREAS
- EXISTING TREE

NOTE:
 • DRAWING TO BE READ IN CONJUNCTION WITH LANDSCAPE ARCHITECT'S DRAWINGS FOR ALL PLANTING SCHEDULES AND SPECIFICATIONS AND PAVING SPECIFICATIONS.

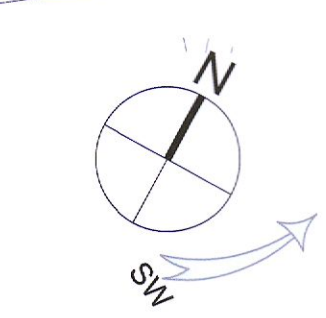

DRAWN WITH REFERENCE TO OS MAPS
 3326-04, 3326-08, 3326-09 & 3326-03

DRAWING STATUS: PLANNING APPLICATION

NEWENHAM MULLIGAN & ASSOCIATES ARCHITECTS 11/12 BAGGOT COURT, DUBLIN 2 * TELEPHONE 01 6767400 * FACSIMILE 01 6767280 * E-MAIL info@nma.ie	job Gaelscoil na Camóige agus Gaelscoil Chluain Dolcáin	date FEB 2017
	client Dublin+Dún Laoghaire Education+Training Board	drawn NW / RS / EOC
description PROPOSED SITE LAYOUT PLAN	checked NW	job no. 7234 - CLON
		dwg. no. P003
		rev.

Location p:\7234\7234 2d clondalkin\03 planning\7234-clon-p003 - proposed site layout plan.dwg