

ROOF MAKE UP
 3 LAYERS OF MINERAL FELT ON
 MBP PLYWOOD DECKING ON
 FIRING DICES (1:60)
 150mmx50mm JOISTS @ 400mm/c
 150mm ROCKWOOL BETWEEN JOISTS
 AND 38mm BELOW

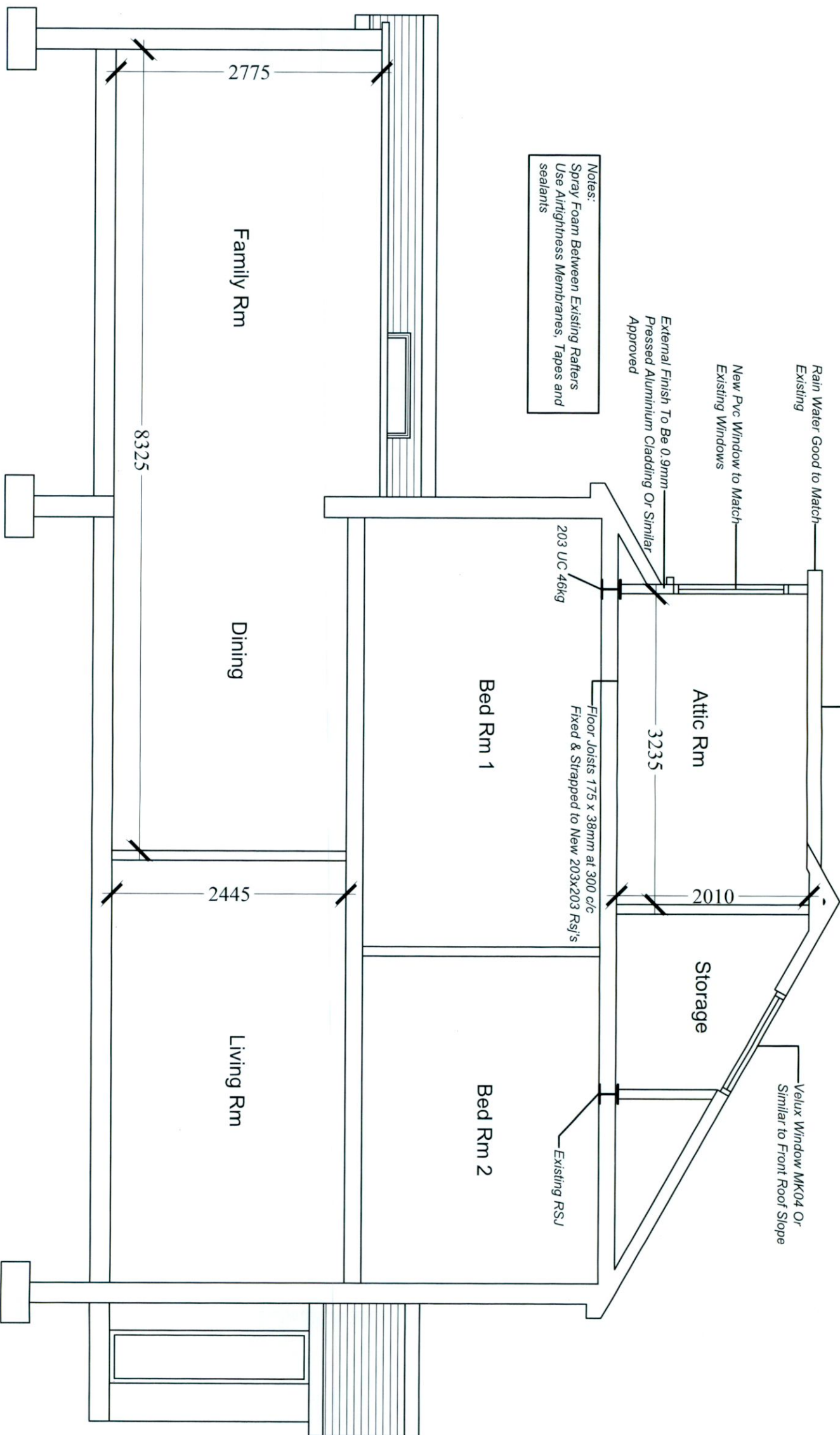

Notes:
 Spray Foam Between Existing Rafters
 Use Airtightness Membranes, Tapes and
 sealants

External Finish To Be 0.9mm
 Pressed Aluminium Cladding Or Similar
 Approved

Rain Water Good to Match
 Existing

New Pvc Window to Match
 Existing Windows

203 UC 46kg

Floor Joists 175 x 38mm at 300 c/c
 Fixed & Strapped to New 203x203 Rsj's

Velux Window MK04 Or
 Similar to Front Roof Slope

Existing RSJ

THIS DRAWING IS ISSUED FOR PLANNING
 ONLY, AND IS NOT A CONSTRUCTION DRAWING

ALL BUILDING WORK TO BE CARRIED OUT
 IN ACCORDANCE WITH ENGINEERS DETAILS
 & CURRENT BUILDING REGULATIONS

CONTRACTORS MUST VERIFY ALL DIMENSIONS
 ON SITE BEFORE COMMENCING ANY WORK.
 NO WORKING DIMENSIONS TO BE SCALED.
 DIMENSIONS TO BLOCKWORK ONLY.
 THIS DRAWING AND DESIGN IS COPYRIGHT AND
 IS THE PROPERTY OF JASON WALSH.

PL1	Issued For Planning	JW	JW	July 2022
REV1	REVISION TITLE	BRM	CHD	DATE
APPLICANT: Ronan Lyons				
APPLICANT: Jason Walsh Architectural & Engineering 12 ARD MOR CRESCENT TALLAGHT DUBLIN 24 PHONE: 085 8070 432 EMAIL: G.JL.SERVICES@GMAIL.COM		JOB TITLE: Proposed Dormor Roof At 19 Willington Grove, Templeogue, Dublin 6W.		

DRAWING TITLE: Proposed Section				
SCALE:	INITIALS	DATE		
1:50	JW	23.07.2022		
JOB No	DRAWING No	REV1		
RL-22	RL-22-09	PL1		