



Willington Grove
● LVL 100.00

Location of
Site Notice

7568,72
8096,4

Proposed Velux Window

LVL 100.10

Proposed Velux Window

Proposed Dormer
Roof

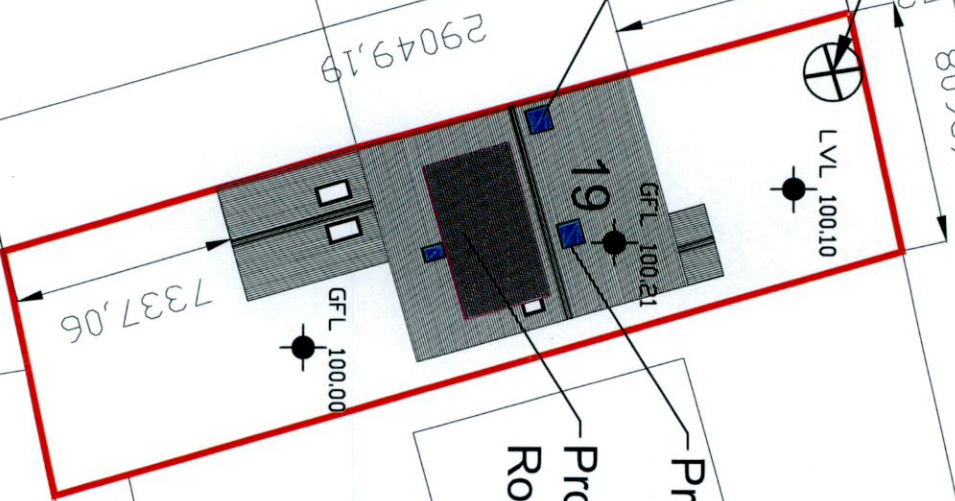

Note
As no Benchmark is indicated on the D.S. map the levels indicate relate to an assumed level of +100.00 in the centre of the roadway
GFL = Ground Floor Finished Level

THIS DRAWING IS ISSUED FOR PLANNING ONLY, AND IS NOT A CONSTRUCTION DRAWING

ALL BUILDING WORK TO BE CARRIED OUT IN ACCORDANCE WITH ENGINEERS DETAILS & CURRENT BUILDING REGULATIONS

CONTRACTORS MUST VERIFY ALL DIMENSIONS ON SITE BEFORE COMMENCING ANY WORK. NO WORKING DIMENSIONS TO BE SCALED. DIMENSIONS TO BLOCKWORK ONLY. THIS DRAWING AND DESIGN IS COPYRIGHT AND IS THE PROPERTY OF JASON WALSH.

PL1	Issued For Planning	JW	JW	July 2022
REV/	REVISION TITLE	DRW/	CHD/	DATE

APPLICANT:
Ronan Lyons

JOB TITLE:
Proposed Dormor Roof At
19 Willington Grove,
Templeogue,
Dublin 6W.

Jason Walsh
Architectural & Engineering
12 ARD MOR CRESCENT
TALLAGHT
DUBLIN 24
PHONE: 085 8070 432
EMAIL: G.JL.SERVICES@GMAIL.COM

DRAWING TITLE:
Proposed Site Plan

SCALE:
1:250

JOB No:

RL-22

INITIALS

JW

DATE

23.07.2022

DRAWING No:

RL-22-05

REV:

PL1