

ALL SITE STAFF COME FROM MAIN ADMINISTRATION BUILDING (USING THE EXISTING ILLUMINATED DESIGNATED PEDESTRIAN ROUTES TO MOVE AROUND THE SITE)

EXISTING ILLUMINATED PEDESTRIAN CROSSING

EXISTING ILLUMINATED ACCESS ROAD & PEDESTRIAN FOOTPATH

PROPOSED ONE WAY SYSTEM TO ACCESS ROAD

PROPOSED PEDESTRIAN CROSSING TO MATCH EXISTING CROSSINGS ON SITE

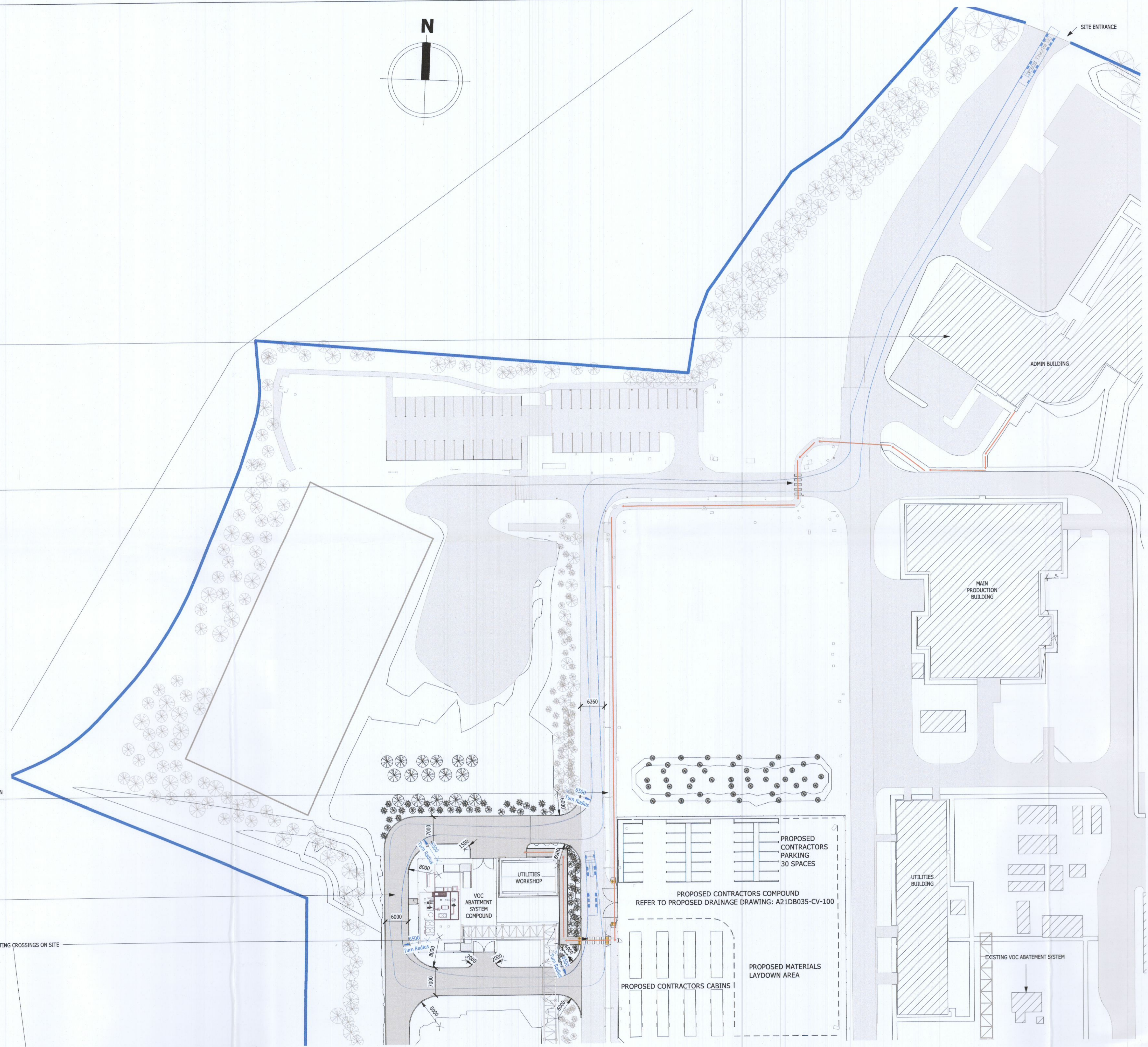

- NOTES**
1. THIS DRAWING IS TO BE READ IN CONJUNCTION WITH ALL RELEVANT ARCHITECTS AND ENGINEER'S DRAWINGS, SPECIFICATIONS AND SCOPE OF WORKS DOCUMENTS.
 2. DO NOT SCALE DRAWINGS. USE FIGURED DIMENSIONS ONLY & VERIFY ON SITE.
 3. ANY DISCREPANCIES TO BE REPORTED TO THE ARCHITECT / CM TEAM IMMEDIATELY.
 4. ALL DIMENSIONS ARE IN MILLIMETRES.
 5. ALL LEVELS ARE IN METERS.
 6. DRAWING TO BE READ IN CONJUNCTION WITH OTHER PROJECT DISCIPLINE DRAWINGS.
 7. COORDINATE ALL ACTIVITIES WITH CONSTRUCTION MANAGEMENT TEAM ON ACTIVITIES REQUIRING OTHER TRADES ATTENDANCE.

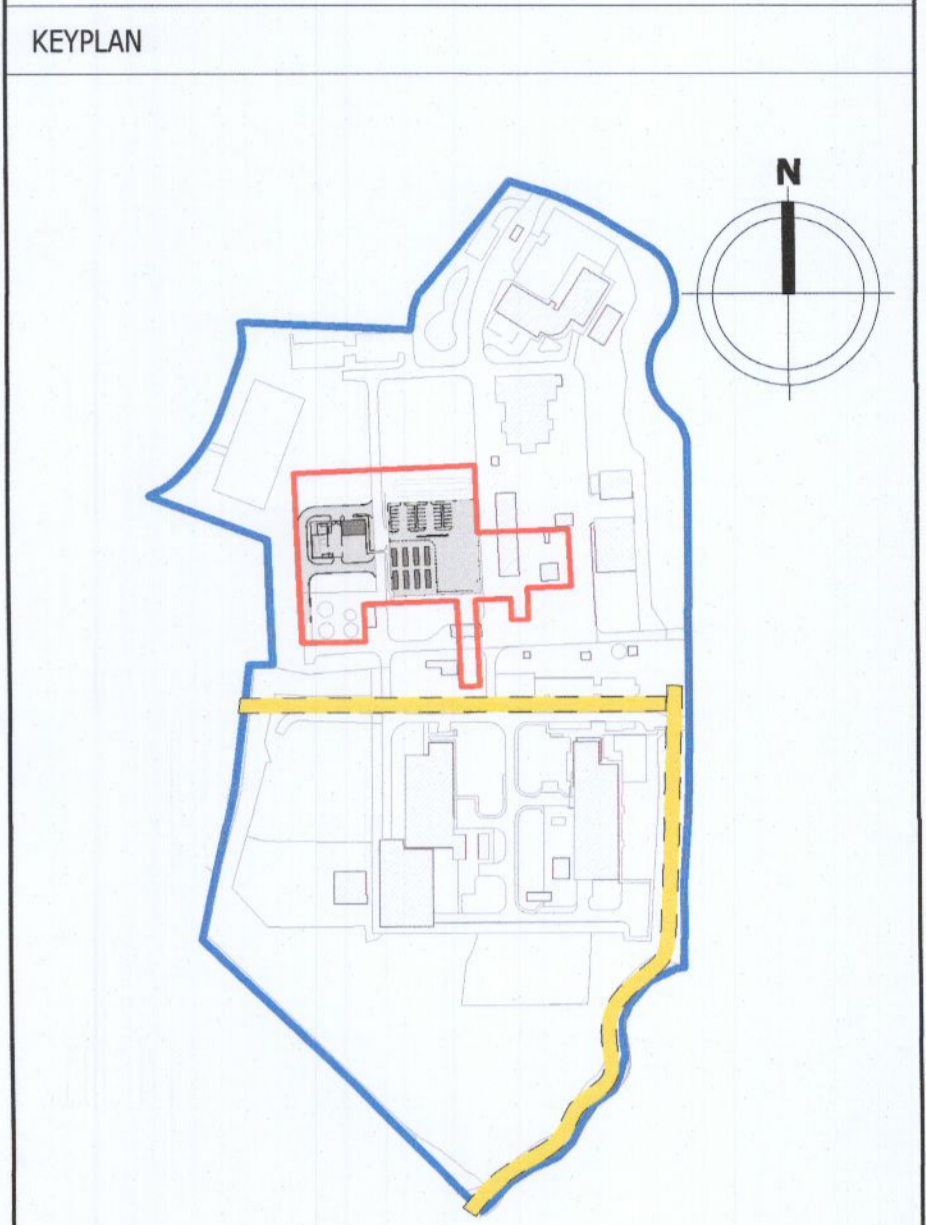

- LEGEND**
- EXISTING BUILDINGS TO BE RETAINED
 - EXISTING ACCESS ROAD
 - PROPOSED ACCESS ROAD
 - PROPOSED ILLUMINATED PEDESTRIAN ACCESS FROM ADMINISTRATION BUILDING THROUGH THE SITE TO THE PROPOSED VOC ABATEMENT SYSTEM & UTILITIES WORKSHOP
 - PROPOSED 16.5M LONG x 2.5M WIDE ARTICULATED VEHICLE AUTO TRACK
NOTE EMERGENCY VEHICLE MEASURES 10.5M x 2.3M WIDE.

B	13.JUL.22	Issued for Planning	JD	AK	AQ	EF
A	30.JUN.22	Issued for Information	JD	AK	AQ	EF
REV	DATE	DESCRIPTION	DRN	DES	CHKD	APPR
STATUS: PLANNING						

CLIENT

THIS DRAWING IS THE PROPERTY OF DPS AND SHALL NOT BE USED, REPRODUCED OR DISCLOSED TO ANYONE WITHOUT THE PRIOR WRITTEN PERMISSION OF DPS AND SHALL BE RETURNED UPON REQUEST.

PROJECT TAKEDA VOC ABATEMENT SYSTEM

TITLE EMERGENCY VEHICLE TRACKING LAYOUT

PROJECT No. A21DB035	A1 SCALE 1:500	DISCIPLINE Architecture
CLIENT DRAWING NO. 1022429	DRAWING NO. A21DB035-AE-PL-306	SHT REV B

Proposed Emergency Vehicle Tracking Layout
SCALE: 1 : 500