

NOTES:

1. This drawing is for PLANNING INFORMATION purposes only and is not intended for any other use.
2. All dimensions are approximate only.
3. All new foul drainage is to connect to the existing public foul drainage system.
4. This drawing is COPYRIGHT. No work or designs shown on this drawing shall be reproduced without written permission.

Existing area of livable space.	137sqm
Area of proposed works.	76sqm
Area of livable space after associated works.	248sqm
Existing area of Garden.	252sqm
Area of Garden after associated works.	237sqm
Total area of subjected site.	530sqm

Legend	
	Existing Construction
	Proposed Construction
	Surrounding Construction
	Site Boundary Line
	Subject to planning

NEW SURFACE WATER FROM ALL NEW ROOFS TO BE DISCHARGED TO NEW SOAKAWAY LOCATED IN REAR GARDEN DESIGNED AND APPROVED BY ENGINEER SPECIALIST CONSULTANT. ALL PAVINGS AND PATIOS WILL BE LAID ON WELL GRADED "GRIT" SAND, 2-5MM APART, WITH JOINTS FILLED WITH KILN DRIED FINE SAND. SURFACE WATER TO BE DISCHARGED LOCALLY, NO RAIN WATER WILL BE DISCHARGED TO PUBLIC SEWER. ANY INTERNAL WORKS TO COMPLY WITH CURRENT BUILDING REGULATIONS, IRISH WATER STANDARDS AND GREATER DUBLIN REGIONAL CODE OF PRACTICE FOR DRAINAGE WORKS. IT IS PROPOSED TO INSTALL NEW RAIN WATER BUTT FOR HARVESTING RAINWATER FOR GARDEN USE. EXISTING FOUL DRAINAGE SYSTEM TO BE MAINTAINED, NEW CONNECTIONS TO COMPLY WITH CURRENT BUILDING REGULATIONS

1 (Existing) SITE PLAN
1 : 200

Patrycja Rogala MRIAI

PROJECT: 6 Ballytore Road, Rathfarnham

CLIENT: Róisín Moran, Shane Delaney

TITLE: Existing Site Plan

DRAWING NUMBER: PLA-1001

M. 086 401 6627 - patrycja@progala.ie, www.progala.ie

REV:

SCALE (@ A3) As indicated

DATE: 05/26/22

PROJECT NUMBER 01

Do Not Scale - Use Figured Dimensions Only - All Dimensions Are In Millimeters - All Dimensions To Be Checked On Site - Any Discrepancies Are to be Reported To The Architect Immediately.



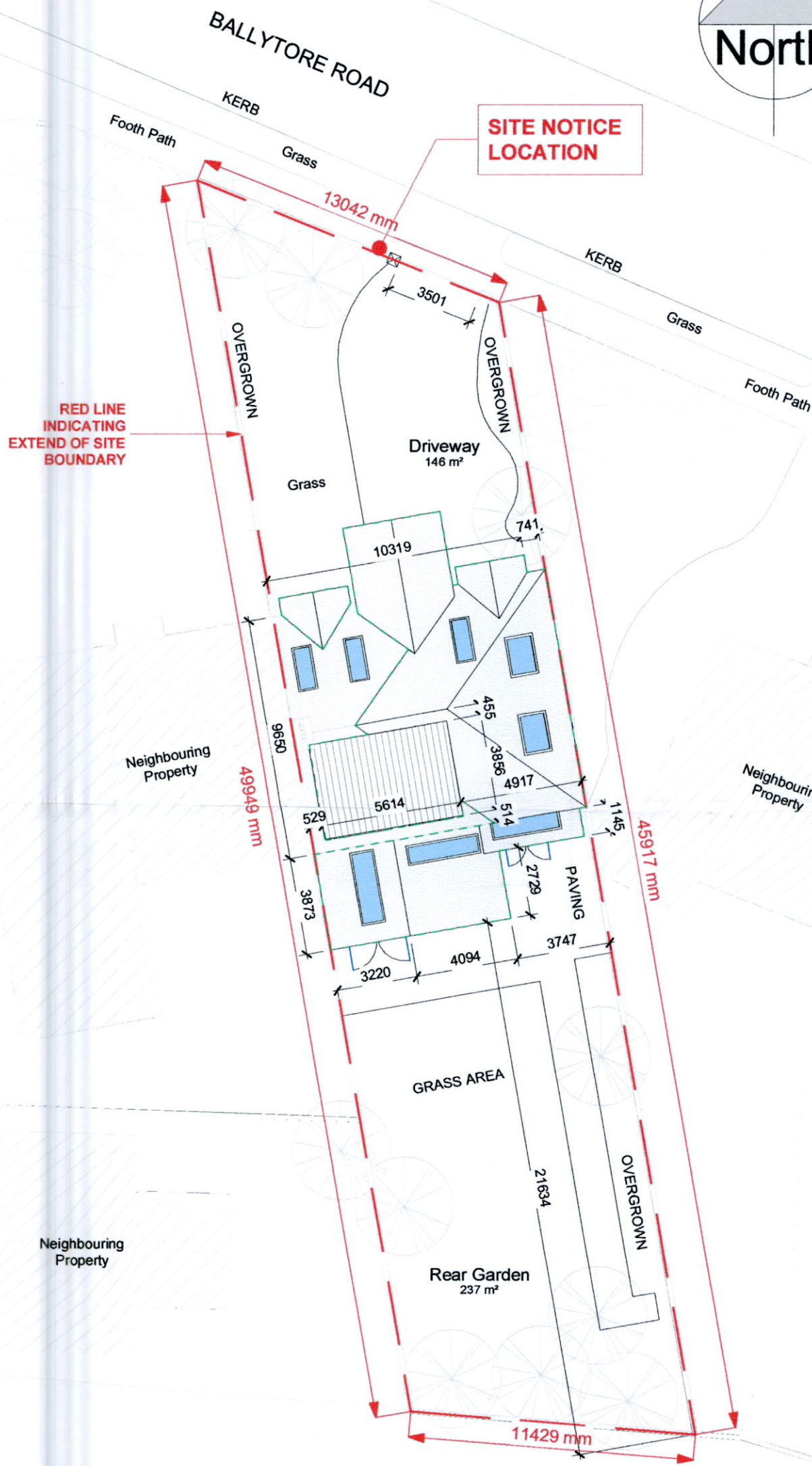
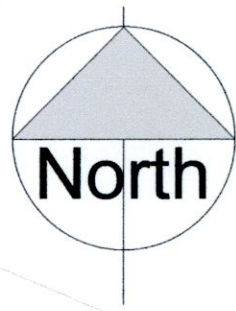

- NOTES:
1. This drawing is for PLANNING INFORMATION purposes only and is not intended for any other use.
 2. All dimensions are approximate only.
 3. All ne foul drainage is to connect to the existing public foul drainage system.
 4. This drawing is COPYRIGHT. No work or designs shown on this drawing shall be reproduced without written poerrmission.

Existing area of livable space.	137sqm
Area of proposed works.	76sqm
Area of livable space after associated works.	248sqm
Existing area of Garden.	252sqm
Area of Garden after associated works.	237sqm
Total area of subjected site.	530sqm

Legend	
	Existing Construction
	Proposed Construction
	Surrounding Construction
	Site Boundary Line
	Subject to planning

NEW SURFACE WATER FROM NEW ROOFS TO BE DISCHARGED TO NEW SOAKAWAY IN THE REAR GARDEN, SEE DRAWING 2203-2001 ALL PAVINGS AND PATIOS WILL BE LAID ON WELL GRADED "GRIT" SAND, 2-5MM APART, WITH JOINTS FILLED WITH KILN DRIED FINE SAND. SURFACE WATER TO BE DISCHARGED LOCALLY, NO RAIN WATER WILL BE DISCHARGED TO PUBLIC SEWER. ANY INTERNAL WORKS TO COMPLY WITH CURRENT BUILDING REGULATIONS, IRISH WATER STANDARDS AND GREATER DUBLIN REGIONAL CODE OF PRACTICE FOR DRAINAGE WORKS. IT IS PROPOSED TO INSTALL NEW RAIN WATER BUTT FOR HARVESTING RAINWATER FOR GARDEN USE. EXISTING FOUL DRAINAGE SYSTEM TO BE MAINTAINED, NEW CONNECTIONS TO COMPLY WITH CURRENT BUILDING REGULATIONS

1 (Proposed) SITE PLAN
1 : 200

Do Not Scale - Use Figured Dimintions Only - All Dimintions Are In Millimeters - All Dimintions To Be Checked On Site - Any Discreptencies Are to be Reported To The Architect Imidietly.

Patrycja Rogala MRIAI
PROJECT: 6 Ballytore Road, Rathfarnham
CLIENT: Róisín Moran, Shane Delaney
TITLE: Proposed Site Plan
DRAWING NUMBER: PLA-2001
M. 086 401 6627 - patrycja@progala.ie, www.progala.ie

REV:
SCALE (@ A3) As indicated
DATE: 05/26/22
PROJECT NUMBER 01

