

01 Building C - Existing Ground Floor Plan
EX 103 1:50

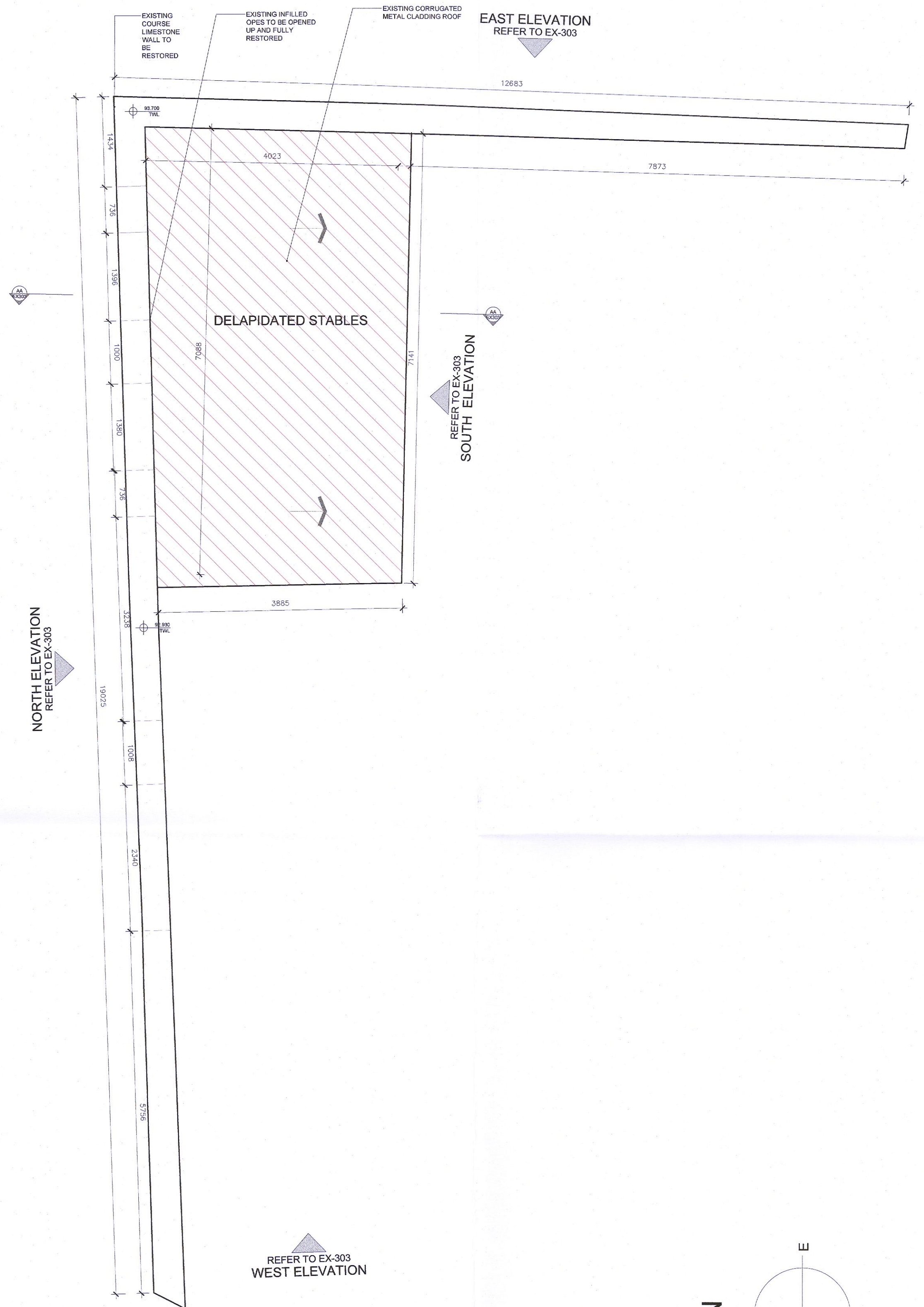

02 Building C - Existing Roof Plan
EX 103 1:50

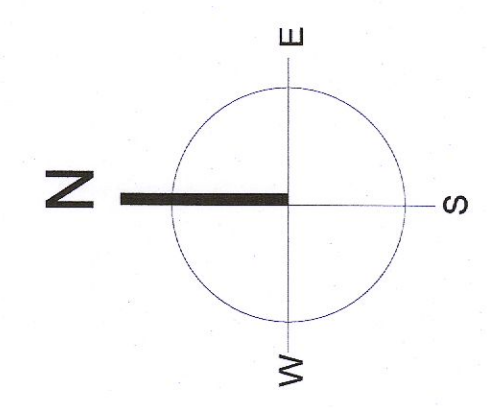

NOTES:
Do not scale from this drawing.
Any discrepancies found on site to be reported to Diarmody Architects immediately.
Any discrepancies found on drawings to be reported to Diarmody Architects immediately.
Refer to engineers drawings for structural details.
All dimensions sized to blockwork.

Rev.	Description.	Date.	Initials.

DRAWING KEY	
	Building Fabric to be Removed
	Existing Structure to be Retained

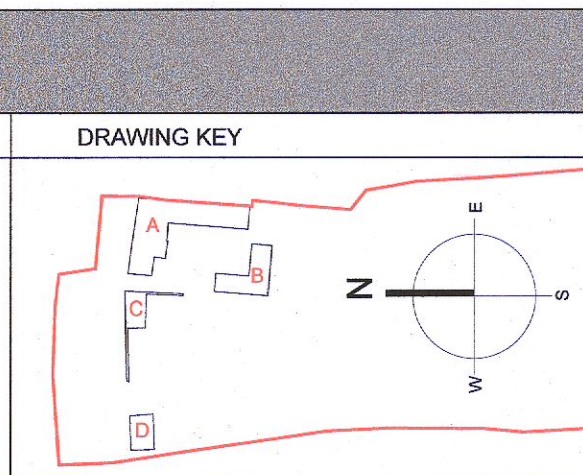
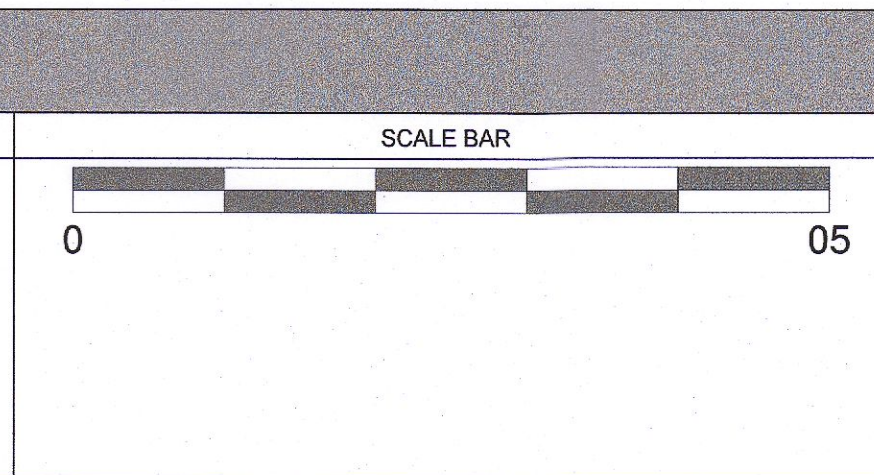

creative innovative flexible

diarmody
architecture

91 Townsend Street, Dublin 2
353 1 672 9907
info@diarmodyarchitecture.com
diarmodyarchitecture.com

Rev. No.	Scale	Date	Drn. By	Chkd. By	Issue
	1:50 @ A1	11/05/2022	Kevin Barry	Alan Ryan	PLANNING

Project:	Proposed Lidl Store at Newcastle, Co. Dublin		
Title:	Building C - Existing Plans		
Client:	Lidl Ireland GmbH		
Dwg. No.	EX-103	Job No.	22013