

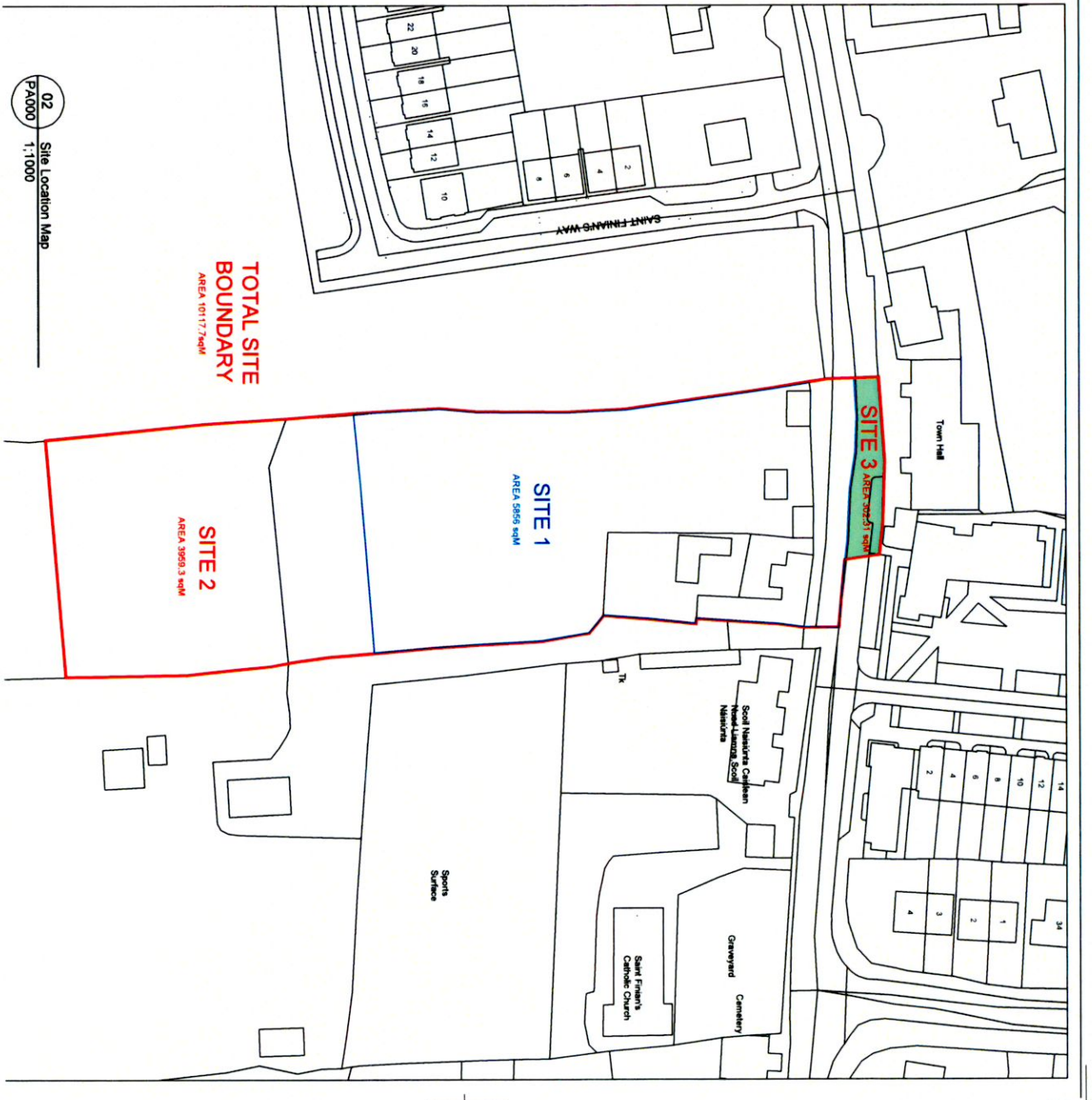

01 Local Map
PA000 1:2500

SITE 2 OWNED BY VENDOR
SITE 3 OWNED BY SOUTH DUBLIN COUNTY COUNCIL

	Area (sqm)
SITE 1	5714.88
SITE 2	3959.3
SITE 3	302.31
	9976.5



02 Site Location Map
PA000 1:1000

NOTES

Do not scale from this drawing.
This drawing is for information only and should not be used for any other purpose.
Any discrepancies found on drawings should be referred to the architect.
All dimensions stated in blackwork.

Rev.	Description	Date	Scale
1	0.3 COPYRIGHT LICENSE NO. A0809022 ORIGINATOR: ENVIRONMENTAL AND GOVERNMENT OF IRELAND THE CENTRE COORDINATES: 609796 729886		

Rev.	Description	Date	Scale
1	0.3 COPYRIGHT LICENSE NO. A0809022 ORIGINATOR: ENVIRONMENTAL AND GOVERNMENT OF IRELAND THE CENTRE COORDINATES: 609796 729886		

Rev.	Description	Date	Scale
1	0.3 COPYRIGHT LICENSE NO. A0809022 ORIGINATOR: ENVIRONMENTAL AND GOVERNMENT OF IRELAND THE CENTRE COORDINATES: 609796 729886		

Rev.	Description	Date	Scale
1	0.3 COPYRIGHT LICENSE NO. A0809022 ORIGINATOR: ENVIRONMENTAL AND GOVERNMENT OF IRELAND THE CENTRE COORDINATES: 609796 729886		

darmody
architectural

31 Townsend Street, Dublin 2
info@darmodyarchitecture.com
darmodyarchitecture.com

Scale: 1:1000
Date: 10/05/2022
Drawn by: [Name]
Checked by: [Name]

Project	Proposed Lift Store at Newcastle, Co. Dublin
Title	Site Location Map
Client	David Heffernan GmbH
Proj. No.	PA-000
Date	22/01/23

DRAFT