

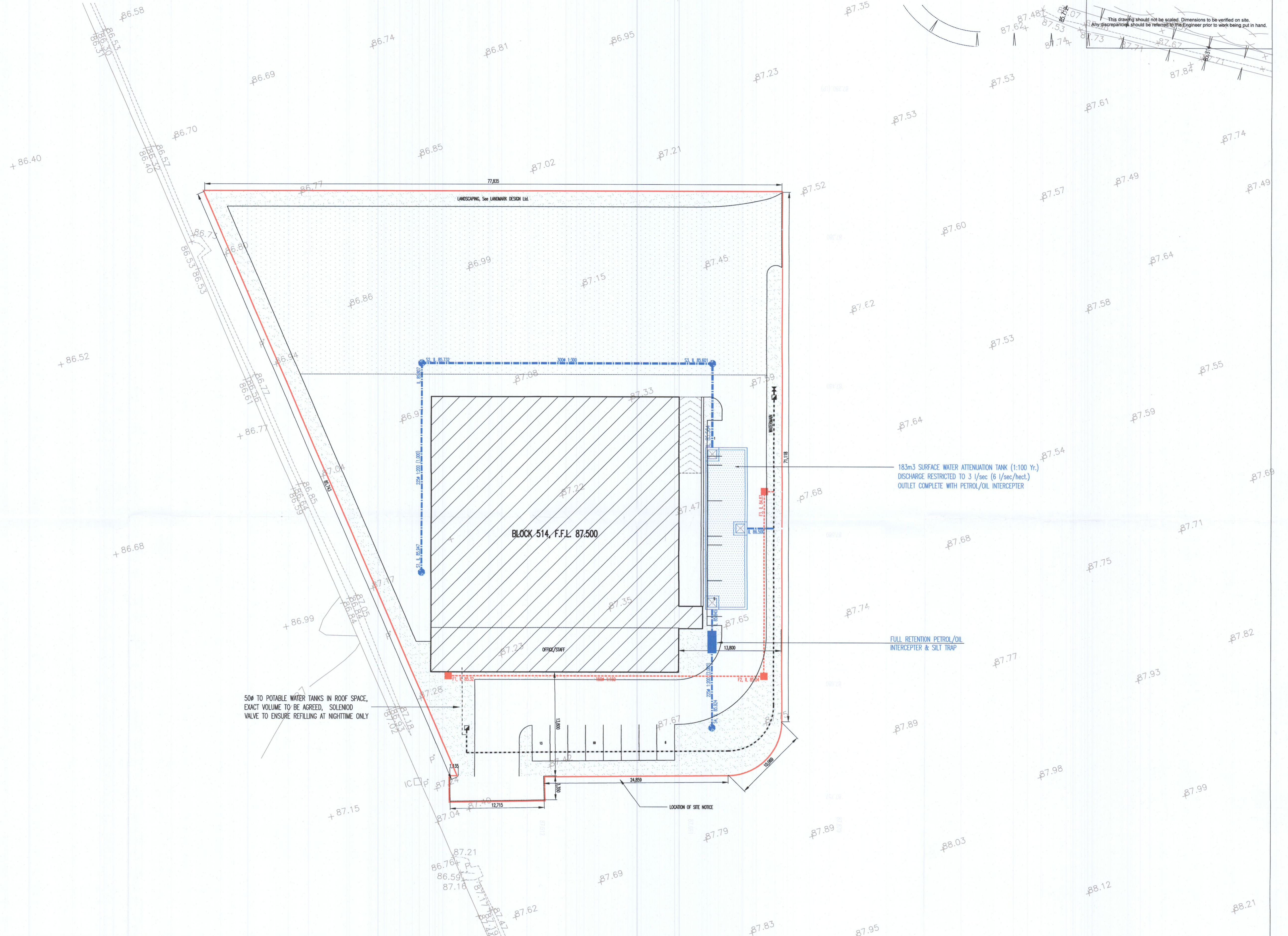

This drawing should not be scaled. Dimensions to be verified on site. Any discrepancy should be referred to the Engineer prior to work being put in hand.



ALL SITE DEVELOPMENT WORKS ABOVE AND BELOW GROUND REMAIN AS PREVIOUSLY GRANTED PERMISSION REG.REF SD05A 0281

THIS LAYOUT IS SHOWN FOR INFORMATION ONLY, SUBJECT PLANNING RETENTION APPLICATION RELATES ONLY TO ANCILLARY OFFICE FIRST FLOOR LAYOUT AS SHOWN ON DRG REF. D846-GA-01

PL2	21/06/2022	FOR RETENTION	H.T.	P.K.
Status	Date	Description	By	CHK
Amendments				

Project	Client	Title	Drawn By	KAVANAGH BURKE CONSULTING ENGINEERS Unit F3, Block F, Calmount Park Calmount Avenue, Dublin 12. D12 PX28 E-mail: reception@kavanaghburke.ie Tel: 01 450 0694
SITE 514, GREENOGUE BUSINESS PARK, RATHCOOLE, CO.DUBLIN	SITETECH PRODUCTS LTD.	SITE LAYOUT, DRAINAGE & WATERMAIN LAYOUT	H.T.	
			Designed By	
			P.K.	
			Checked By	
			P.K.	
			Scale @ A1	Project - Originator - Volume - Level - Type - Role - Number
			1:250	Revision
			Date	
			JUNE 2022	D846-KB-XX-XX-DR-S-D2
				PL2