

Planning Pack Map

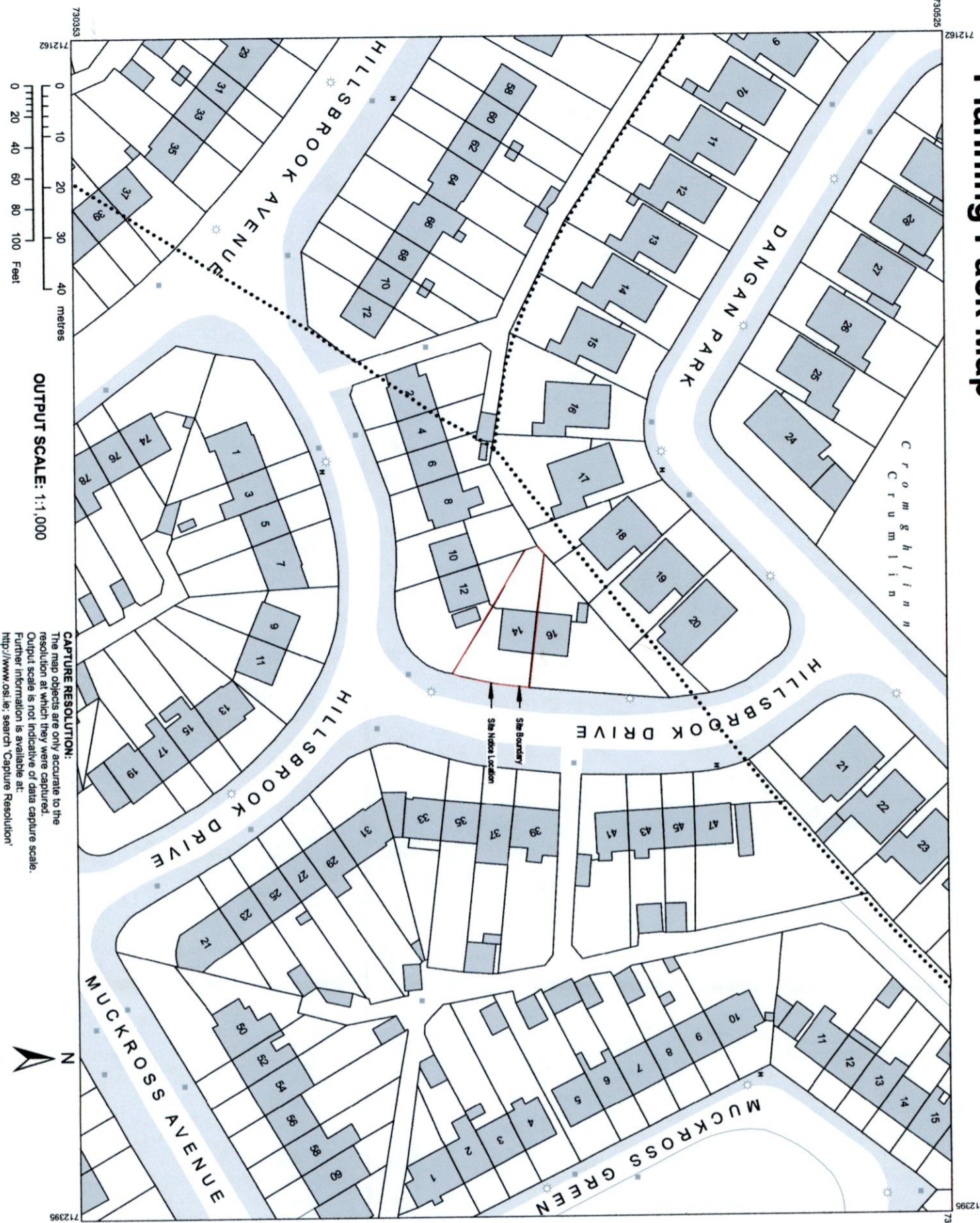

CAPTURE RESOLUTION:
The map objects are only accurate to the resolution at which they were captured. Output scale is not indicative of data capture scale. Further information is available at: <http://www.osi.ie/search/CaptureResolution>

LEGEND:
<http://www.osi.ie/search/LargeScaleLegend>



CENTRE COORDINATES:
ITM 712279,730439
PUBLISHED: 05/07/2022
ORDER NO.: 50278161_1
MAP SERIES: 1:1,000
MAP SHEETS: 3328-11

COMPILED AND PUBLISHED BY:
Ordnance Survey Ireland,
Phoenix Park,
Dublin 8,
Ireland.
Unauthorised reproduction infringes Ordnance Survey Ireland and Government of Ireland copyright.

All rights reserved.
No part of this publication may be copied, reproduced or transmitted in any form or by any means without the prior written permission of the copyright owners.

The representation on this map of a road, track or footpath is not evidence of the existence of a right of way.

Ordnance Survey maps never show legal property boundaries, nor do they show ownership of physical features.

© Suirbhreacht Ordánais Éireann, 2022
© Ordnance Survey Ireland, 2022
www.osi.ie/copyright

1 Site Location Map

1 : 1000

REF.	DATE	Revision
Peter Brennan Hayfield House, Knocklyon Road, Templeogue, Dublin 16 North Point		
PROJECT: Ground Floor Extension & Renovations_Opt 01_Rev. 03 PROJECT NO.: PRJ1122 CLIENT: David Griffin & Tara Harkness ADDRESS: 14 Hillsbrook Drive, Perrystown, Dublin 12, D12 TD82 DRAWN BY: Peter Brennan DATE: 11/07/22 SCALE: 1 : 1000 DRG. No.: P112		
DRAWING: Site Location Map DO NOT SCALE FROM DRAWING STATUS: Planning		