

**Planning
Application Notices**

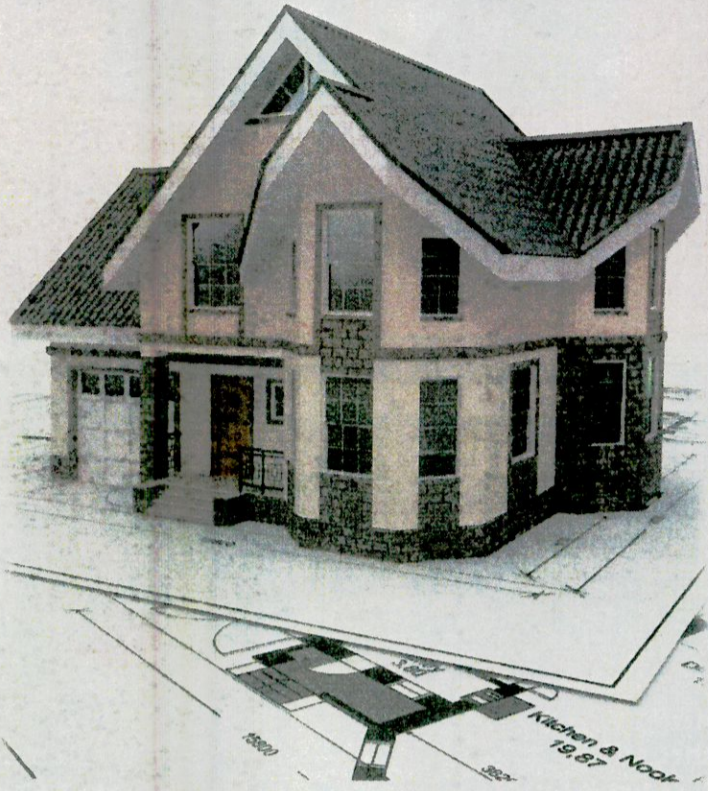

email:

planning@dublinpeople.com

**Standard Planning
Notice
From €93.45 plus
VAT**

**Deadline for submission
Friday at 12pm**

**Dublin
People**

GROUP OF NEWSPAPERS

NOTICE

Would any person having knowledge of a Will made by the following please contact me on the details below:

John Kavanagh (deceased), date of birth: 17/09/1971, died 27/07/2021, late of 342 Orwell Park Close, Templeogue, D6W (also, 89 The Crescent Bdg, Park West, D12).
Please contact Deborah Ray.
Ph: 087 974 8292.
Email: deb.ben@hotmail.com.

PLANNING DUBLIN

South Dublin County Council

Muhammad Iqbal is applying for Permission for extension and refurbishment of existing dwelling to include construction of two-storey extension to side and rear, internal alterations to existing layout, alterations to front, side and rear elevations including canopy area and roof to existing dwelling, alterations to side boundary, maintenance works, and all associated site works at 1 Rossberry Avenue, Lucan, County Dublin. This application may be inspected or purchased at a fee not exceeding the reasonable cost of making a copy, at the offices of South Dublin County Council during its public opening hours of 9am - 4pm, Mon-Fri, and a submission or observation may be made to South Dublin County Council in writing and on payment of the prescribed fee (€20.00) within the period of 5 weeks beginning on the date of receipt by South Dublin County Council of the application.

PLANNING DUBLIN

Dún Laoghaire Rathdown County Council

David Greene & Kate McManus intend to apply for planning permission for the demolition of existing single storey garage and kitchen extension to the side (32.5 m²), opening of new window at first floor level to existing front elevation and the construction of New 2 storey extension to side, single storey extension to rear and new front porch (total 69 m²), widening of vehicular entrance off the public road, provision of extended hardstand parking area to front and all associated works at 14 Cypress Road Mount Merrion Blackrock County Dublin A94 H3N8. A submission/observation may be made on payment of €20 within a period of 5 weeks from the date the application is received by the planning authority. The planning application may be inspected, or purchased at a fee not exceeding the reasonable cost of making a copy, at the offices of the Planning Authority, County Hall, Dun Laoghaire during its public opening hours. A submission/observation may be made on payment of €20 within a period of 5 weeks from the date the application is received by the planning authority, and such submissions or observations will be considered by the planning authority in making a decision on the application. The planning authority may grant permission subject to or without conditions, or may refuse to grant permission.

PLANNING DUBLIN

Dún Laoghaire Rathdown County Council

Pankaj Kumar Das & Sutapa Das Adhikari intend to apply for Planning Permission at 44 Belarmine Grove, Belarmine Woods, Stepside, Dublin 18. The development will consist of (a) - Conversion of attic space with new dormer structure and 1no. escape window at front (North East Elevation) for domestic storage and ancillary accommodation and 1no. velux rooflight at front (North East Elevation) (b) - 3no. velux rooflights at rear (South West Elevation) (c) - A flat roof single storey extension at rear (South West Elevation) containing kitchen and dining area together with associated site works. The Planning Application may be inspected or purchased at a fee not exceeding the reasonable cost of making a copy at the offices of the Planning Authority during its public opening hours and a submission or observation may be made to the Planning Authority in writing on payment of the prescribed fee within the period of 5 weeks beginning on the date of receipt by the authority of the application.

**TALK TO
DUBLIN...**

...TALK TO US

**Dublin
People**

GROUP OF NEWSPAPERS

Contact our Sales Team at

01 8621611

or Email

sales@dublinpeople.com

To advertise in the

**Education
Health Section
Motors Section
Employment
House & Home**



**Dublin
People**

GROUP OF NEWSPAPERS

CONTACT OUR

Sales Team

T:01 8621611

F: 01 8621625

sales@dublinpeople.com