

UNIT 2 - SECOND FLOOR PLAN
SCALE: 1:200

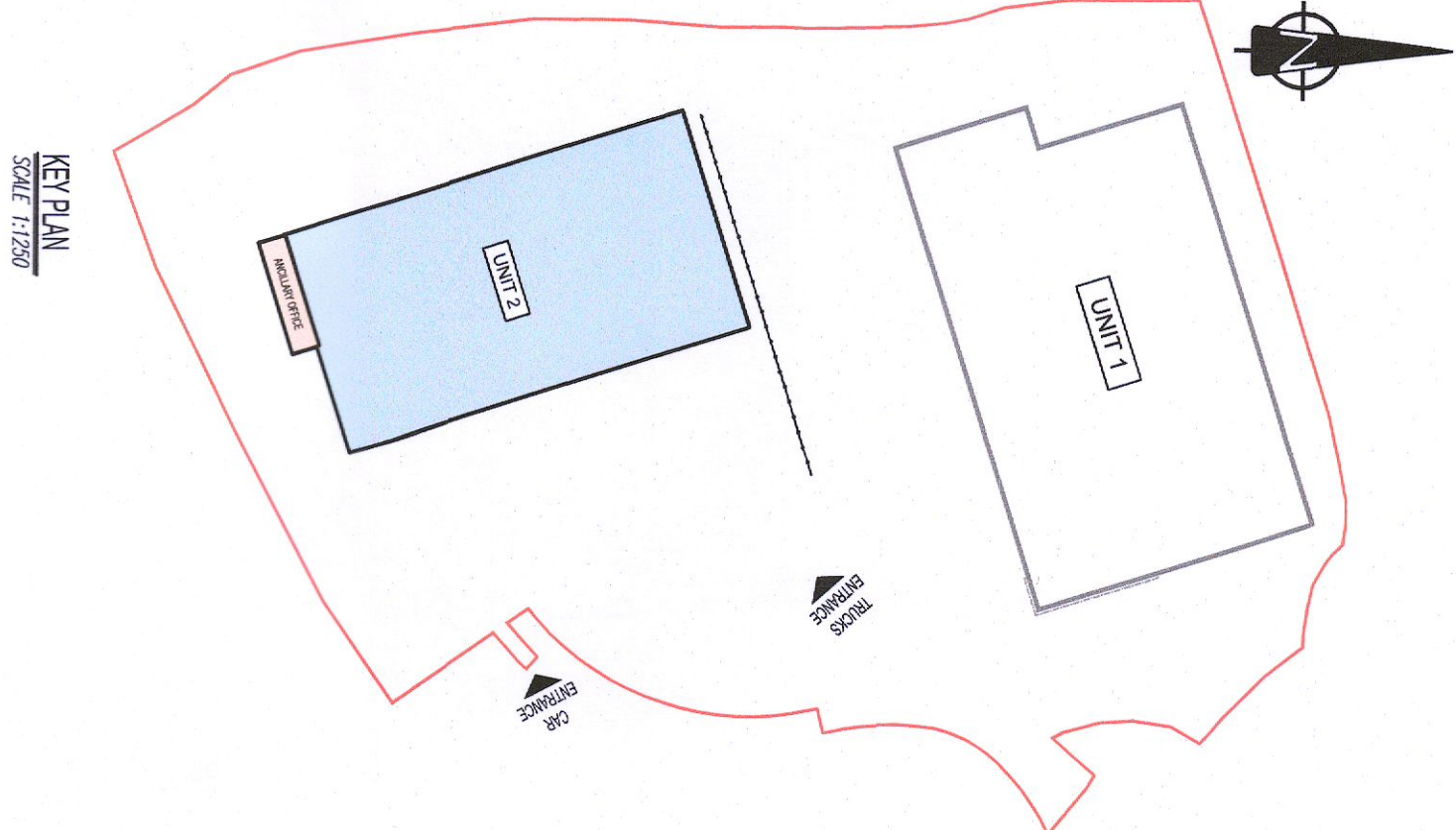

KEY PLAN
SCALE: 1:750

- ALTERATIONS DESCRIPTION:**
- Alterations to Unit 2 are as follows:
 - Omission of warehouse office/staff facilities block at the south-east & north-west corner of the warehouse resulting in a reduction of 100m² of office floor area to warehouse floor area and change of use of 76m² of staff facilities floor area to warehouse floor area on the ground floor.
 - Addition of a 2.4m high perimeter blockwork wall internally within the warehouse area, resulting in a warehouse floor area reduction of 63m².
 - Alteration to the ancillary office/staff facilities block resulting in:
 - reduction of 100m² of office floor area and addition of 112m² of staff facilities floor area on ground floor plan.
 - reduction of 104m² of office floor area & 52 m² of staff facilities floor area over 1st & 2nd floor plan.
 - Elevation changes:
 - Removal of 2 no. level doors and addition of 6 no. dock level doors & associated canopy to the building's north-eastern elevation.

TABLE OF GROSS INTERNAL FLOOR AREAS & USES AS PREVIOUSLY GRANTED UNDER REF: REF: S027A010182

UNIT 2	OFFICE	STAFF FACILITIES	WAREHOUSE	TOTAL PROP.
GROUND FLOOR	141	224m ²	5326m ²	5489m ²
1ST FLOOR	155m ²	94m ²	5426m ²	5675m ²
2ND FLOOR	155m ²	69m ²	—	224m ²
TOTAL	451m ²	447m ²	5326m ²	6224m ²

TABLE OF GROSS INTERNAL FLOOR AREAS & USES FOR THIS PLANNING APPLICATION

UNIT 2	OFFICE	STAFF FACILITIES	WAREHOUSE	TOTAL PROP.
GROUND FLOOR	131	139m ²	5206m ²	5476m ²
1ST FLOOR	131m ²	60m ²	—	211m ²
2ND FLOOR	131m ²	89m ²	—	211m ²
TOTAL	393m ²	267m ²	5206m ²	5866m ²

WAREHOUSE DEVELOPMENT AT BROWNSBARIN, CITYWEST CAMPUS, DUBLIN 24

UNIT 2 SECOND FLOOR PLAN

PLANNING ALTERATION

ISSUED FOR PLANNING ALTERATION
DATE: 15/01/2022
SCALE: 1:200

KAVANAGH BURKE CONSULTING ENGINEERS
01 - 450 0804 Unit C3, Calmount Park, Ballymount, Dublin 12.
Email: pkavanagh@kavanaghburke.ie

Author: PK
Checked: PK
Date: 13/01/2022

Project No: D1678
Drawing No: GAA-2-03
Rev: P19