

ATTENTION: ESCORTS
 1. Attention to Unit 1 are as follows:
 due to:
 A. change of use of 63m² of warehouse floor area to office floor area
 B. change of use of 91m² of warehouse floor to staff facilities floor area on the ground floor plan, and
 C. the remainder due to the addition of a 2.4m high perimeter blockwork wall in the warehouse area.
 2. Change of use of 14m² of staff facilities floor area to office floor area at the ancillary office ground floor plan.
 3. Change of use of 14 m² of office floor area to staff facilities floor area over 1st & 2nd floor plan.
 4. Reduction of 28 m² of office over 1st and 2nd floor plan to facilitate
 5. Minor internal alterations to the ancillary staff facilities/office layout with no area alterations.
 6. Elevational changes:
 A. Omission of 5 no. dock levelers & associated canopy and addition of 1 no. fire escape door to the building's southern elevation.
 B. Addition of 2 no. fire escape doors to the building's northern elevation.

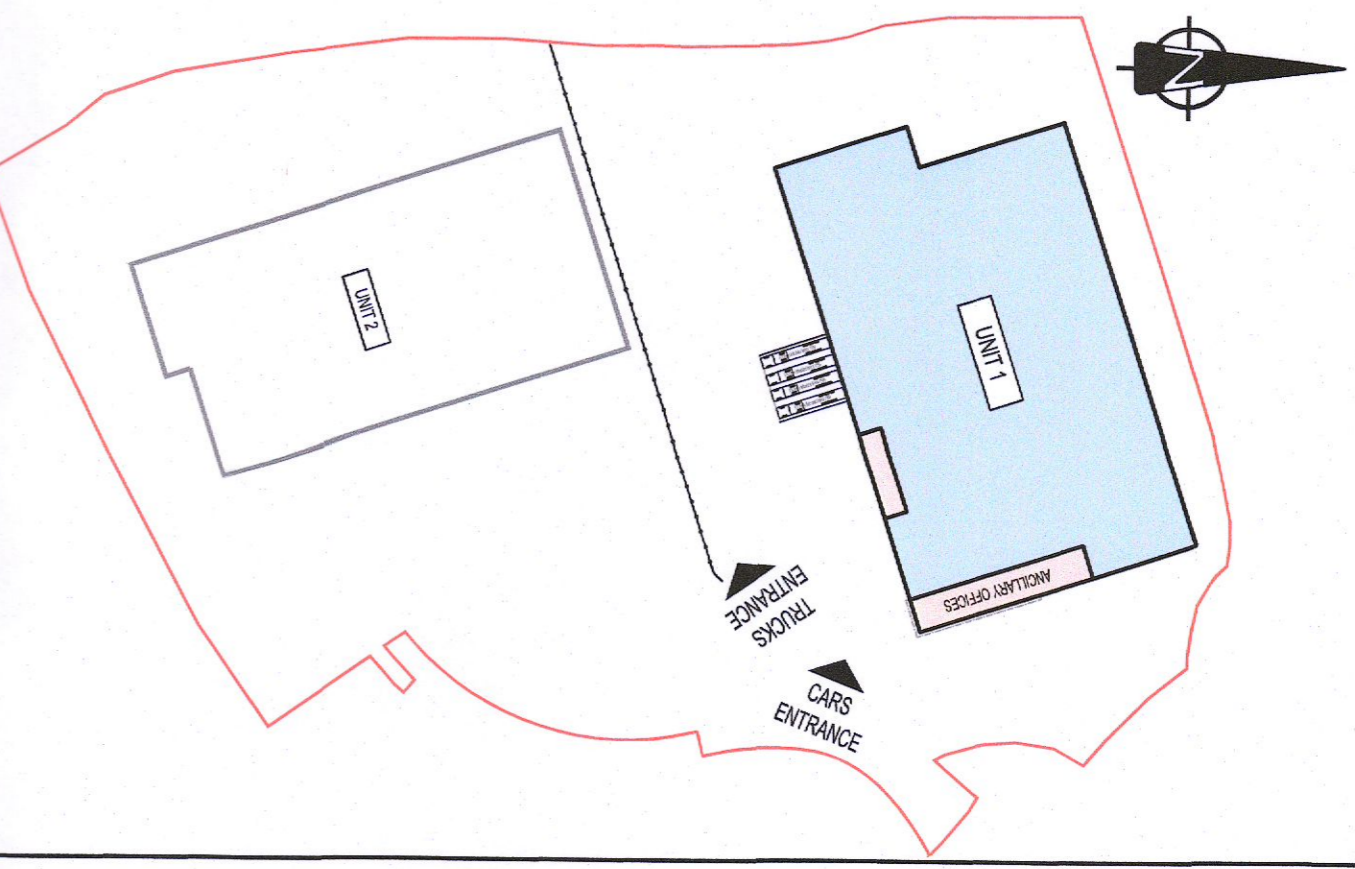

- NOTES:**
1. THIS DRAWING IS TO BE READ IN CONJUNCTION WITH ALL OTHER RELEVANT DRAWINGS & SPECIFICATIONS.
 2. DO NOT SCALE. USE FIGURED DIMENSIONS ONLY.

TABLE OF GROSS INTERNAL FLOOR AREAS & USES AS PREVIOUSLY GRANTED UNDER REF. NO. SPT24/0152

UNIT	OFFICE	STAFF FACILITIES	WAREHOUSE	TOTAL PROP.
GROUND FLOOR	71 m ²	33 m ²	5,376 m ²	7,140 m ²
1 ST FLOOR	181 m ²	74 m ²	2,963 m ²	3,118 m ²
2 ND FLOOR	181 m ²	74 m ²	2,963 m ²	3,118 m ²
TOTAL	433 m ²	181 m ²	11,302 m ²	12,916 m ²

TABLE OF GROSS INTERNAL FLOOR AREAS & USES FOR THIS PLANNING APPLICATION

UNIT	OFFICE	STAFF FACILITIES	WAREHOUSE	TOTAL PROP.
GROUND FLOOR	71 m ²	33 m ²	5,376 m ²	7,140 m ²
1 ST FLOOR	181 m ²	74 m ²	2,963 m ²	3,118 m ²
2 ND FLOOR	181 m ²	74 m ²	2,963 m ²	3,118 m ²
TOTAL	433 m ²	181 m ²	11,302 m ²	12,916 m ²

PLANNING ALTERATION

WAREHOUSE DEVELOPMENT AT BROWNSBAR, CITYWEST CAMPUS, DUBLIN 24

Unit 1
 SECOND FLOOR PLAN

Prepared by: Eker Ireland Property IV B Limited

KAVANAGH BURKE CONSULTING ENGINEERS

Tel: 01 - 459 0894 Unit C5, Clonmont Pk.
 Fax: 01 - 428 4340 Ballymount, Dublin 12.
 Email: kavanagh@kavanaghburke.com

Drawn by: [Name] Date: [Date]
 Checked by: [Name] Date: [Date]

Project No: GA-1-103 Rev: P14 Date: JULY 2022

UNIT 1 - SECOND FLOOR PLAN
 SCALE: 1:200