

Location of
Site Notice

Woodstown Park

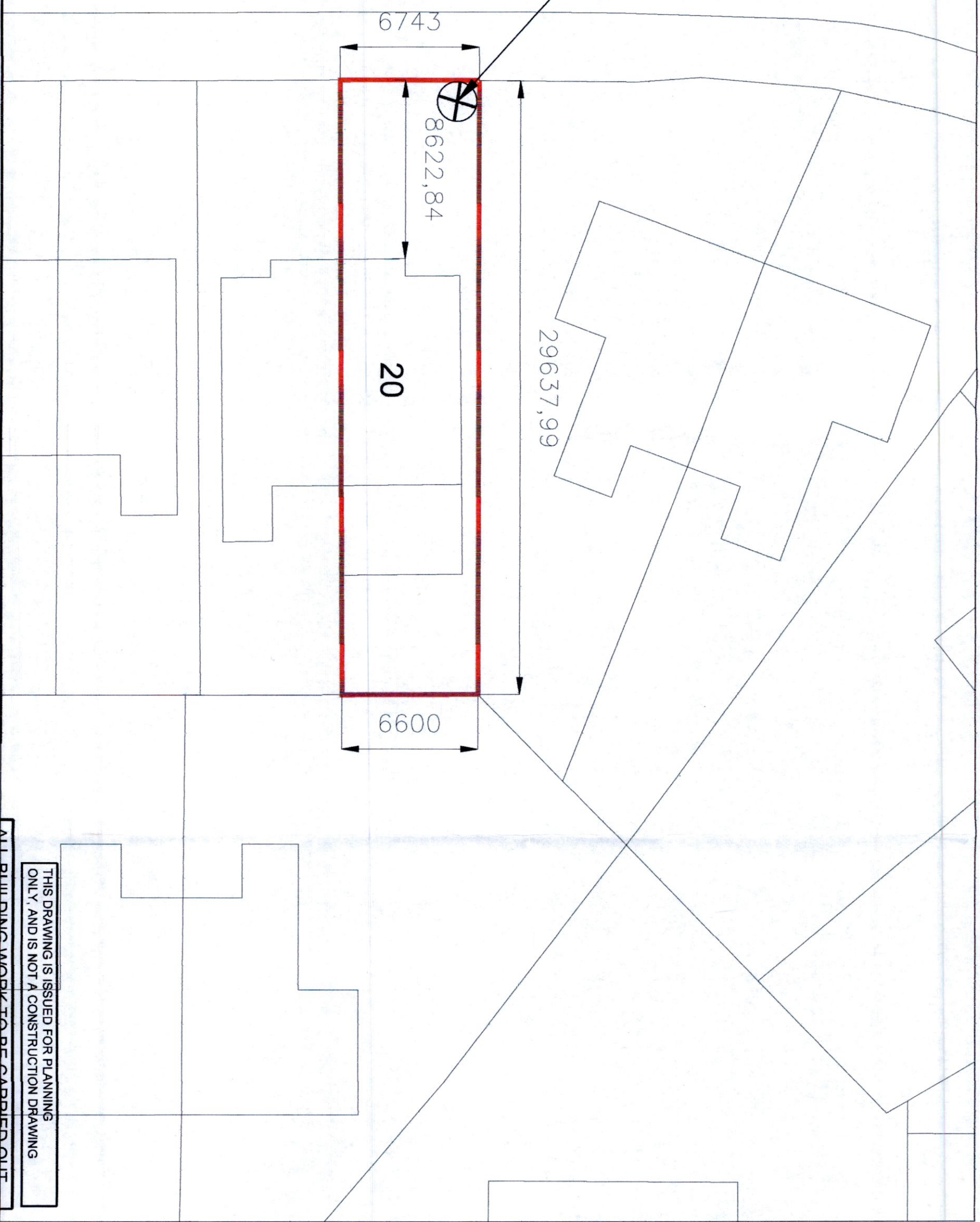

PL1	Issued For Planning	JW	JW	June 2022
REV:	REVISION TITLE:	DRW:	CHD:	DATE:

APPLICANT:
Earl & Moigan Keogh

Jason Walsh
Architectural & Engineering
12 ARD MOR CRESCENT
TALLAGHT
DUBLIN 24
PHONE: 085 8070 432
EMAIL: G.JL.SERVICES@GMAIL.COM

Proposed Front Extension & Retention Of Vehicular Entrance At,
20 Woodstown Park,
Knocklyon,
Dublin 16.

DRAWING TITLE:
Existing Site Layout

SCALE:	1:200	INTWLS:	JW	DATE:	15.06.2022
JOB No:	EMK-22	DRAWING No:	EMK-22-01	REV:	PL1

THIS DRAWING IS ISSUED FOR PLANNING ONLY, AND IS NOT A CONSTRUCTION DRAWING

ALL BUILDING WORK TO BE CARRIED OUT IN ACCORDANCE WITH ENGINEERS DETAILS & CURRENT BUILDING REGULATIONS

CONTRACTORS MUST VERIFY ALL DIMENSIONS ON SITE BEFORE COMMENCING ANY WORK. NO WORKING DIMENSIONS TO BE SCALED. DIMENSIONS TO BLOCKWORK ONLY. THIS DRAWING AND DESIGN IS COPYRIGHT AND IS THE PROPERTY OF JASON WALSH.