

REV.	DATE	BY	DESCRIPTION

Contractors must verify all dimensions at the job site before commencing any work. No working dimensions to be scaled. Dimensions to blockwork only. This drawing is copyright. Drawing provided for planning purposes ONLY.

Planning Pack Map

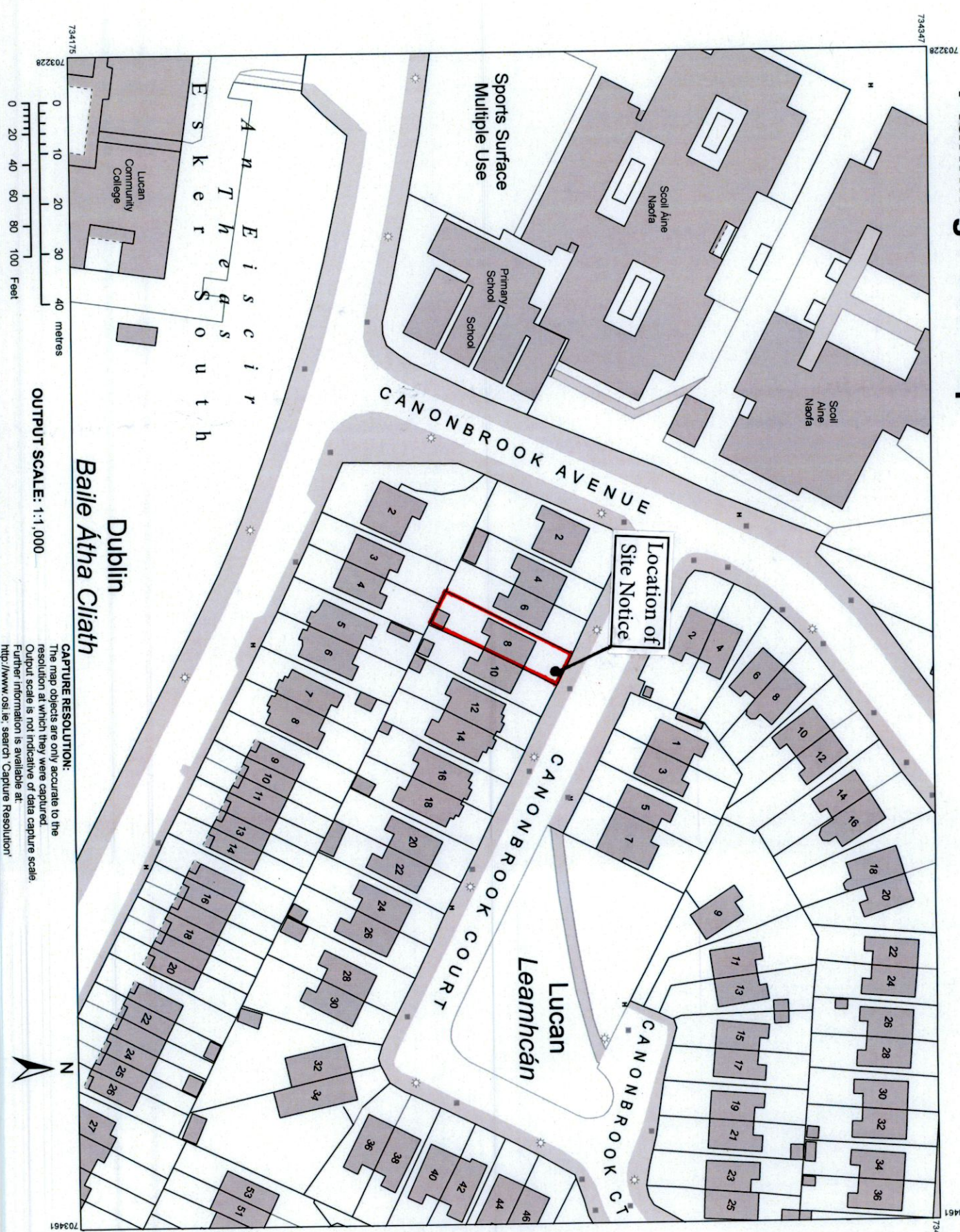

Ordnance Survey Ireland
National Mapping Agency
 CENTRE COORDINATES:
 LTM 703345, 734261
 PUBLISHED: 21/06/2022
 ORDER NO.: 50275560_1
 MAP SERIES: 1:1,000
 MAP SHEETS: 3260-10

COMPILED AND PUBLISHED BY:
 Ordnance Survey Ireland,
 Phoenix Park,
 Dublin 8,
 Ireland.

Unauthorised reproduction infringes Ordnance Survey Ireland and Government of Ireland copyright.
 All rights reserved.
 No part of this publication may be copied, reproduced or transmitted in any form, or by any means without the prior written permission of the copyright owners.

The representation on this map of a road, track or footpath is not evidence of the existence of a right of way.
 Ordnance Survey maps never show legal property boundaries, nor do they show ownership of physical features.

© Surbheireacht Ordánais Éireann, 2022
 © Ordnance Survey Ireland, 2022
 www.osi.ie/copyright

LEGEND:
<http://www.osi.ie>
 search 'Large Scale Legend'

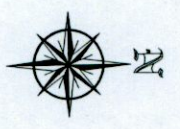

PROJECT DETAILS:
 CONVERSION OF EXISTING ATTIC SPACE COMPRISING OF A MODIFICATION OF EXISTING ROOF STRUCTURE, RAISING OF EXISTING GABLE WALL TO INCLUDE NEW WINDOW AT ATTIC LEVEL, AND BUTCH HIP ADDING A NEW INTERNAL ACCESS STAIRS AND FLAT DORMER TO REAR.

CLIENT:
 JIMMY SHERIDAN
PROJECT:
 8 CANONBROOK COURT,
 GLEBE, LUCAN, CO. DUBLIN

DRAWING TITLE:
 SITE LOCATION MAP

ALL BUILDING WORK TO BE CARRIED OUT IN ACCORDANCE WITH ENGINEERS DETAILS AND CURRENT BUILDING REGULATIONS THIS DRAWING ISSUED FOR PLANNING PERMISSION ONLY

SCALE: 1:1000 @A3
DATE: 26.05.22
DRAWING NO.: 100
DRAWN BY: JL

SITE LOCATION MAP

SCALE 1:1000

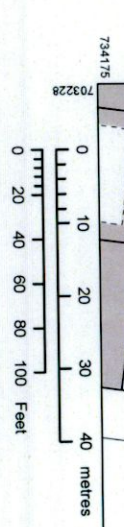

OUTPUT SCALE: 1:1,000

CAPTURE RESOLUTION:
 The map objects are only accurate to the resolution at which they were captured. Output scale is not indicative of data capture scale. Further information is available at: <http://www.osi.ie>; search 'Capture Resolution'