



Platform



### GENERAL NOTES

- DO NOT SCALE THIS DRAWING. WORK ONLY TO FIGURED DIMENSIONS.
- FOR ALL RELEVANT NOTES, REFER TO STRUCTURAL AND CIVIL ENGINEERING PERFORMANCE SPECIFICATION.
- ANY DISCREPANCIES ARE TO BE REPORTED TO PINNACLE CONSULTING ENGINEERS IMMEDIATELY.
- THIS DRAWING IS TO BE READ IN CONJUNCTION WITH ALL OTHER RELEVANT ENGINEERS, ARCHITECTS AND SUB-CONTRACTORS DRAWINGS AND DETAILS.

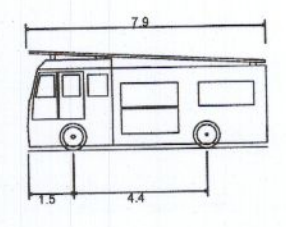

Pumping Appliance	7.900m
Overall Length	2.500m
Overall Width	3.300m
Min Body Ground Clearance	0.140m
Track Width	2.500m
Lock-to-lock time	4.00s
Curb to Curb Turning Radius	7.750m

**DESIGN ISSUE**  
 AREA SHOWN FOR SOUTH LINK ROAD PERMITTED UNDER REG. REF. SDZ20A/0021. EXCLUDED FROM THIS PLANNING APPLICATION.  
 INFRASTRUCTURE FOR PROPOSED DEVELOPMENTS WILL CONNECT IN TO SOUTH LINK ROAD INFRASTRUCTURE (REG. REF. SDZ20A/0021)

AREA OF SOUTH LINK ROAD EXCLUDED FROM APPLICATION

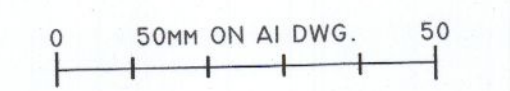

P03	UPDATED LAYOUT	RK	RK	02/06/22
P02	UPDATED LAYOUT	RK	RK	12/05/22
REV	DESCRIPTION	BY	CHK	DATE

CLIENT  
**KELLAND HOMES LTD**

PROJECT  
**CLONBURRIS**

DRAWING TITLE  
**AUTOTRACK LAYOUT - FIRE TEDNER**

**PINNACLE**  
 CONSULTING ENGINEERS

GROSVENOR COURT,  
 67A PATRICK STREET,  
 DUN LAOGHAIRE,  
 COUNTY DUBLIN  
 IRELAND.  
 TELEPHONE: +353 1231 1041  
 WELWYN GARDEN CITY | NORWICH | LONDON | THE HAGUE

DRAWING STATUS			
<b>PLANNING</b>			
SCALE @ A1	DATE	DRAWN BY	CHECKED
1:200	APRIL '22	RK	RK
DRG NO.	REVISION		
P200306-PIN-XX-DR-D-D-0010-SI	P03		
COPYRIGHT PINNACLE			

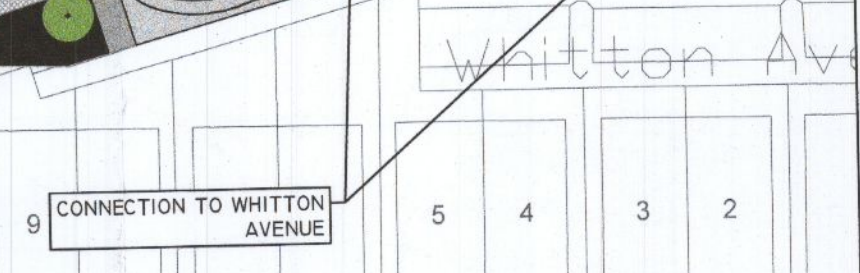
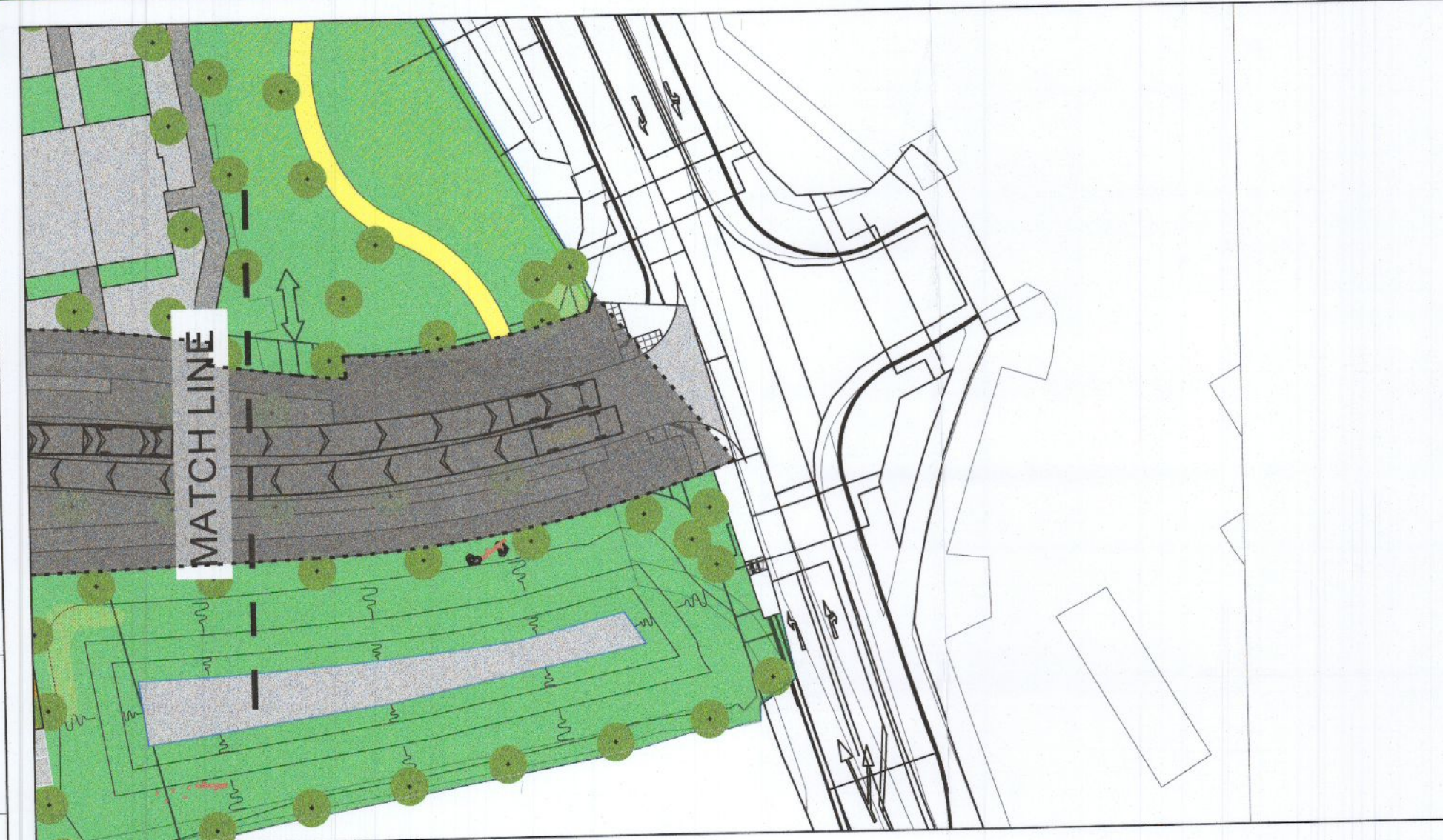

59 60 61 62 63 64 65 66 67 68 69 70 71