

Do not scale - Use figure dimensions only - All dimensions are in millimeters - All dimensions to be checked on site - Any discrepancies are to be reported immediately to the Engineer. No part of this drawing may be reproduced or transmitted in any form or stored in any retrieval system of any nature without the written permission of the Engineer. The Engineer's liability is limited to the design and for use on the project for which the document was originally issued.

- LEGEND:**
- SITE BOUNDARY SUBJECT OF THIS PLANNING APPLICATION
 - - - OUTLINE OF TESCO RETAIL STORE ABOVE CAR PARK AREA
 - LANDS IN OWNERSHIP OF TESCO IRELAND LTD.
 - - - REFER TO SITE LOCATION MAPS FOR FULL EXTENT.

OVERALL SITE LAYOUT

SCALE 1:500 @ A3

rev.	date	issued for	description	MT	KL
A	26/05/22	Planning			

CLIENT NAME Elaine Mulqueen
PROJECT TITLE Proposed Medical Centre
LOCATION Unit 1B - Tesco Extra, Liffey Valley
DRAWING TITLE Overall Site Layout
DRAWN BY MT **CHKD BY** KL **STATUS** Planning
DATE 26/05/22 **SCALE** 1:500 @ A3
DRG. No. S1534-A-002 **REV.** A

LOSCHER MORAN
 DESIGN PRACTICE
 Address: Providence House, Binnahartree Corporate Park, D15.
 Tel: 01-5179599 Email: info@lmp.ie Web: www.lmp.ie

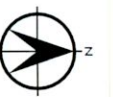

A1 A B C D E F

7500 5600 16100 16100 16100

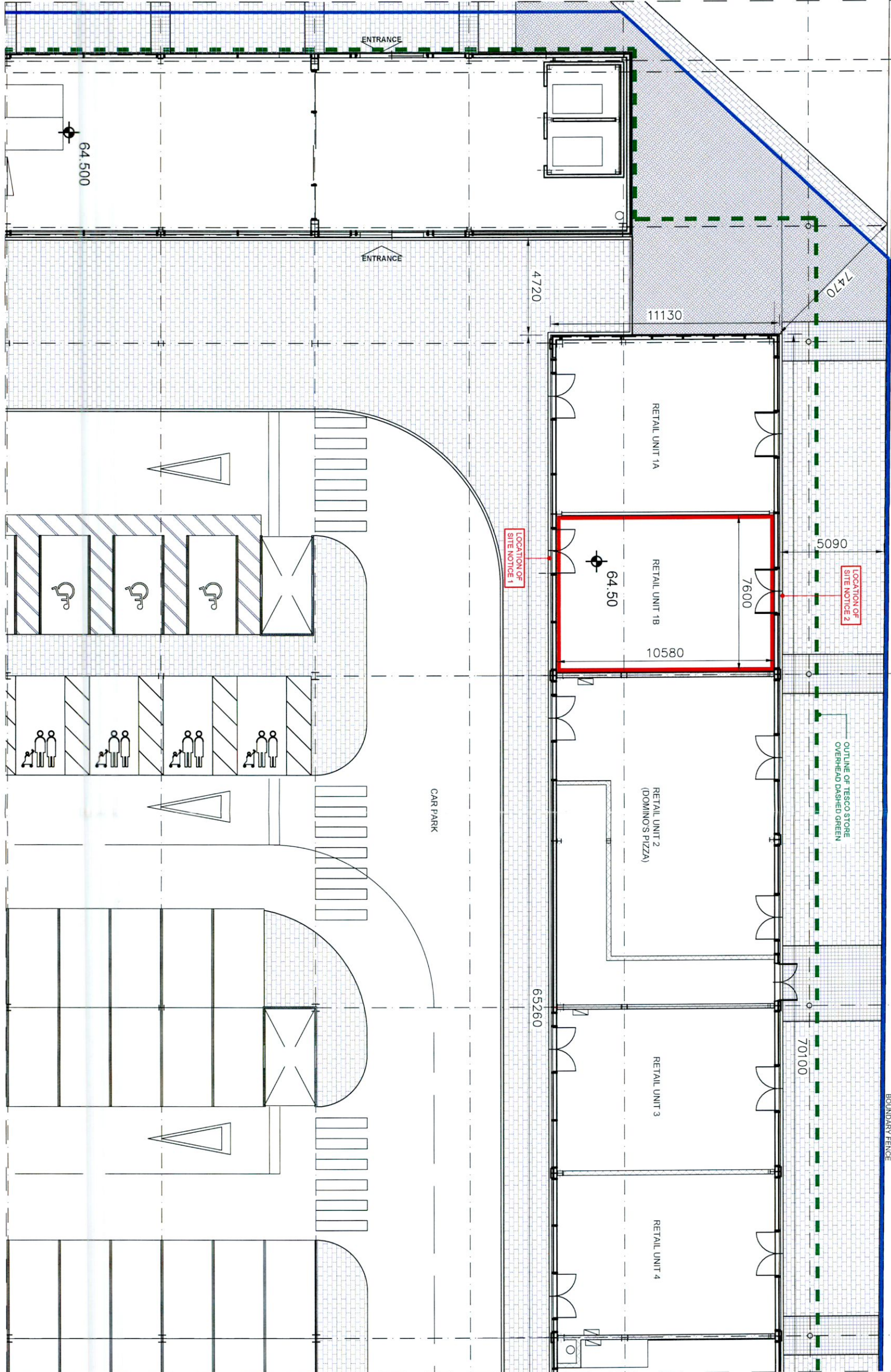

SITE PLAN
SCALE 1:200 @ A3

Do not scale - Use figured dimensions only - All dimensions are in millimetres - Dimensions are rounded to the nearest millimetre. Any dimensions are to be reported immediately to the Engineer. No part of this drawing may be reproduced or transmitted in any form or stored in any retrieval system of any nature without the written permission of Loscher Moran Consulting Engineers or its employees, except as agreed with the Client. The Client acknowledges that the drawings are a copyright of Loscher Moran Consulting Engineers and shall remain the property of Loscher Moran Consulting Engineers.

NOTES:

- SITE BOUNDARY SUBJECT OF THIS PLANNING APPLICATION
- OUTLINE OF TESCO RETAIL STORE ABOVE CAR PARK AREA
- - - - - OUTLINE OF TESCO STORE OVERHEAD DASHED GREEN
- LANDS IN POSSESSION OF TESCO RETAIL UNIT LTD. REFER TO SITE LOCATION MAPS FOR FULL EXTENT.

rev.	date	description	MT	KL
A	26.05.22	Issued for Planning	MT	KL

LOSCHER MORAN
DESIGN PRACTICE

Address: Providence House, Blanchardstown Corporate Park, D15.
Tel: 01372999 Email: info@lmo.ie Web: www.lmo.ie

CLIENT NAME: Elaine Mulqueen

PROJECT TITLE: Proposed Medical Centre

LOCATION: Unit 1B - Tesco Extra, Liffey Valley

DRAWING TITLE: Site Plan

DRAWN BY: MT CHKD BY: KL STATUS: Planning

DATE: 26.05.22 SCALE: 1:200 @ A3

DRG. No. S1534-A-003 REV. A