

SECOND FLOOR PLAN
SCALE 1:200

TABLE OF GROSS INTERNAL FLOOR AREAS & USES:

	WAREHOUSE	ANGULARY STAFF FACILITIES	ANGULARY OFFICE	TOTAL
GROUND FLOOR	10,604 m ² 114,141 sq.ft.	277m ² 2,981 sq.ft.	122 m ² 1,313 sq.ft.	11,003 m ² 118,436 sq.ft.
1ST FLOOR	-	111 m ² 1,195 sq.ft.	233 m ² 2,503 sq.ft.	344 m ² 3,703 sq.ft.
2ND FLOOR	-	111 m ² 1,195 sq.ft.	233 m ² 2,503 sq.ft.	344 m ² 3,703 sq.ft.
TOTAL	10,604 m ² 114,141 sq.ft.	489 m ² 5,271 sq.ft.	588 m ² 6,323 sq.ft.	11,681 m ² 125,667 sq.ft.

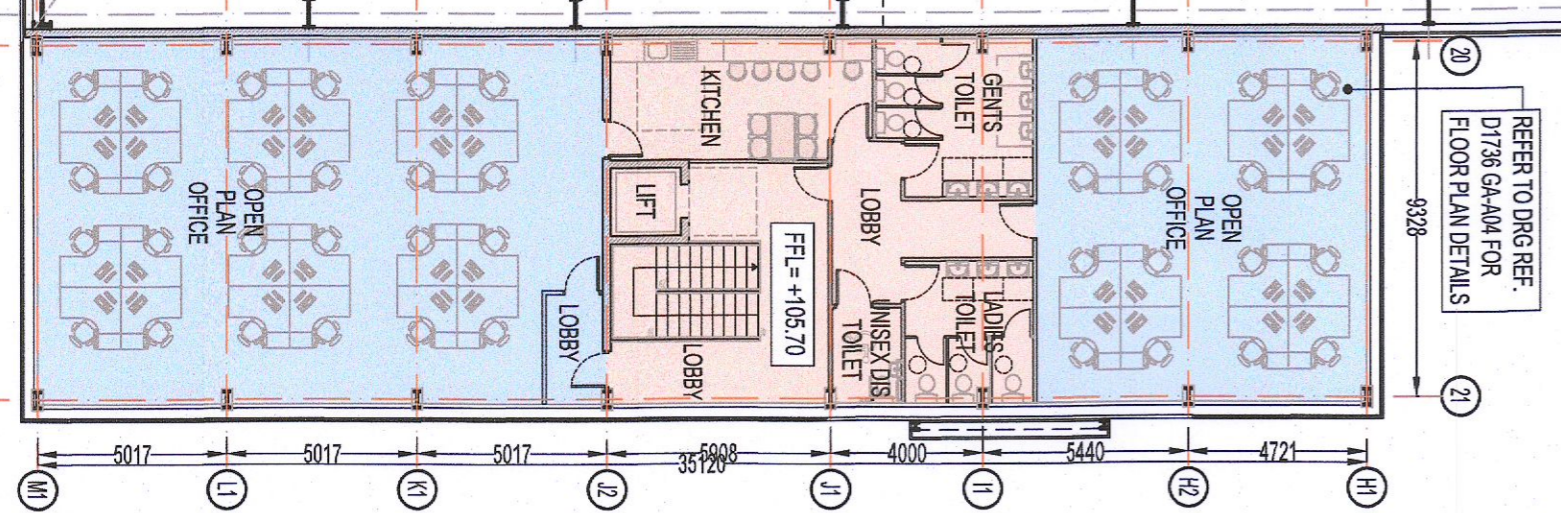

REV.	DATE	BY	CHK	ISSUED FOR PLANNING	STATUS
1					
2					
3					
4					
5					
6					
7					
8					
9					
10					
11					
12					
13					
14					
15					
16					
17					
18					
19					
20					
21					
22					
23					
24					
25					
26					
27					
28					
29					
30					
31					
32					
33					
34					
35					
36					
37					
38					
39					
40					
41					
42					
43					
44					
45					
46					
47					
48					
49					
50					
51					
52					
53					
54					
55					
56					
57					
58					
59					
60					
61					
62					
63					
64					
65					
66					
67					
68					
69					
70					
71					
72					
73					
74					
75					
76					
77					
78					
79					
80					
81					
82					
83					
84					
85					
86					
87					
88					
89					
90					
91					
92					
93					
94					
95					
96					
97					
98					
99					
100					

WAREHOUSE DEVELOPMENT AT
KINGSWOOD ROAD,
CITYWEST BUSINESS PARK,
Co. DUBLIN

SECOND FLOOR PLAN
 Drawing No.

ROCKFACE DEVELOPMENTS LTD.
KAVANAGH BURKE
CONSULTING ENGINEERS

Tel. 01-450 0654
 Fax. 01-450 4340
 Email: planning@kavanaghburke.ie

Unit F3 Carron Park
 Ballymount
 Dublin 12

Date: 12/01/11
 Scale: 1:200 @ A1
 Drawn By: PK
 Checked By: PK
 Issue: FEB 2012

D1736
 GA-A03
 P11