

L00: PODIUM + LEVEL 01
'HARD' LANDSCAPE MATERIALS - OUTLINE SPECIFICATION KEY
 Levels, boundaries, crossings, retaining walls, paving bedding + sub-bases, geotextiles, drainage channels, gutters etc to engineer and architect's design detail and specification.

- PEDESTRIAN PAVING (PUBLIC REALM) - INSITU CONCRETE**
Footpaths in public realm surfaced with concrete paving to local authority's RMS standards and detail with kerb and haunching to engineer's design detail and specification. Saw-cut joints at max 1200mm centres.
• 'White' coloured in-situ concrete (with Ecocom, GGBS and larger sized rounded aggregates in concrete mix) with exposed aggregate surface retarder ('Peri' by Grace Construction Products) finish and slip-form 'knave-edge' treatment to edges, all to engineer's design detail and specification. Concrete with Ecocom, GGBS and local rounded aggregates. 210mm depth without reinforcement; 150mm depth with mesh to engineer's design detail and specification. All works and finishes in public realm to be agreed with local authority by means of condition or compliance.
- PAVING (PUBLIC REALM) - NATURAL STONE PERMEABLE**
Paving to be designed by consulting engineers to drain permeability in accordance with BS 7533-3:2009. CE-marked flame-textured golden-coloured natural stone paving (slabs, sets and tactile warning surfaces) with a flame-textured finish and sawn all sides, min. 100mm depth to footpaths + gathering spaces. Class F Pedestrian paving (not trafficked by vehicles) to be laid open-jointed with 'Sunflow' plastic spacers fitted with 3mm down to dust jointing grit to free-draining bedding & sub-base to engineer's design detail and specification. Paving to cross-fall shed-drain to adjacent planter beds. Edge paving with L-shaped aluminium edging trim on C20P concrete rises 200x200mm. All natural stone paving to meet requirements of BS 7533-10:2021, and Parts 4 (2006), 6 (1999) and 7 (2010) of BS 7533. Stone paving to be manufactured in accordance with BS 7533-11:2003. Stone paving to be manufactured in accordance with BS EN 1241 (Natural Stone Tieg Paving) and BS EN 1242 (Natural Stone Setts). All works and finishes in public realm to be agreed with local authority by means of condition or compliance.
- PAVING (PUBLIC REALM) - NATURAL STONE BOUND**
All works and finishes in public realm to be agreed with local authority by means of condition or compliance. CE-marked golden granite paving 150mm² sets with a mix of pineapple- and flame-textured finishes, sawn 5 sides. Paving to shed-drain where possible through kerb-cut details into adjacent planter beds, to engineer's design detail and specification.
- PAVING (PUBLIC REALM) - NATURAL STONE KERBS**
250x200mm CE-marked golden granite kerbs, bull-nosed with 20mm² radius corner or exposed edge. Medium bush-hammered finish, set in concrete haunching. Provide kerb-cuts where required to allow paving to shed-drain into adjacent planter beds. Laid to meet requirements of BS 7533-8:1999, manufactured to EN 1343. All works and finishes in public realm to be agreed with local authority by means of condition or compliance.
- PAVING (PUBLIC REALM) - ASPHALT**
All footway pavements, kerbs, levels, sub-bases and bedding within the public realm to be agreed with Local Authority. CE-marked HRA-type asphalt surface, binder course (all to engineer's design detail and specification), surfacing to be certified to ISO 15. EN 13108 surfacing. Buff or silver-coloured pre-coated chipping aggregates to be scattered over the surface of the asphalt and rolled into it. Coloured coated chippings to have a high Polished Stone Value (PSV) and a low Aggregate Abrasion Value (AAV).
- PAVING (PERMEABLE) - HARD-BINDING GOLDEN GRAVEL**
Permeable rolled 50mm compacted depth cream-coloured quartz sandstone aggregate gravel 'quarry dust' surfacing of locally sourced angular shaped aggregates. 10mm aggregate size down to dust. Laid on 25mm depth of stone limestone bedding sand to allow free drainage but seal all interstices on granular sub-base to engineer's design detail and specification. Certify pypri-trete. Edge with L-shaped aluminium 'Permatic' edging trim on 200x200mm continuous C20P concrete bases, surfacing to be suitably be comfortably trafficked with wheelchairs, mobility devices and buggies.
- PAVING (PERMEABLE) - GRASSCRETE**
Reedex by Escotif vibro-rolled reinforced concrete cast stone grid paving in 100mm depth 600x600mm format, with 60% of surface area 'hard' and 40% formed by openings filled with a modified topsoil mix. Lay on 40-60mm depth bed of compacted sand on levelled P.M.95/1 compacted soil (UNE 103-501/94) on permeable sub-base and plug-plant with ground cover plants e.g. Chamomile, Mother of Thousands, etc.
- STREET FURNITURE - CYCLE SHELTERS (8 SPACES EACH)**
'Be Blue Shelter' (with 4 no. cycle stands to provide 8 no. cycle parking spaces in each shelter) by Green Roof Cycle Shelters or GKA, 3.70x2.20x2.02x0.78m. Laminated with green roof substrate, planting, external wildlife panels for solitary bees and invertebrates, and bird nesting boxes. Cycle shelters with built-in locking bars and clad to the rear and sides in the public open space with mesh to ensure clear views, and in the creche cycle parking area with timber cladding to rear and to sides and with lockable doors to ensure cycle parking for staff is secure. Provide 2.00m length free circulation space to front of cycle stands.
- STREET FURNITURE - CYCLE STANDS**
'ShedKaf' type cycle stands to provide short-stay visitor cycle parking (h=0.75mm, overall h=1.02mm) 25mm below surface, d=35mm, Ø=40mm, wall thickness 3mm, radius 165.9mm). Below surface flange fix with 8 no. M10 Rawl bolts per cycle stand on 100x100x10mm base plate, welded to post on concrete foundations to engineer's design detail and specification. Polished stainless steel. CHS. Spacing to be 1.80m length, with 2.00m free circulation space to front of stands.
- 'PLAY' BOULDERS: ROUNDED GLACIAL ERRATIC BOULDERS**
Rounded glacial erratic boulders (granite or sandstone) of variable size with either chamfered smooth edges or natural rounded shapes, depressed in the landscape finish to 0.30-0.40m depth, to achieve a 0.60m max height above the surrounding finished landscape levels to act as informal seating elements and/or bollards. Sharp edges, if present, to be deburred. Boulders of 0.75m (L), 1.00m (H) set on sub-base to engineer's design detail and specification on well-consolidated ground.
- BOUNDARY TREATMENT A: 5-RAIL ESTATE RAILING**
Slate type railing, all steel to mild grade steel, hot-dip galvanized and polyester powder-coated with two coats of paint to selected RAL, 'Olive Grey' RAL 7002, 'Millstream' by Irish Fenix or equivalent approved. Height: 1.20m, with 3 no. 2.00m wide and 2 no. 1.50m wide factory-assembled panels, bolted together on site. No posts to be located in tree pits.
• Railing comprises a solid panel of rails and posts + 4 no. horizontal 20x6mm MSF rails top 20mm x 20mm hole bar top rail with 2 no. 50x10mm MSF 'slat' or 'rod' posts, 3 no. 50x10mm 'jailer' posts, method of setting posts: 'Devil Claw' option
• Finish: hot-dipped galvanneal mild steel to EN9 ISO 1461:2009 after fabrication and subsequently electro-estatically powder-coated with two coats of paint
• Conformity: submit manufacturer's and installer certificates to BS 1722-8
• Foundations: posts to be erected plumb and level in concrete bases min size 300x300x600mm using concrete mix, C25A
- STREET FURNITURE - SEATS, BENCHES + PICNIC SETS**
'Drifter' seats, benches and picnic sets by Streetlife NL in standard lengths of 2.00m and 3.00m with galvanneal steel finish supports (finished with a double layer powder coating), provided with 1.8m length back-rests to 2.00m seats with a variety of L1 (300mm depth) + L2 (600mm) slat widths. Recycled 100% hardwood.
- SCULPTURE LOCATION - PUBLIC OPEN SPACE**
Graphic denotes suggested location for contemporary art sculpture at local areas throughout the proposed development.
- DRAINAGE STRIP TO BASE OF ELEVATIONS + PARAPETS**
500mm width, min. 150mm depth layer of 10-20mm diameter washed and graded pea gravel at roof penetrations, along parapets and at base of elevations. 50x150mm pressure-treated edging to separate growing medium and planting. To FLL standards.
- PROPRIETARY SUDS TREE PITS (TP-01, TP-02, TP-03, TP-04)**
Street tree planting in proprietary SuDS tree pits with appropriate accessories including ventilation and irrigation pipes 3.00m. 'Tropic irrigation' riel installed around roadway. Roadables to be graded using proprietary 'ArborGrid' system. Root restricting membrane to line all sides of pits. No services runs to be laid in tree pits. Proprietary stormwater management system 'ArborFlow' by GreenBlue Urban with modular 'RootSpace' soil cells filled with 'RootBlock Hydro' and appropriate root management systems and details, or equivalent approved. 20% soil by volume, all to engineer's design detail and specification.
- TREDS + TACTILE SURFACES: NATURAL STONE**
40x150mm CE-marked granite cased tread steps elements, bull-nosed with 20mm radius corner to exposed edge, detailed to comply with BS 8300. Medium bush-hammered finish. Natural stone tactile hazard warning surfaces to top and bottom of flight, to comply with BS 7807. Wooden elliptical handrails on galvanneal painted steel uprights, bolted through natural stone treads to concrete foundations.
- AMPHITHEATRE STEPPED SEATING: RECLAIMED TEAK OR EOA**
Sustainable sourced boards (avoid new radiused-cut wood), preferably reclaimed teak or equivalent approved including European green oak or mountain larch, to provide stepped south-facing seating elements along the edge of the courtyard podium, overlooking the amenity planted areas. Surfacing to achieve min. 45 slip resistance pendulum value when measured, suitable for public access.

L00: 'SOFT' LANDSCAPE MATERIALS - OUTLINE SPECIFICATION KEY
 Refer to Planting Details, Planting Schedule and Planting Maintenance programme. 24-month long landscape maintenance and L4-certified Defects Liability Period required post-Practical Completion. The planting stock should be sourced from a reputable supplier and be of Irish origin/provenance.

- H1 - NEW HORNBEAM CG CLIPPED HEDGEROW**
Carpinus betulus (hornbeam) 1.00-1.20m Ht. pollard plants, barely to be made in double clipped row, with 2 plants per 500mm length. Provide 75mm depth, 1200mm width, medium-grade bark mulch topping to reduce future weed growth at base. Cut hedge to 1.20m Ht after planting to ensure an even height along the hedgerow. Min. 1.20m Ht sweet chestnut pal. post and wire fence to protect hedge.
- H2 - NEW NATIVE MIXED SPP TRANSPARENT HEDGEROW**
Wildlife Fruiting Hedge (species such as Hawthorn, Hazel, Elder, Bird Cherry, Blackthorn, Crab Apple, Wayfaring Tree, Holly), which planted in groups of varieties that repeat themselves along the hedge, to mature as a 'natural' hedgerow. Plant in staggered rows, 4 hedging transplants per m², 1 no. climbing plant per 0.5m length pal. post. Hedge to be planted with 1.20m width, medium-grade bark mulch topping to reduce future weed growth at base.
- DRIFTS OF BULB PLANTING**
Plug-planted with top soil 50t bales Crocus vars., Galanthus nivalis, Allium ursinum, Anemone nemorosa, Hyacinthoides non-scripta etc., variety and species depending on soil type and landscape conditions.
- PERENNIAL PLANTING TYPES: P1 P2 P3**
Mixture of ornamental perennial garden plants to planter beds with a diverse mix 70:30 ratio of ornamentals, grasses, bulbs, corms, ferns, ground-cover plants, sedums to flowering perennials of both native cultivars and exotic species to ensure a pollinator-friendly planting mix in line with the 'National Pollinator Plan'. These plants should establish quickly requiring minimised maintenance.
- TREE PLANTING GENERALLY**
This drawing is the copyright of studioAULA landscape architects. This drawing must be read in conjunction with all relevant design team and surveyor's drawings, details and specifications. Unless otherwise stated all dimensions are in millimetres. Where dimensions are not given, drawings must not be scaled and the matter must be referred to the Landscape Architect. Similarly if the drawings contain conflicting details or dimensions.
If this drawing includes conflicting details/dimensions the matter must be referred to the Landscape Architect.
All dimensions stated are checked on site prior to construction or fabrication. The Landscape Architect must be informed, by the Contractor, of any discrepancies before work proceeds.
This drawing has not been prepared for BCAR, BCMS or CAD purposes, and has not been prepared to demonstrate compliance with the Building Regulations.
- SEM-MATURE TREES**
S1 Prunella 30-35cm/1 @ 6.0-8.5m Ht.
S2 Salix alba 'Babingtonia' 40cm/1 @ 6.0-8.5m Ht.
- SEMI-MATURE TREES**
L1 Ligustrum sycasticum 'Fastigiata' 30cm/1 @ 2.5-3m Ht.
- EXTRA HEAVY STANDARD TREES**
B1 Acer platanoides 100cm/1 @ 15.0-20.0m Ht.
- MULTI-STEMMED TREES, LARGE SHRUBS**
A1 Amelanchier canadensis, 20cm/1 @ 2.5-3.0m Ht.
B1 Betula nigra 'Heritage', 20cm/1 @ 2.5-3.0m Ht.
M1 Hamamelis intermedia, 20cm/1 @ 2.5-3.0m Ht.
M2 Magnolia tobaia, 20cm/1 @ 2.5-3.0m Ht.



LANDSCAPE - NUMBERED KEY

- Public Footpath** 2.00m width public footpath surfaced in in-situ concrete to meet requirements of local authority specification to provide DMURS compliant pedestrian access along Firhouse Road and along Mount Carmel Park streetscape north to Dodder Valley Park; all proposed works in public realm to be agreed with Local Authority.
- Crossover** detail at vehicular site entrance to highlight pedestrian priority over the vehicle with 'raised table' or horizontal deflection surfaced in natural stone to give pedestrians priority over vehicles
- Cycle Parking** Secure covered cycle shelters with green roof, planting and substrate, external wildlife panels for solitary bees and invertebrates and bird nesting boxes. Cycle shelters with built-in locking bars or Sheffield-type stands, with either timber cladding or galvanised steel mesh panels to elevations, open to front.
- Peripheral Open Space** native pollinator-friendly and shade-tolerant hedge planted along the site boundary to create a 'green corridor' to support the movement of animals through the site along the north-western boundary
- Existing stand of trees** growing in Dodder Valley Park protected with measures identified by the consulting arborist and pruned back as per the arborist's plan
- Creche Access path** min. 1.80m width path (internal within site boundary) to provide pedestrian access from car-park creche visit set-down area to the creche entrance in the western elevation and from basement car-park drop-off parking to creche child drop-off
- Secure creche amenity external open space** suitable for children's play ages 0-5, landscaped with toddler table and stools, multi-user adventure play equipment for toddlers, and elemental play equipment suitable for use by babies and toddlers
- Gathering Space** or small piazza for residents and the locals in the public realm, provided with seating, bench and picnic set elements and feature tree planting. Focal element sculptures with sensory appeal located at each space to signal and mark them within the public realm amenity open space
- 3.00m width public path** all-ages friendly route as desire-line through the site at the base of the building elevation, occupied with seating elements, picnic sets, interactive playful elements and sculptures. Path paved in natural stone paving
- Arcaded colonnade** paved in natural stone paving, south-facing to overlook the public open space, providing an all-weather shelter for people, and comfortable access for all abilities using a platform lift to the podium courtyard communal amenity open space
- Amphitheatre 'stoop'** seating between path and podium, south-facing to overlook the public open space and 3.00m width path
- Stepped access** to the podium courtyard communal amenity open space
- Amphitheatre 'stoop'** seating to the roof of the barbershop, to overlook the podium courtyard communal amenity open space
- All weather pergola shelter** with power and water connections, and an external grill kitchen for resident events
- Central feature planter** formed out of pre-cast polished concrete with exposed aggregates, provided with feature lighting, and planted with large native evergreen Scot's Pine, to recall the placename 'Firhouse'
- Gathering space** on podium courtyard, provided with seating elements, located directly outside building entrance (stair/lift core to B-01)
- All weather pergola shelter** with power and water connections, and a picnic set; located to enjoy direct views of the existing vegetation stand growing in Dodder Valley Park to the north-west of the podium courtyard
- SuDS tree pits** (TP-01, TP-02, TP-03 and TP-04)

ABOVE: L00 Type of Open Space by OMP Architects

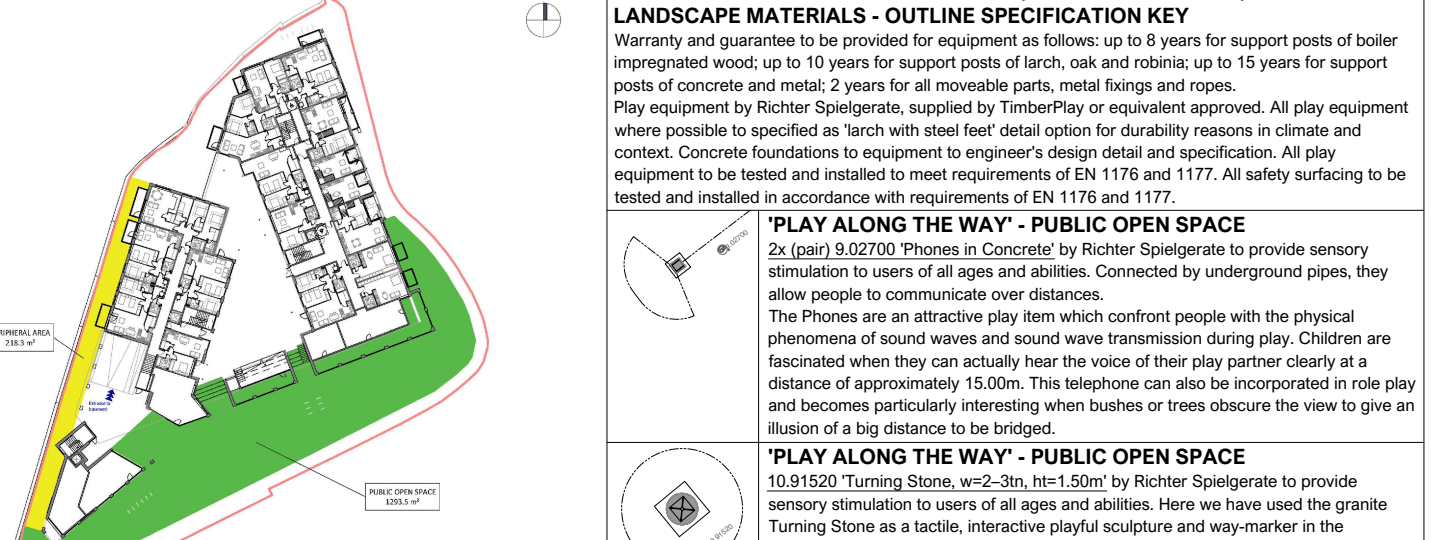

ABOVE: L01 Type of Open Space by OMP Architects

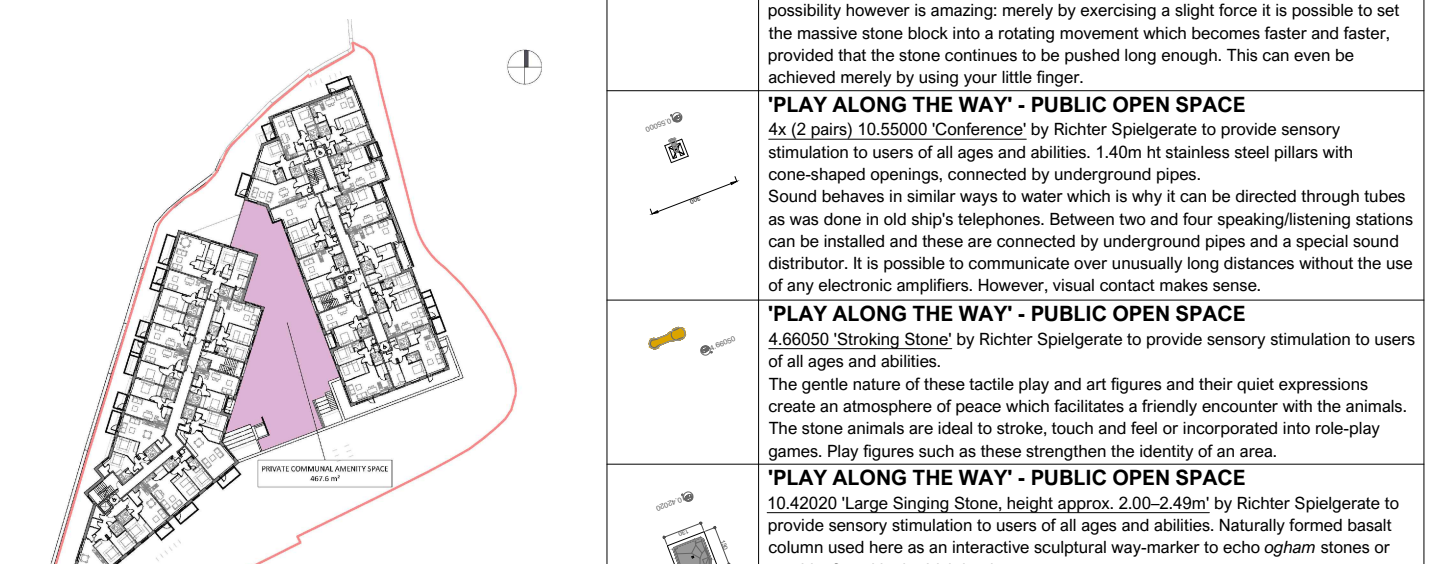

ABOVE: Quantum of Open Space Table by OMP Architects

Open Space Area Schedule			Public Open Space % of Site Area		
Name	Level	Area	Name	Area	% Percentage of Site Area
CRECHE PLAY SPACE	B1	216.3 m ²	PUBLIC OPEN SPACE	1347.4 m ²	29.3
PUBLIC OPEN SPACE	B1	53.9 m ²	PERIPHERAL AREA	81	29.9
PERIPHERAL AREA	B1	29 m ²	PERIPHERAL AREA	81	11.3
PRIVATE COMMUNAL AMENITY SPACE	O1	467.6 m ²	PUBLIC OPEN SPACE	G2	1293.5 m ²
PRIVATE COMMUNAL AMENITY SPACE	O2	30.9 m ²	PERIPHERAL AREA	G2	218.3 m ²
PRIVATE COMMUNAL AMENITY SPACE	O3	168.5 m ²	PRIVATE COMMUNAL AMENITY SPACE	O1	467.6 m ²
PRIVATE COMMUNAL AMENITY SPACE	O4	295.9 m ²	PRIVATE COMMUNAL AMENITY SPACE	O2	30.9 m ²
			PRIVATE COMMUNAL AMENITY SPACE	O3	168.5 m ²
			PRIVATE COMMUNAL AMENITY SPACE	O4	295.9 m ²

ABOVE: Quantum of Open Space Table by OMP Architects

STUDIO AULA
 ARCHITECTURE | URBANISM | LANDSCAPE ARCHITECTURE
 45, Beggan Lane, Ballybeg, Co. Wick
 T +353 852 362 6482
 info@studioaula.com
 www.studioaula.com

CLIENT: Blumont Developments (Firhouse) Limited
PROJECT: FIRHOUSE INN SHD
DRAWING: DETAIL 1, 2 LANDSCAPE PLAN - LEVEL 00 PODIUM + GROUND LEVEL

ISSUE STATUS:
 PLANNING REF: ...
 REVISION: ...
 DATE ISSUED: 2021-05-25
 DATE OF THIS SET: 2022-05-27
 DATE OF NEXT SET: ...

DRAWN BY: JC
CHECKED BY: ...
DATE ISSUED: ...
DATE OF THIS SET: ...
DATE OF NEXT SET: ...

PROJECT ARCHITECTS: OMP ARCHITECTS

