

KEY PLAN

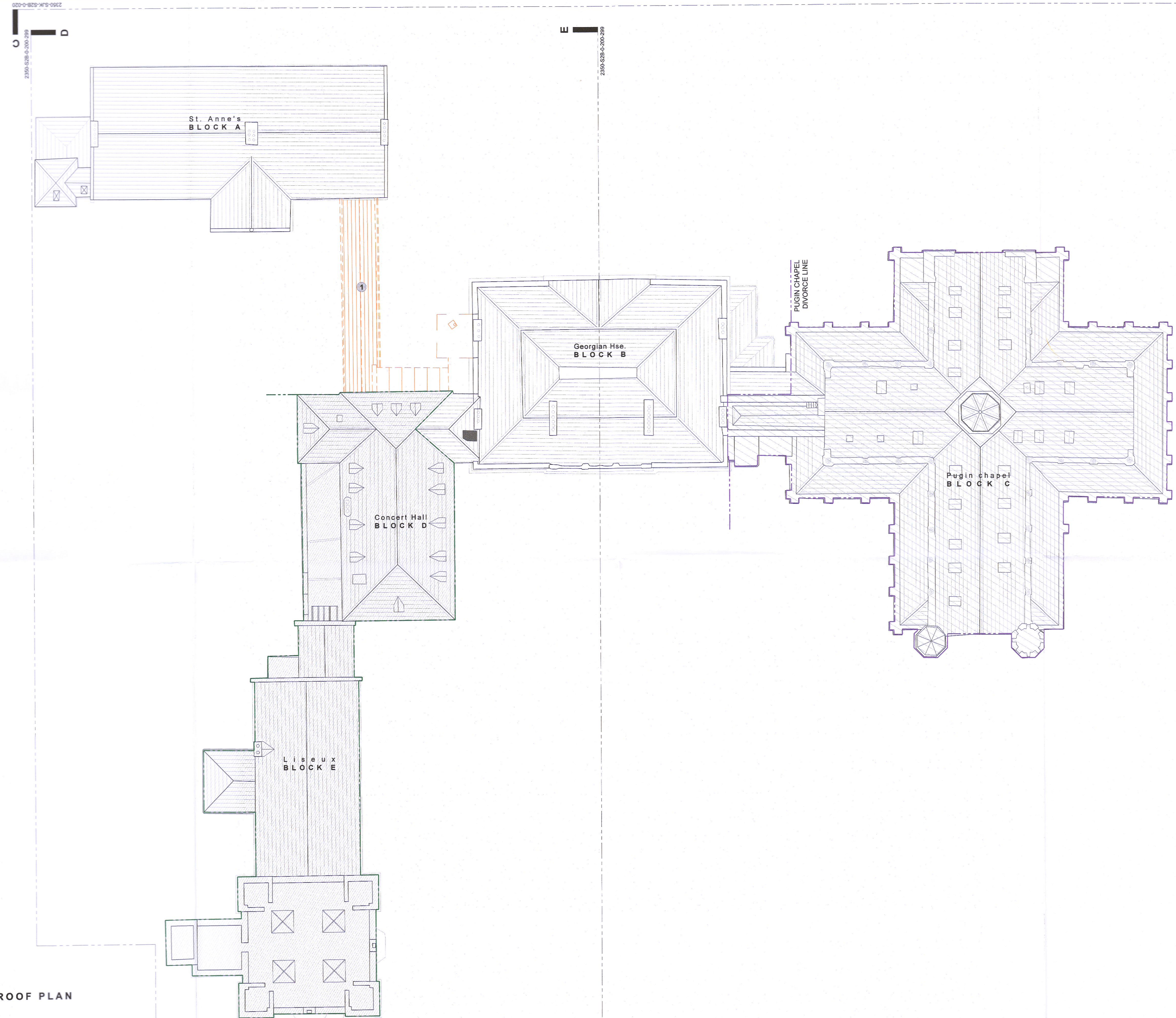

- LEGEND
- - - Proposed building demolition
 - ① Remove existing link and 1970s toilet block between blocks A, B, and D

PROPOSED DEMOLITION ROOF PLAN

Conditions of use of this drawing
 note: if this A1 size drawing is reproduced at a smaller size which makes these conditions difficult to read, please contact the Architects office for a legible copy of these conditions.

1. This drawing is the design and contains copyright. All rights are reserved. No part hereof may be copied or reproduced, in whole or in part, without the prior written consent of the copyright owner Simon J Kelly Architects.
2. This drawing is to be used only for the specific project and for the specific purpose for which it has been prepared. It is not to be used for any other project, in whole or in part, without the prior written consent of the copyright owner.
3. The Employer is granted a copyright licence to use this drawing and its contents for the purposes for which the drawing has been prepared. If the Employer is granted a copyright licence to use this drawing and its contents for the purposes for which the drawing has been prepared, the Employer shall be deemed to have accepted the copyright owner's conditions of use.
4. Where the Employer is granted a copyright licence to use this drawing and its contents for the purposes for which the drawing has been prepared, the Employer shall be deemed to have accepted the copyright owner's conditions of use.

5. Do not scale off this drawing. Figured metric dimensions only should be taken off this drawing. Imperial dimensions, if any, contained on this drawing are given for illustrative purposes only.
6. All contractors, whether main or sub contractors, must visit the site and are responsible for taking and checking any and all dimensions levels and the like that relate to the works.
7. Where this drawing contains discrepancies in relation to other related documents, such discrepancies shall be brought to the attention of the Architect who shall issue a written instruction as to which information is to be followed, and until such written Architect instruction has been issued any work carried out on foot of the discrepancies shall be unauthorized.
8. References to National Standards, whether to Irish (IS), British (BS) or otherwise, or codes of practice (CP) shall be deemed to refer to the latest standard or code current at the date of issue of the drawing notwithstanding any reference to the contrary or to any earlier standard.
9. Any reference to the 'Architect' or 'Architects' on this or any other relevant document shall mean the nominated project Architect and or a Director of Simon J Kelly Architects who has been nominated as its partner-in-charge but only while such Architect remains in the employment of Simon J Kelly Architects.
10. Any questions as to the meaning or application of these conditions shall be submitted in writing to the Architect for his/her ruling and such a ruling shall be conclusive as to the meaning or application of these conditions.
11. Simon J Kelly Architects, their Agents, Architects, employees and or directors shall not be liable for any loss damage or injury consequential or otherwise however arising from the use of this drawing and its contents in whole or in part in relation to any project and or project which the drawing has not been prepared for, such use is at the sole and exclusive risk of the user and Simon J Kelly Architects do not accept any liability whatsoever howsoever arising in relation to such use.
12. Should anyone copy this drawing in whole or in part with or without consent and use the copy in relation to a purpose and or project which the drawing has not been prepared for, such use is at the sole and exclusive risk of the user and Simon J Kelly Architects do not accept any liability whatsoever howsoever arising in relation to such use.
13. Should anyone copy this drawing in whole or in part with or without consent these conditions of use in full and reproduce them with the copy. These conditions of use are to be read in conjunction with the drawing and its contents, these conditions of use form part of this drawing and its contents and are inseparable from this drawing and its contents.
14. The use of or reliance upon this drawing and or its contents shall be deemed to be acceptance of these conditions of use unless otherwise agreed in writing, such written agreement to be sought from and issued by the Architect prior to the use or reliance upon this drawing and or its contents.
15. All drawings are to be read in conjunction with the fire safety compliance report, all other contract documents, all statutory consents and or requirements and all statutory obligations.

preliminary
not for construction

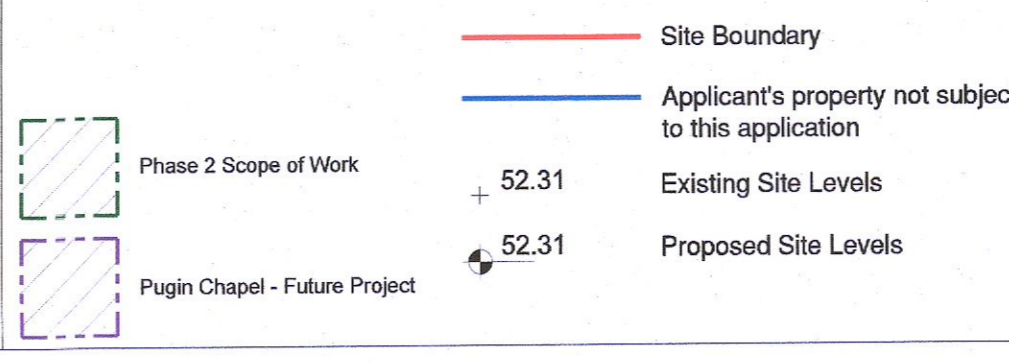

PROJECT: Gaecholáiste an Phiarsaigh - Loreto Abbey, Rathfarnham		CLIENT: Department of Education / Board of Management	
DRAWING: Roof Plan - Demolitions		DRAWN BY: CUJC	
DRAWING PURPOSE: Planning		APPROVED: DATE: June '22	DATE: June '22
DRAWING SIZE: A1	SCALE: 1:200	DRAWING REFERENCE: 2350-SJK-S2B-0-134	REV. NO.

rev. | date | description

Fitzgerald Kavanagh + Partners
 1 Mount Street Crescent,
 Dublin 2,
 D02 XFS7
 +353 1 676 4128
 info@fkp.ie
 www.fkp.ie

Simon J Kelly Architects
 21 Middle Street,
 Galway
 +353 01 56 2949
 Cox's Yard,
 Westport, Mayo
 +353 98 26 414
 mail@sjk.ie
 www.sjk.ie