

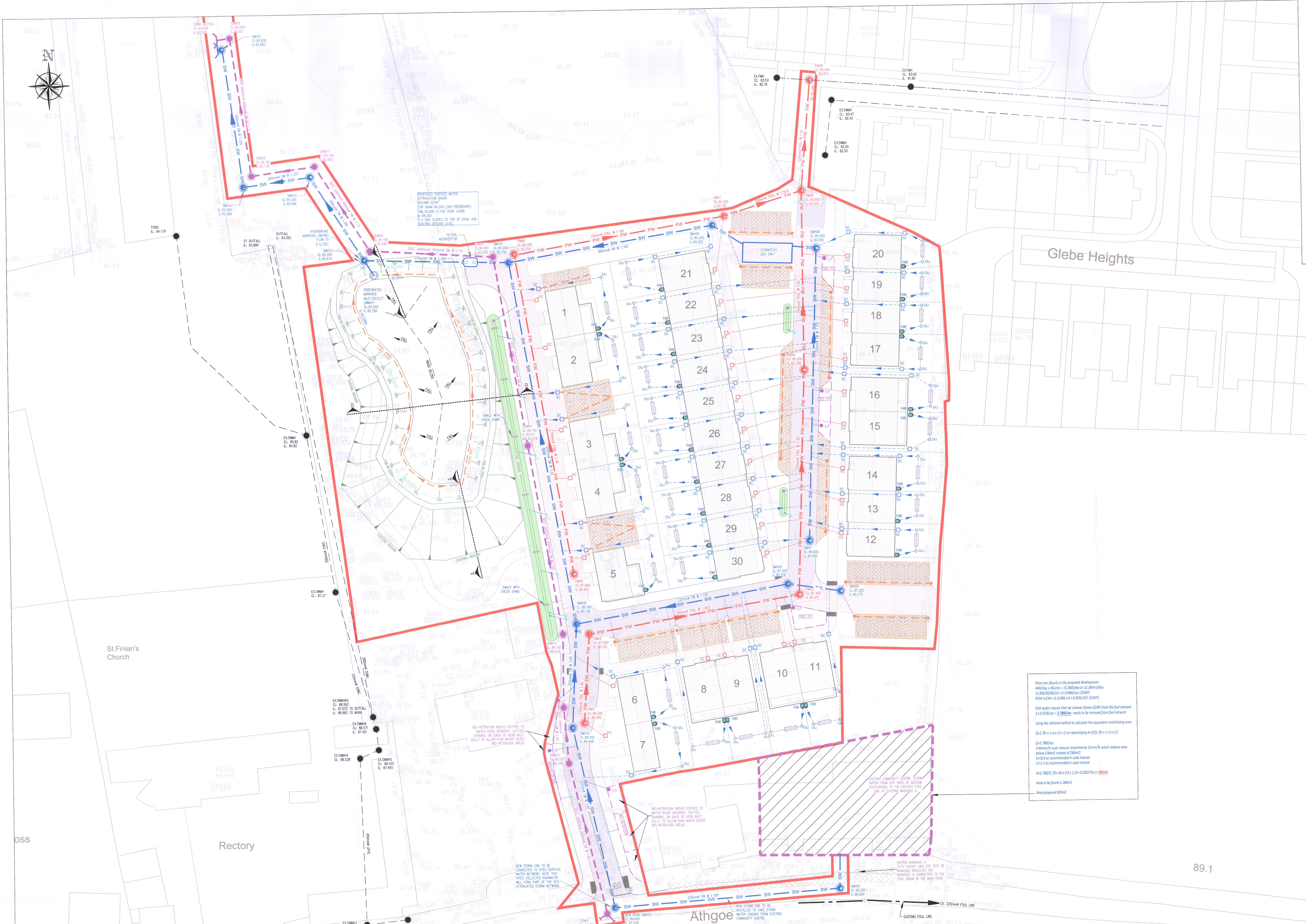

LEGEND

- EXISTING FOUL SEWER
- EXISTING SURFACE WATER DITCH
- PROPOSED FOUL SEWER
- PROPOSED SURFACE WATER SEWER
- PROPOSED 300mm additional 450mm SW
- PROPOSED 150mm PERFORATED PIPE (PERMEABLE PAVING COLLECTOR PIPE)
- PROPOSED PERMEABLE PAVING
- PROPOSED PERMEABLE COLLECTION INSPECTION CHAMBER
- PROPOSED TREE PIT
- PROPOSED OVERFLOW FROM TREE PITS
- PROPOSED ROAD GULLY
- PROPOSED RAINWATER BUTT
- PROPOSED SEAR GARDEN INFILTRATION TRENCH WITH PERFORATED COLLECTOR PIPE
- PROPOSED SNAKE
- PROPOSED SNAKE COLLECTION CHAMBER WITH GRATED ID
- SNAKE CHECK DAM



There are 30 units in the proposed development.
 4465/Day x 30units = 13,395/Day or 13.395m³/Day
 13,395/30/24 = 0.1848/Sec (120W)
 0.1848/Sec = 0.2548m³/s = 0.002548m³/s (SW)
 High water requires that we remove 30mm SW from the foul network.
 3 x 0.025/Sec = 0.075/Sec needs to be removed from foul network
 Using the rational method to calculate the equivalent contributing area
 C=0.78 x 1 x A x C₁ x C₂ or rearranging A=(C₁ x C₂) / (C x 0.78)
 C=0.78/Sec
 0.025/Sec is the rational method recommendation; 25mm/s which reduces one below (24mm/s) instead of 28mm/s
 C=0.9 as recommended in such manual
 C=1.0 as recommended in such manual
 A=2.788/(0.78 x 30 x 0.9 x 1.3) = 0.02837ha or 283m²
 Area to be found is 283m²
 Area proposed 620m²

**PLANNING DRAWING.
 NOT FOR CONSTRUCTION.
 ALL LEVELS GIVEN ARE
 RELATIVE TO ORDNANCE DATUM.
 THIS DRAWING HAS BEEN ISSUED FOR INFORMATION
 PURPOSES ONLY AND MUST NOT BE USED
 FOR CONSTRUCTION UNDER ANY CIRCUMSTANCES**

- NOTES**
- For setting out refer to Architect's drawings.
 - This drawing is to be read in conjunction with all other Architectural and Engineering drawings and all other relevant drawings and Specifications.
 - DO NOT SCALE THIS DRAWING. Use figured dimensions only.
 - No part of this document may be reproduced or transmitted in any form or stored in any retrieval system of any nature without the written permission of copyright holder except as agreed for use on the project for which this document was originally issued.
 - Ordnance Survey Ireland Licence Number EN 0074022

Rev. No.	Date	REVISION NOTE	Drawn By	Checked By
P1	19.05.2022	ISSUED FOR PLANNING	SC	SB
P2	10.08.2022	REVISED AND REBUILT FOR PLANNING	SC	SB

Architect	JFOC Architects Proposed Development at Newcastle, Co. Dublin
Title	Proposed Drainage Layout
Drawn No.	NCA-CSC-ZI-SIDR-C-0002
Date	May 2022
Drawn by	JMC
Checked by	SS
Scale	CS 1:200 A0
Revision	P2

CS Consulting Group
 DUBLIN | LONDON | LIMERICK
 Head Office: 19-21 Dame Street, Dublin 2.
 T: +353 (0)1 5460963
 E: info@csconsulting.ie
 W: www.csconsulting.ie

Quality: ISO 9001:2015
 Environment: ISO 14001:2015
 Health & Safety: ISO 45001:2018

0099