

Homezone - Typical Street Tree Arrangement

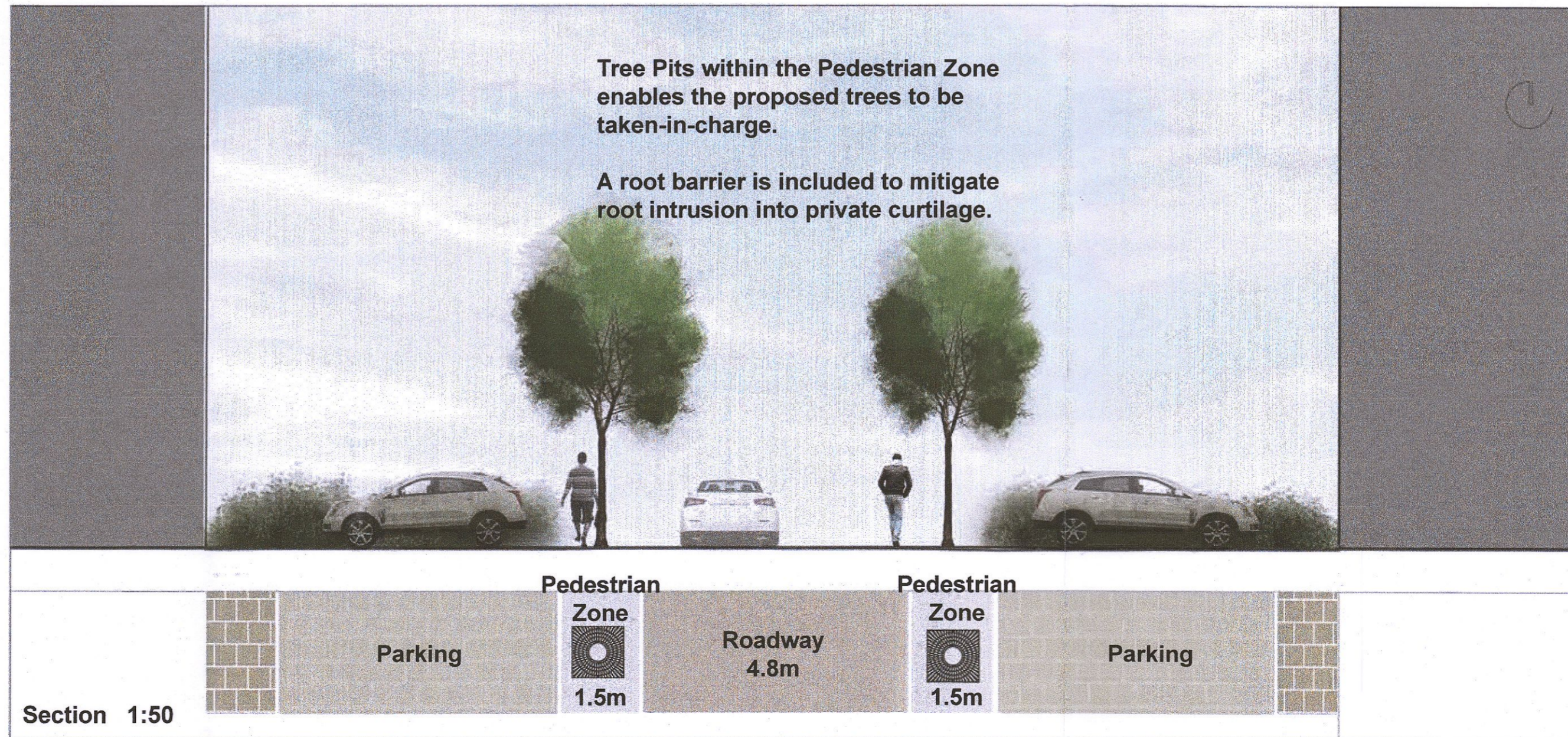
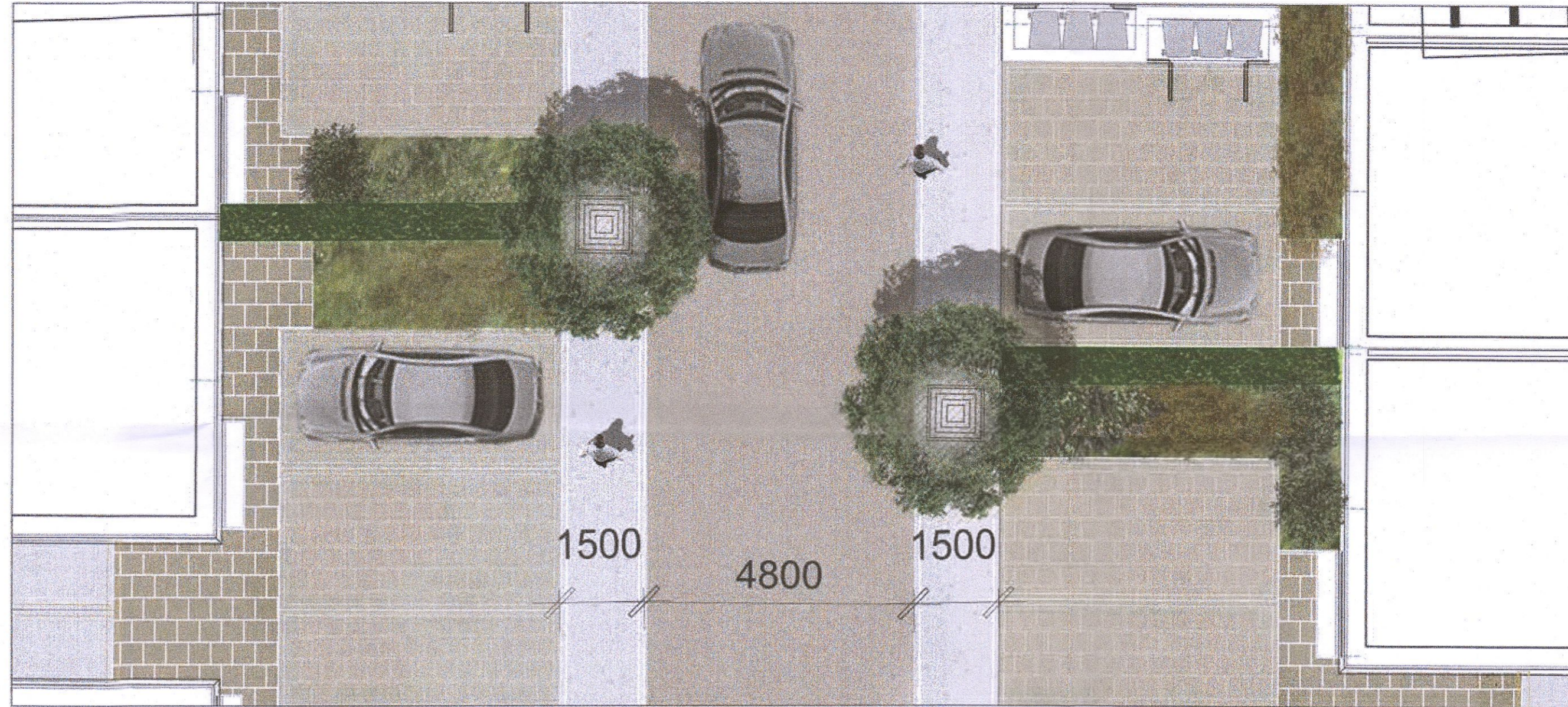
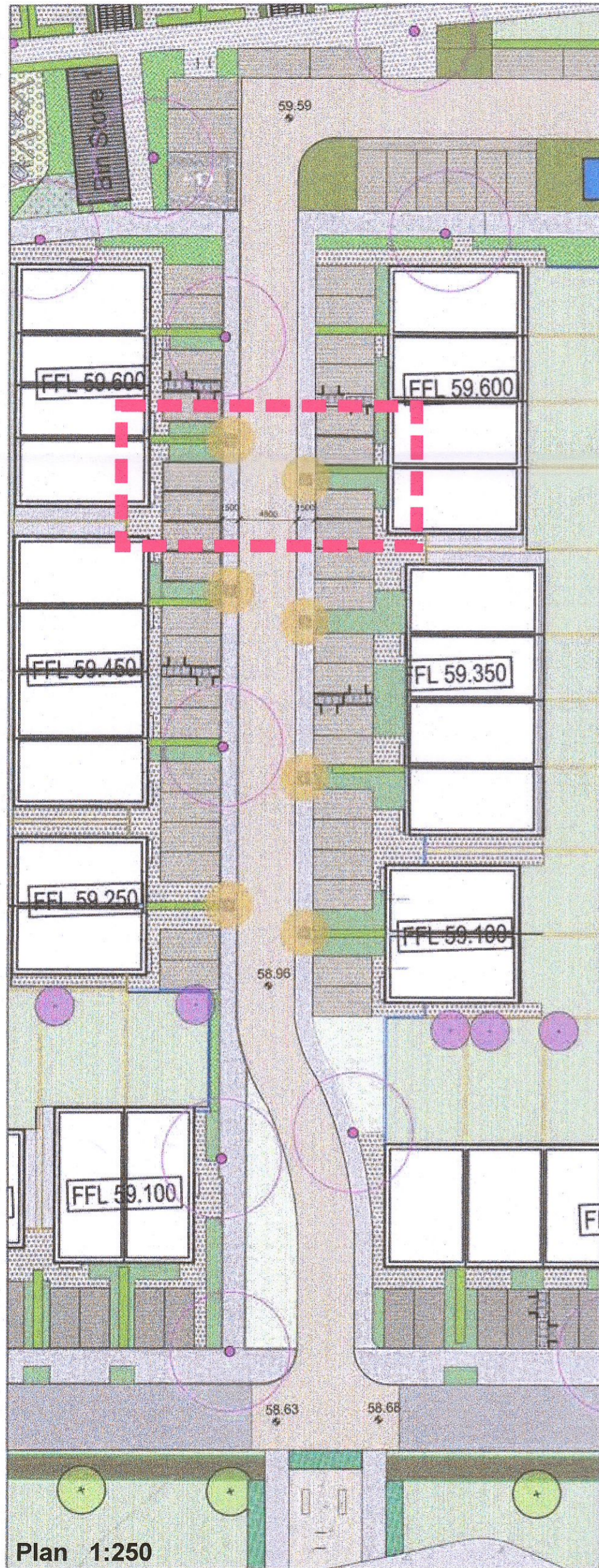

1. This drawing is intended to show landscape architectural proposals only. Please refer to Architects and Engineers drawings for relevant details of buildings, structures, roads, parking etc.
2. The copyright of this drawing is vested with Murray & Associates. This drawing may not be copied or reproduced without written consent.
3. All materials referred to on this drawing - including plant species - are indicative and subject to change following detailed site investigations. Significant changes, if any are requested will be referred to the relevant authority for agreement.
4. This drawing is not suitable for use for construction purposes.
5. Discrepancies to be referred to Murray & Associates for clarification.

murray & associates
landscape architecture

18 The Seapoint Building, mal@murray-associates.com
44-45 Clontarf Road, www.murray-associates.com
Dublin 3, D03 RF93, +353 (0)1 654 0060

0	09/06/22	Updated drawing	IS/FT	MB
REV	DATE	REVISION	DRAWN	CHECKED

CLIENT
Cairn Homes Properties Ltd.

PROJECT TITLE
Clonburris Phase 1A

SHEET TITLE
Typical Street Tree Arrangement - Homezone

SHEET NO. 1738_PL_P_08	SHEET SIZE A2
SCALE As Shown	REVISION 0
STAGE Planning	DATE 09/06/22