

PAVEMENT FOUNDATION DETAIL FOR ACCESS ROAD

NOT TO SCALE

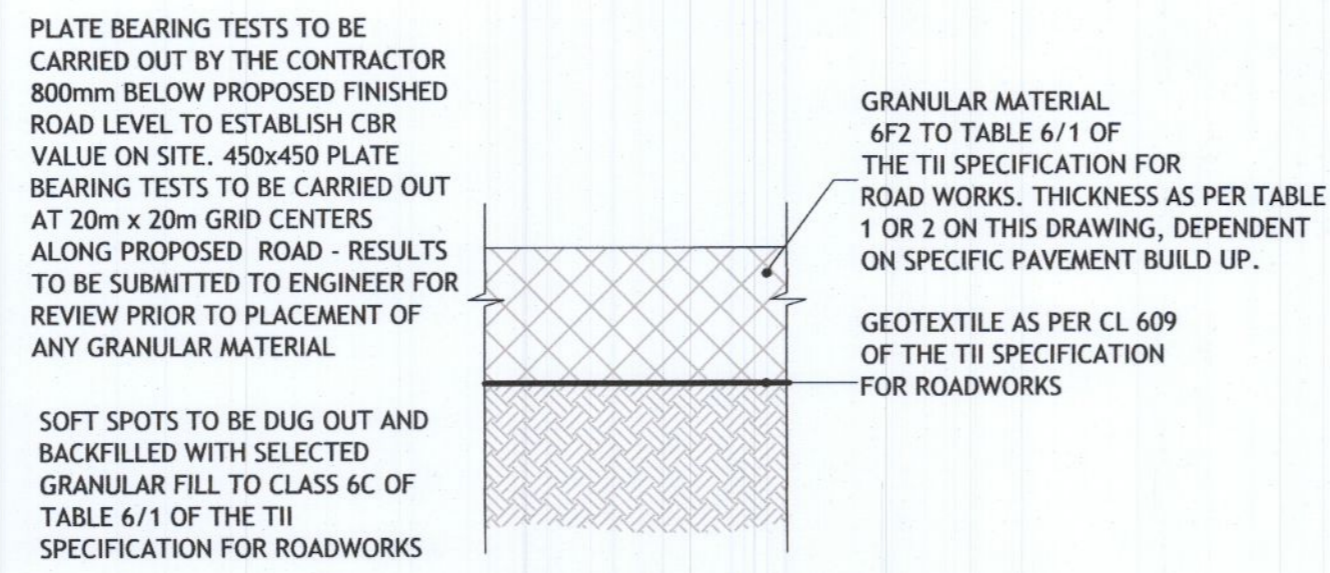

CAPPING DETAIL (STANDARD REFERENCE)

NOT TO SCALE

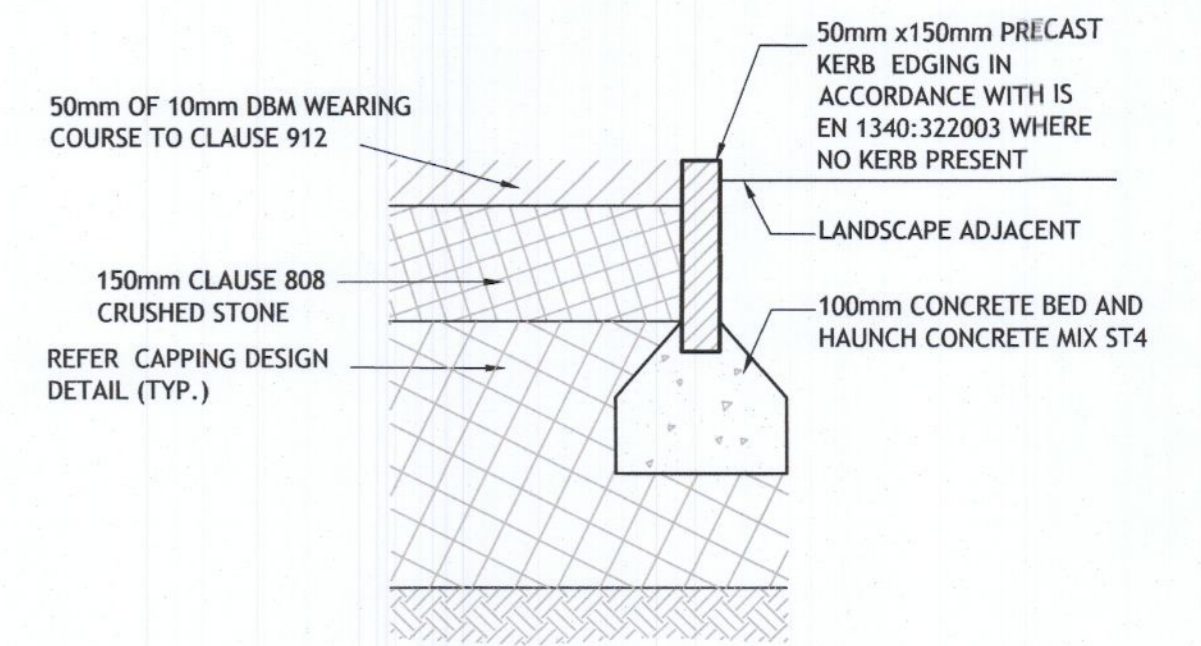
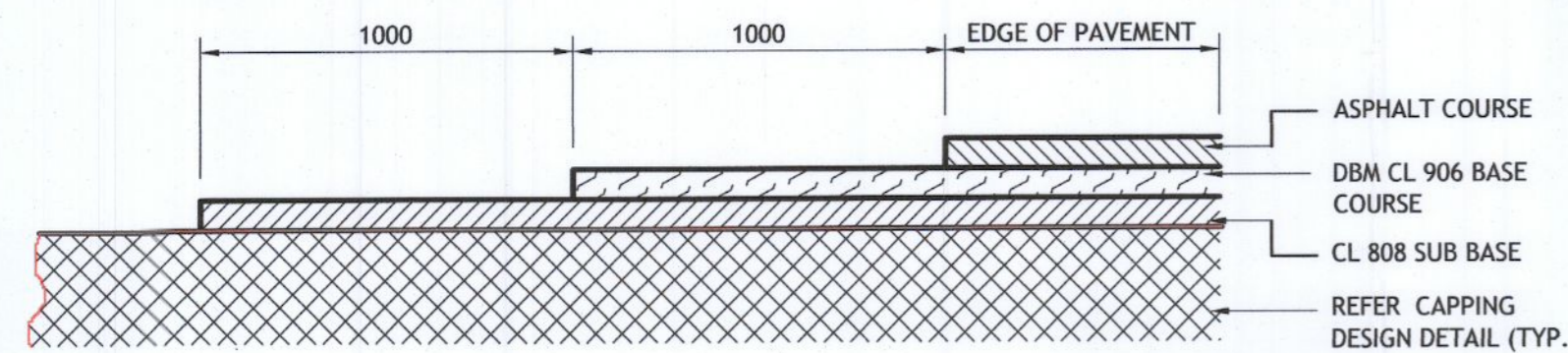

PLATE BEARING TESTS REQUIRED AT 20.0mm CENTERS ON FORMATION LEVEL - RESULTS TO BE SUBMITTED TO THE ENGINEER FOR REVIEW AND APPROVAL PRIOR TO PLACEMENT OF PAVEMENT

ASPHALT FOOTPATH BUILD-UP

NOT TO SCALE



EDGE OF PROPOSED PAVEMENT TO ALLOW FOR FUTURE CONNECTION

NOT TO SCALE

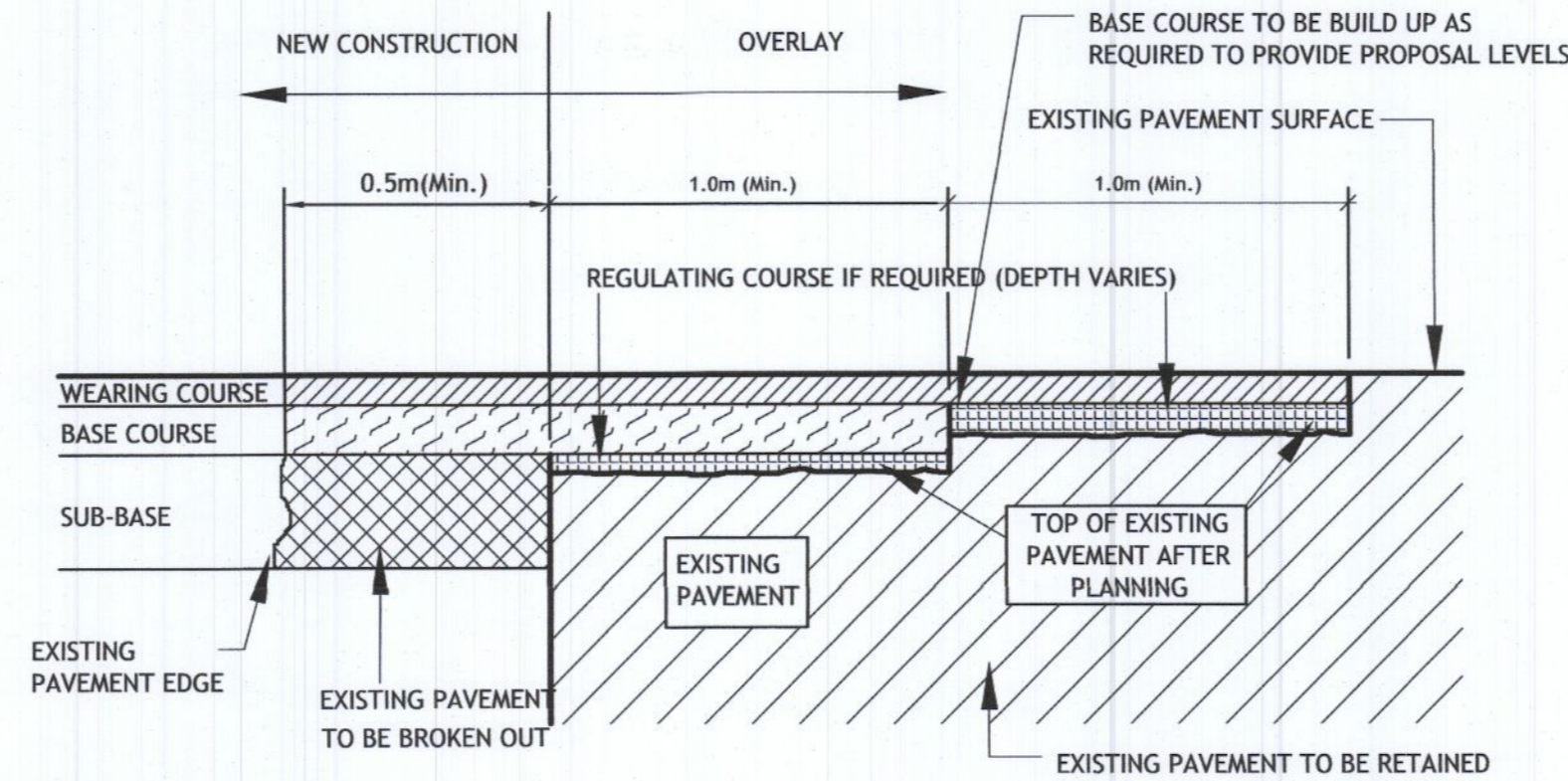

TRANSVERSE JOINT BETWEEN PROPOSED FLEXIBLE PAVEMENT & EXISTING ROAD

NOT TO SCALE

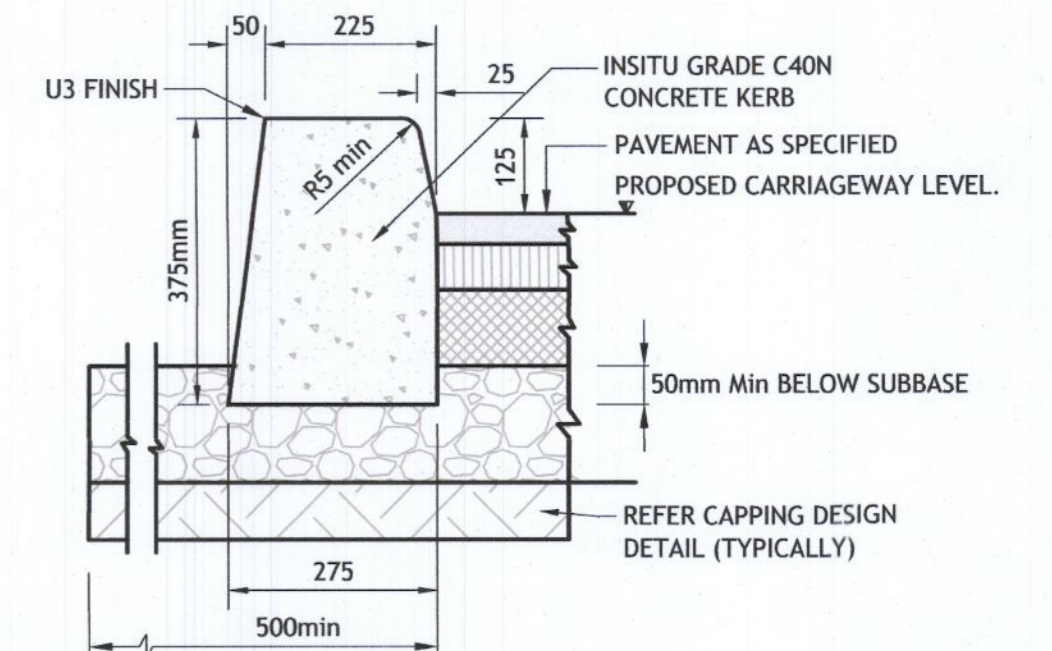

TYPICAL 375mm DEEP ROAD KERB DETAIL

NOT TO SCALE

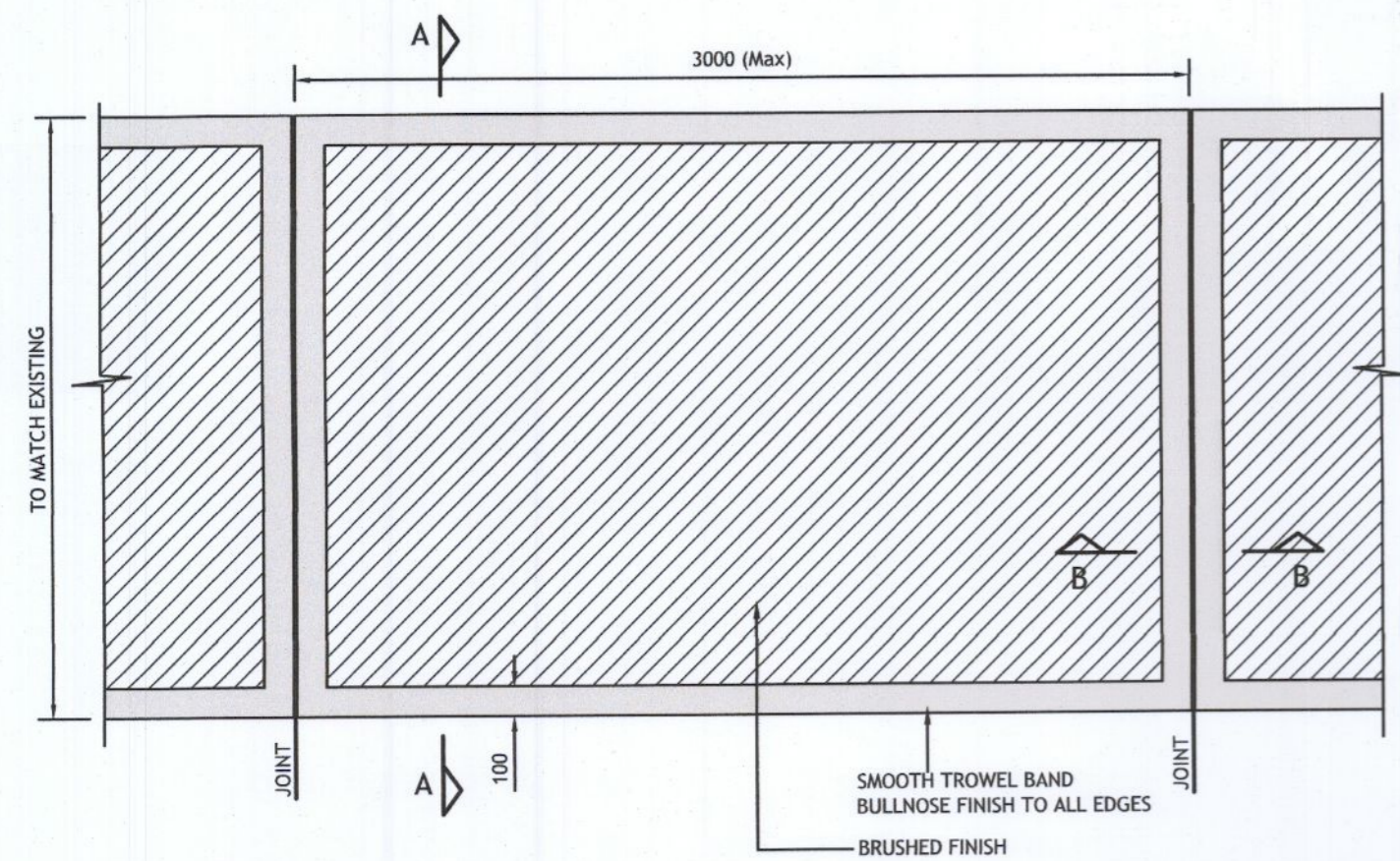

PLAN - CONCRETE FOOTPATH DETAILS

SCALE 1:25

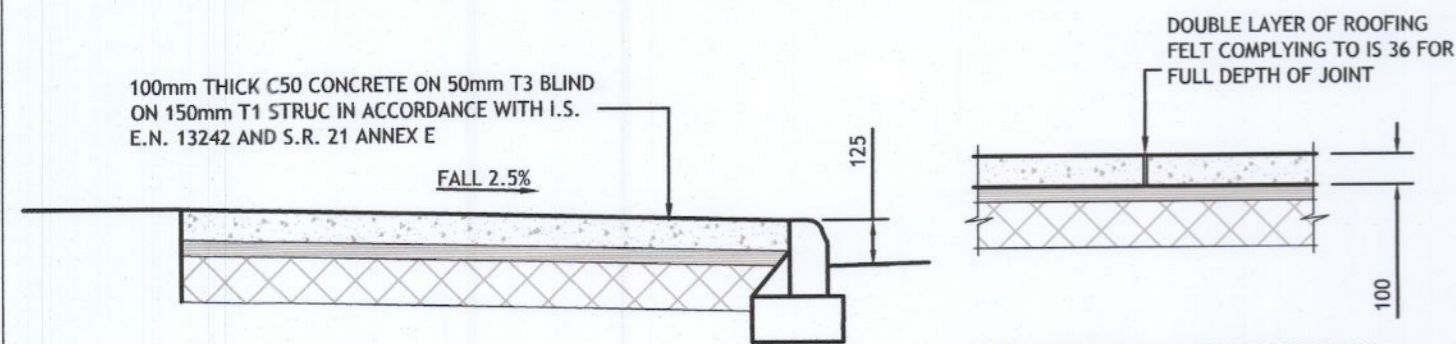

SECTION A-A

SCALE 1:25

SECTION B-B (JOINT DETAIL)

SCALE 1:25

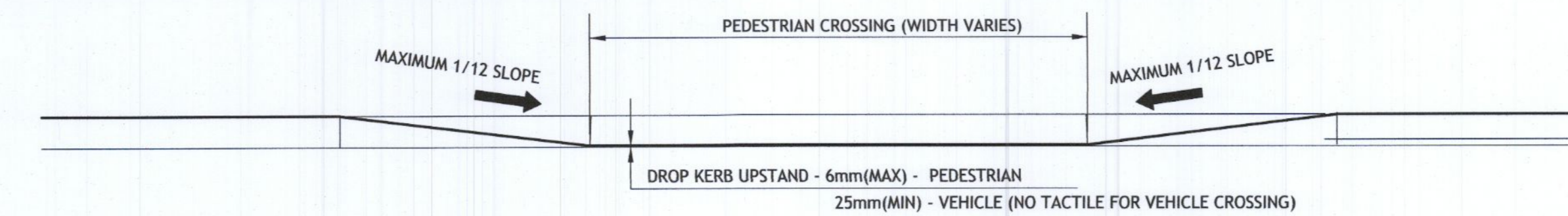

TYPICAL ELEVATION OF DROPPED KERB (DK)

SCALE: 1:20

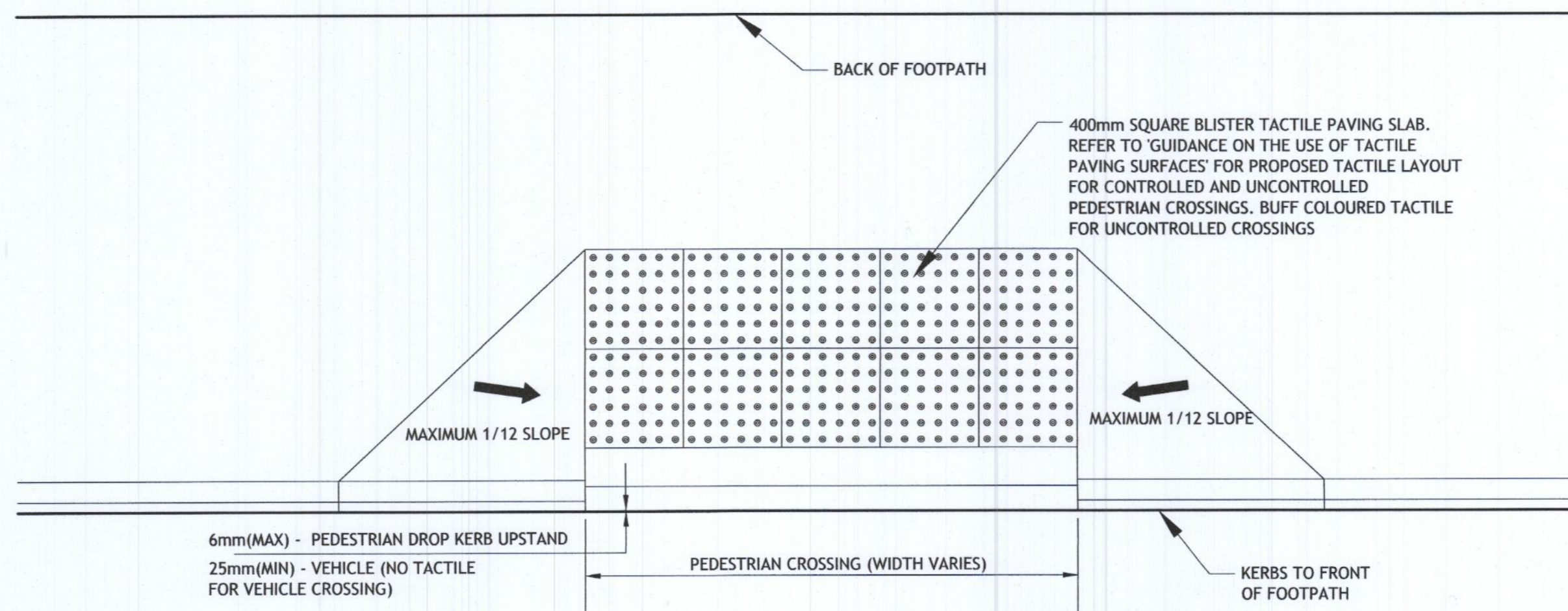

TYPICAL PLAN OF DROPPED KERB (DK)

NOT TO SCALE

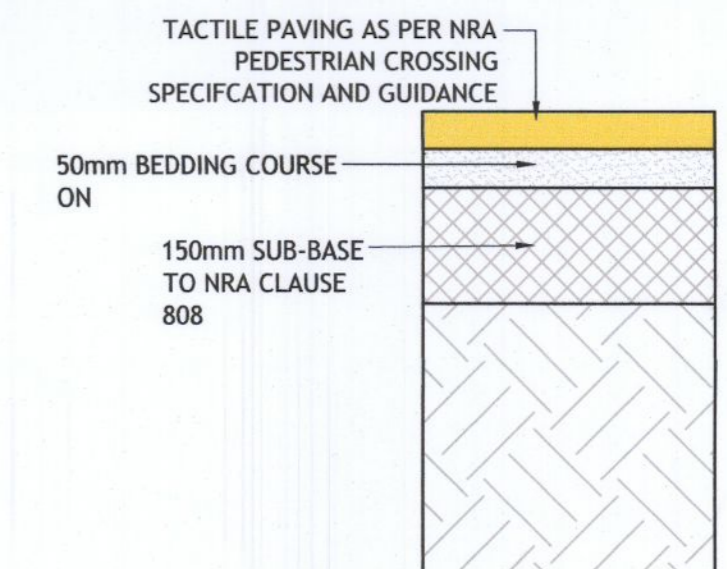

TYPICAL TACTILE PAVING BUILD-UP

NOT TO SCALE

Rev	Amendment	By	Date	Rev	Amendment	By	Date	Client:
C01	PLANNING ISSUE	RD	2022/05/31					MLEU DUBLIN 3 LTD AND CHARLES GREENE

Project: LINK ROAD TO CLONLARA ROAD, BALDONNELL BUSINESS PARK, DUBLIN Z2			
Title: ROAD DETAILS - SHEET 1 OF 2			
Drawn: RD	Date drawn: MAY 2022	Technician Check: RD	Engineer Check: MR
Project No: 212126	Model Ref: 212126-PUN-XX-XX-M2-C-0550	Drawing Status: S2	Approved: 0
Scale of A1: 1:200	Document No: 212126-PUN-XX-XX-DR-C-0550	Revision No: C01	