

SECTION A-A.
SCALE 1:50

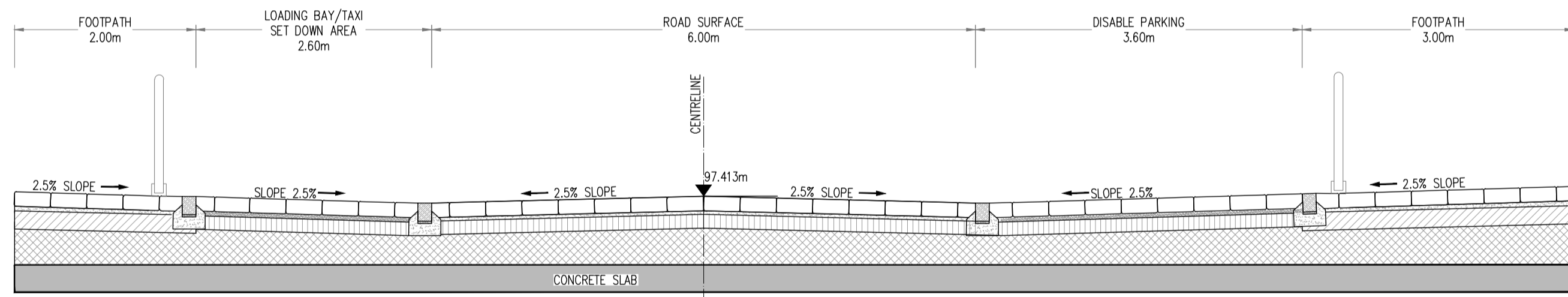

SECTION B-B.
SCALE 1:50

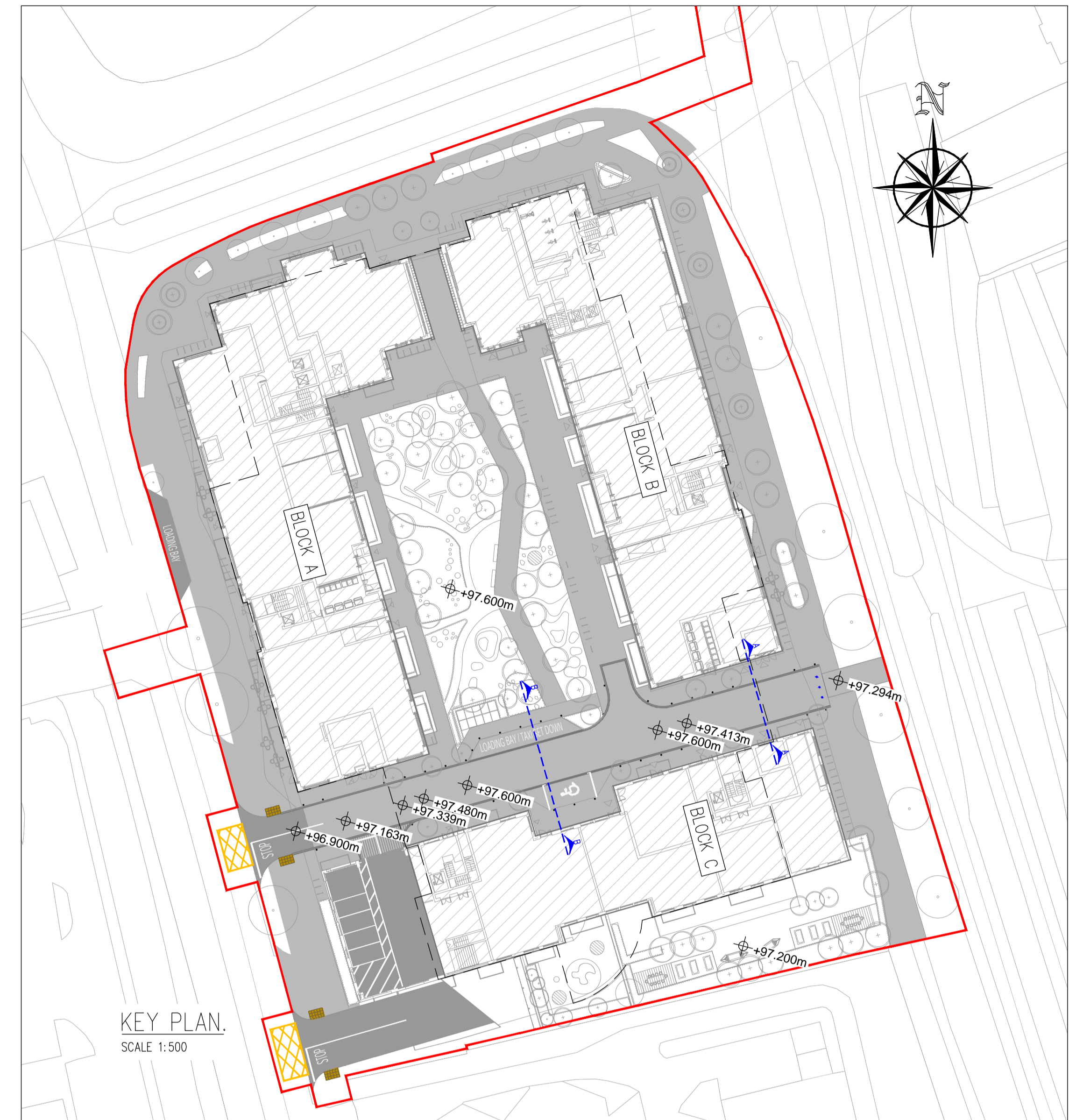

KEY PLAN.
SCALE 1:500

Q003

PLANNING DRAWING.
NOT FOR CONSTRUCTION.
ALL LEVELS GIVEN ARE
RELATIVE TO ORDNANCE DATUM.
THIS DRAWING HAS BEEN ISSUED FOR INFORMATION
PURPOSES ONLY AND MUST NOT BE USED
FOR CONSTRUCTION UNDER ANY CIRCUMSTANCES

- NOTES**
- For setting out refer to Architect's drawings.
 - This drawing to be read in conjunction with all other Architectural and Engineering drawings and all other relevant drawings and Specifications.
 - DO NOT SCALE THIS DRAWING. Use figured dimensions only.
 - No part of this document may be reproduced or transmitted in any form or stored in any retrieval system of any nature without the written permission as copyright holder except as agreed for use on the project for which the document was originally issued.
 - Ordnance Survey Ireland Licence Number EN 0074022

Rev. No.	Date	REVISION NOTE	Dim. By	Chkd. By
P1	03.06.2022	ISSUED FOR PLANNING	IK	FDB

Architect	Henry J. Lyons			
Project	Proposed Development On The Belgard Square East.			
Title	Typical Road Cross Sections			
Dwg. No.	Q003-CSC-ZZ-XX-DR-C-0021			
Date	Dim by	Chkd by	Aprvd by	Scale
April 2022	IK	FDB	NB	As Shown @ A1
				Revision P1

CS Consulting Group
DUBLIN | LONDON | LIMERICK

Head Office
19-22 Dame Street, Dublin 2.
T: +353 (0)1 5480863
e: info@csconsulting.ie
w: www.csconsulting.ie

Quality
Environment
Energy
Health & Safety

I.S. EN ISO 9001:2008
I.S. EN ISO 14001:2004
I.S. EN ISO 50001:2011
OHSAS 18001:2007