

LEGEND:

- SITE BOUNDARY —
- EXISTING STORM SEWER - - -
- EXISTING FOUL SEWER - - -
- EXISTING WATERMAIN —

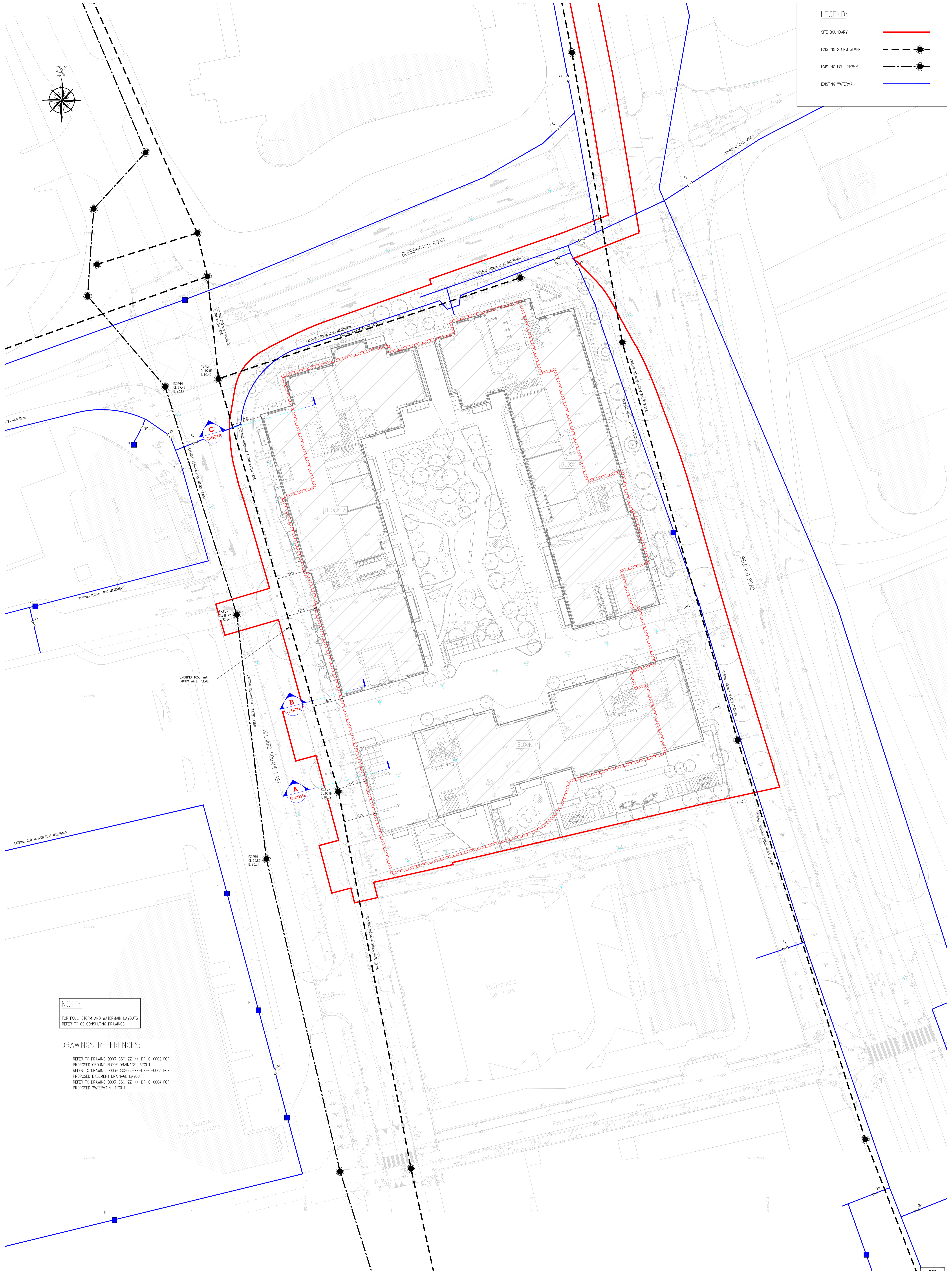
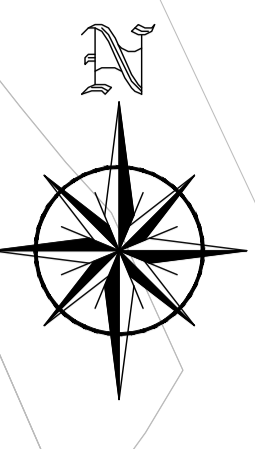

NOTE:
FOR FOUL, STORM AND WATERMAIN LAYOUTS REFER TO CS CONSULTING DRAWINGS.

DRAWINGS REFERENCES:

- REFER TO DRAWING Q003-CSC-ZZ-XX-DR-C-0002 FOR PROPOSED GROUND FLOOR DRAINAGE LAYOUT.
- REFER TO DRAWING Q003-CSC-ZZ-XX-DR-C-0003 FOR PROPOSED BASEMENT DRAINAGE LAYOUT.
- REFER TO DRAWING Q003-CSC-ZZ-XX-DR-C-0004 FOR PROPOSED WATERMAIN LAYOUT.

**PLANNING DRAWING.
NOT FOR CONSTRUCTION.**
ALL LEVELS GIVEN ARE
RELATIVE TO ORDNANCE DATUM.
THIS DRAWING HAS BEEN ISSUED FOR INFORMATION
PURPOSES ONLY AND MUST NOT BE USED
FOR CONSTRUCTION UNDER ANY CIRCUMSTANCES

NOTES

1. For setting out refer to Architect's drawings.
2. This drawing to be read in conjunction with all other Architectural and Engineering drawings and all other relevant drawings and Specifications.
3. DO NOT SCALE THIS DRAWING. Use figured dimensions only.
4. No part of this document may be reproduced or transmitted in any form or stored in any retrieval system of any nature without the written permission of copyright holder except as agreed for use on the project for which the document was originally issued.
5. Ordnance Survey Ireland Licence Number EN 0074022

Rev. No.	Date	REVISION NOTE	Drn. By	Chkd. By
01	03.08.2022	ISSUED FOR PLANNING	JK	FDB

Architect
Project
Title
Date
Drn. By
Chkd. By

Henry J. Lyons
Proposed Development On The
Belgard Square East.
Surface Water Sewer And
Ground Floor
Q003-CSC-ZZ-XX-DR-C-0018
JK FDB NB 1:250 @ A0 P1

C/S Consulting Group
DUBLIN | LONDON | LIMERICK

Head Office
19-21 Dame Street, Dublin 2.
T: +353 (0) 1 5480863
E: info@csconsulting.ie
W: www.csconsulting.ie

Quality
Environment
Energy
Health & Safety

ISO 9001:2015
ISO 14001:2015
ISO 50001:2018
OHSAS 18001:2007