

NOTE : All dimensions to be checked on site prior to construction of the proposed works.

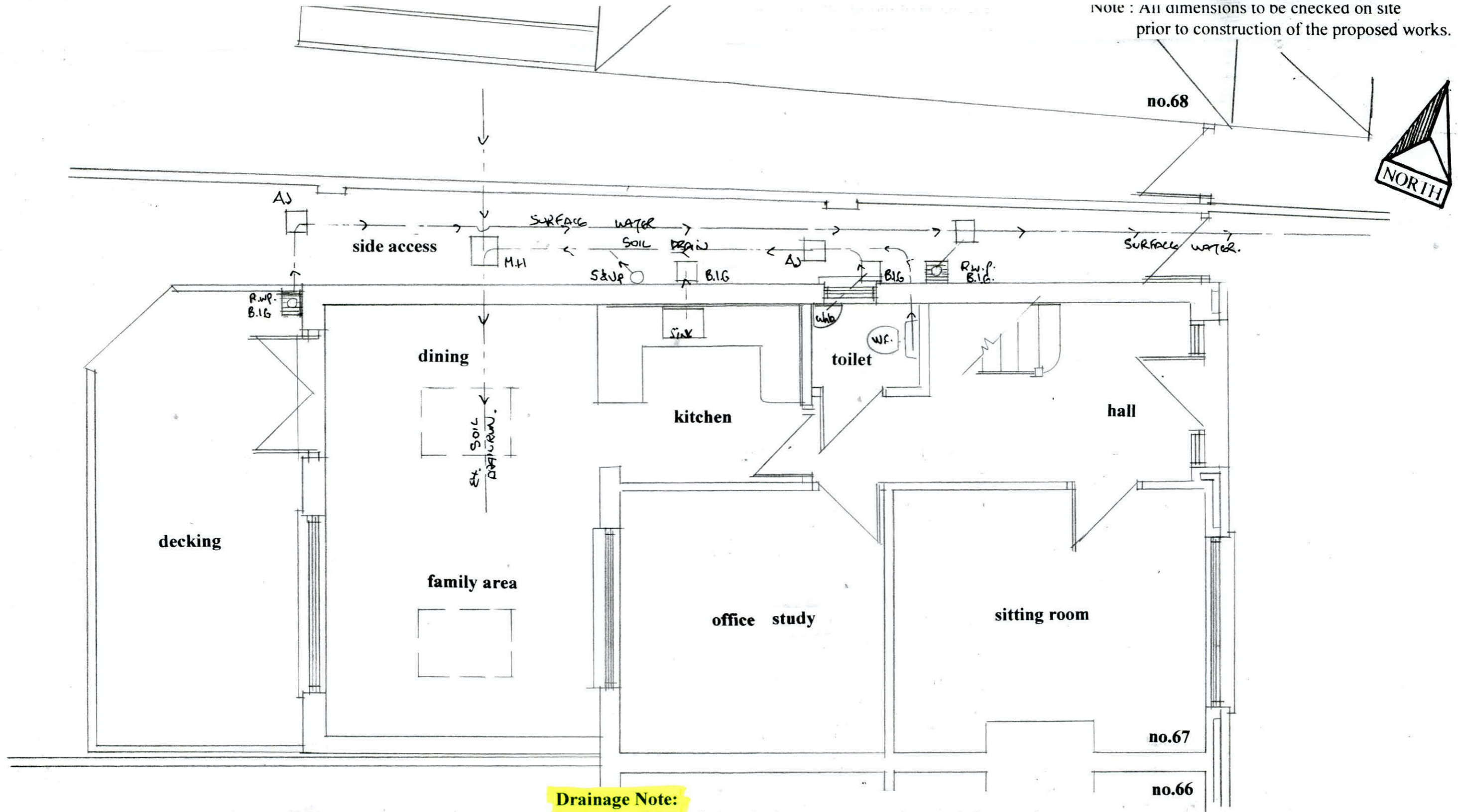

**Proposed Drainage Layout scale 1:50.**

**Drainage Note:**

A survey of the existing drainage system to be carried out prior to the commencement of the proposed works.

The existing drainage system is a separate drainage system.

-all existing rainwater drains discharges into the existing combined system

-all existing & new foul drains discharges into the existing combined drainage system .

-all disused drain runs ; bigs ; gullies; gullies ; ajs to be filled with sand & backfilled with hardcore & concrete finish.

-all new drains ; bigs ; gullies ; ajs to be encased in 150 weak mortar

- all drain runs passing under new structure to have precast concrete lintols over encased in 150 lean concrete.

\*Drawing No. 17.06.2022

**DESMOND J. HALPIN. & ASSOCIATES**  
 PLANNING & BUILDING DESIGN CONSULTANTS  
 15, Carriglea Drive, Phone NO: 0145237  
 Firhouse, Mobile No: 08797345  
 Dublin.24 Registered Company No: 1113  
 E-Mail : DesHALPIN15@GMail.c