

Note : All dimensions to be checked on site prior to construction of the proposed works.

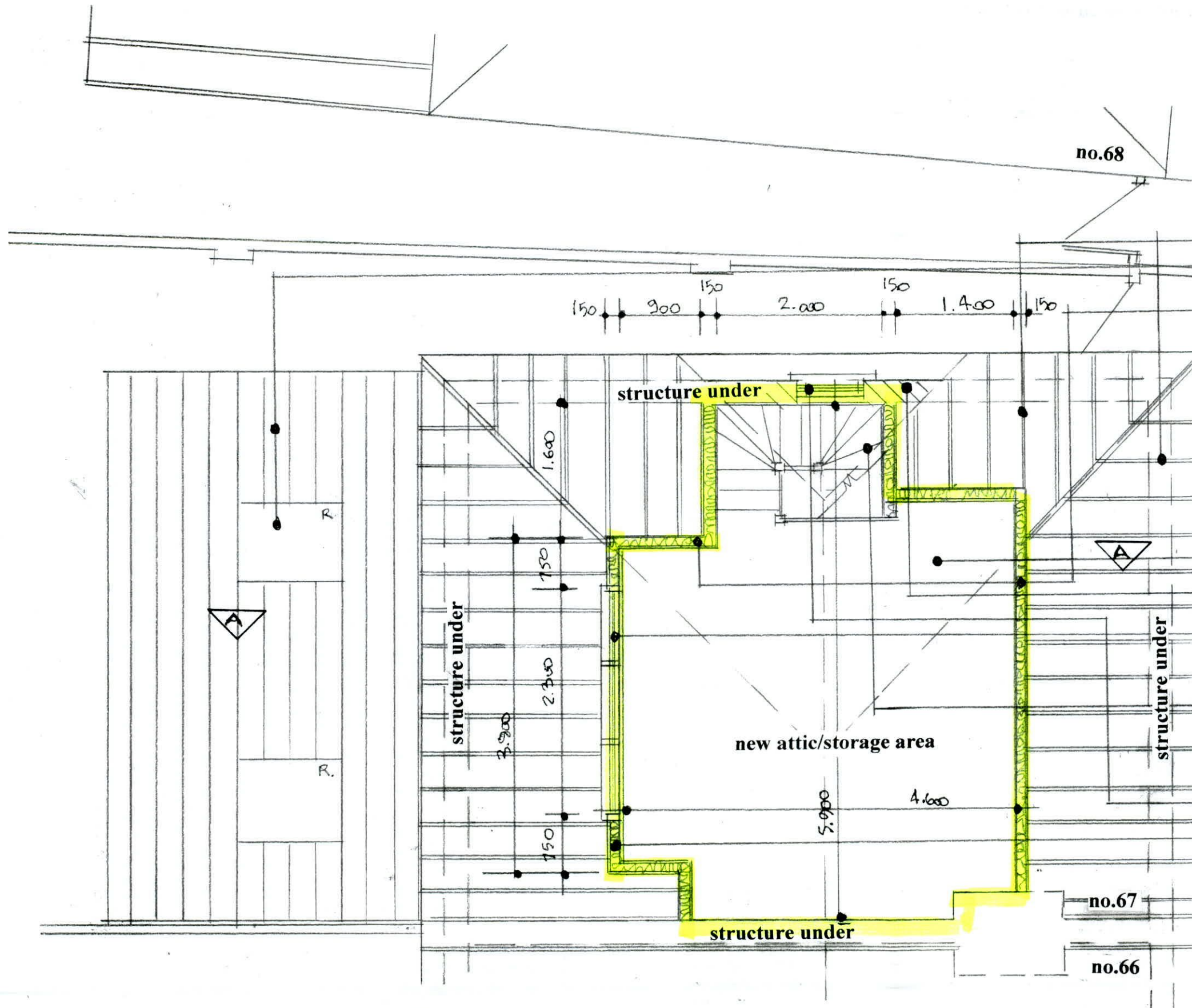

ex. timber roof structure.
ex. concrete tiled roof with rooflight.

new 100x50 timber truss frame structure partition with 100 insulation between studs with 18mm plywood sheeting screwed both sides of frame with galvanized steel hangers fixed to new frame structure to support new timber floor.

new timber floor to be 175x38 floor joists @ 400 centres to run parallel with ex. ceiling joists fix to galvanized steel hangers with t@gboarded floor finish.

new dormer structure to be 150x50 stud frame with 150 insulation between studs with smooth concrete render finish externally on expanded metal on breathable membrane with 65 insulated plasterboard & skim finish internally.

new upvc double glazed window with two no. 175x38 timber joists bolted together head over with upvc cill on dpc on 150x50 stud structure under.

new timber stairs with treads not less than 280 & risers not more than 180 with newel posts, balustrades, handrails & strings to match existing.

new 215 concrete block structure with concrete render finish externally to match ex. with 65 insulated plasterboard & skim finish internally.

new upvc obscure double glazed window with precast concrete lintol over & precast concrete cill in dpc under with concrete render finish externally with 65 insulated plasterboard & skim finish internally.

Proposed Attic Floor Plan scale 1: 50.

Drawing No. 11.06.2022

DESMOND J. HALPIN. & ASSOCIATES
 PLANNING & BUILDING DESIGN CONSULTANTS.
 15, Carriglea Drive, Phone NO: 014523710.
 Firhouse, Mobile No: 0879734595.
 Dublin, 24. Registered Company No: 111360.
 E-Mail : DesHALPIN15@GMail.com