

THIS DRAWING IS ISSUED BY PAUL O'LOUGHLIN + ASSOCIATES (POL+A) AND SHOULD NOT BE USED FOR ANYTHING OTHER THAN ITS ORIGINAL INTENDED USE.
 THIS DRAWING IS PROTECTED BY COPYRIGHT AND IS NOT TO BE REPRODUCED, COPIED OR MANIPULATED IN ANY WAY WITHOUT WRITTEN CONSENT FROM POL+A.
 DO NOT SCALE FROM THIS DRAWING

SITE AREA
 Total Site Area - 4420sq m

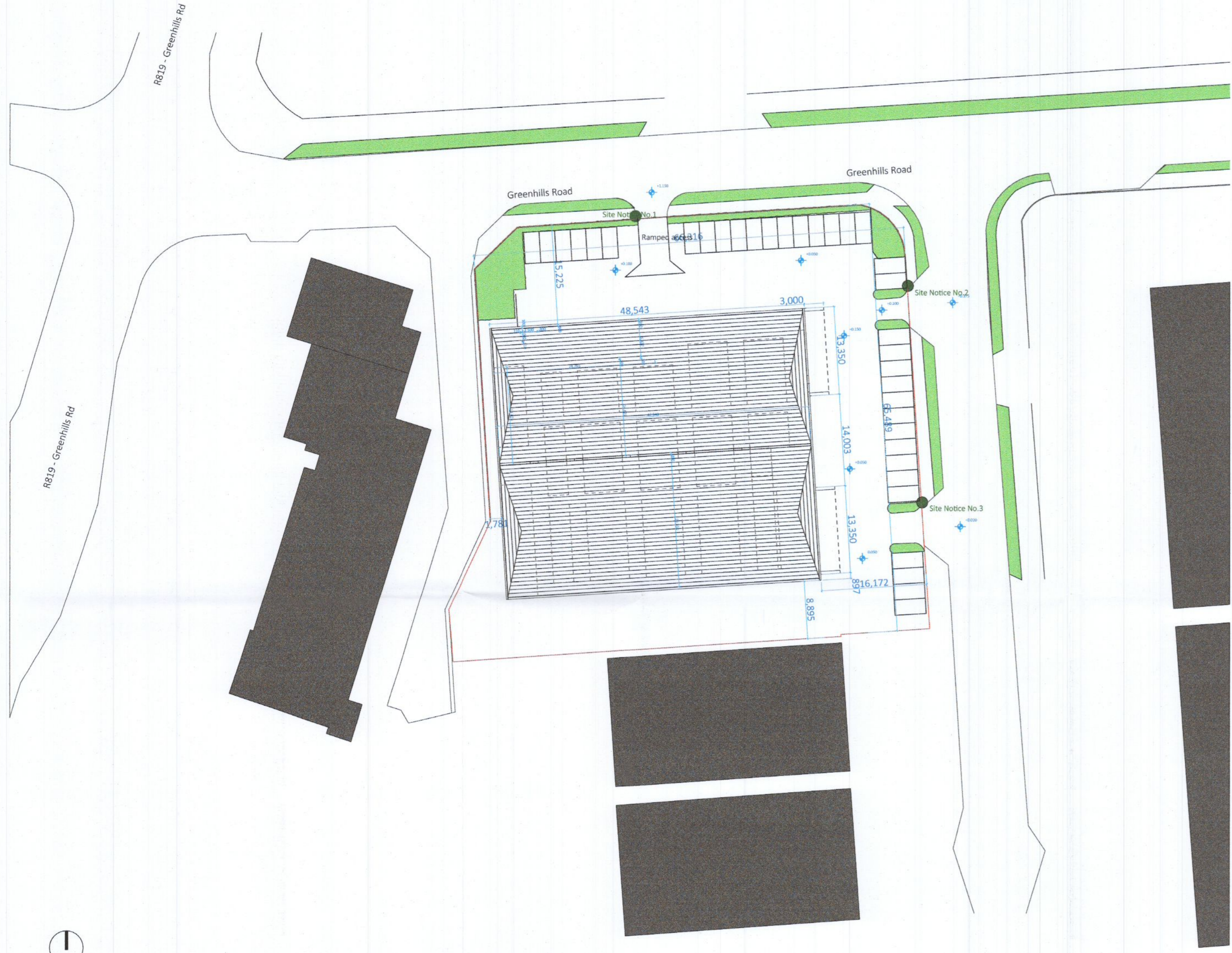

Existing Site Layout
 Scale 1:500

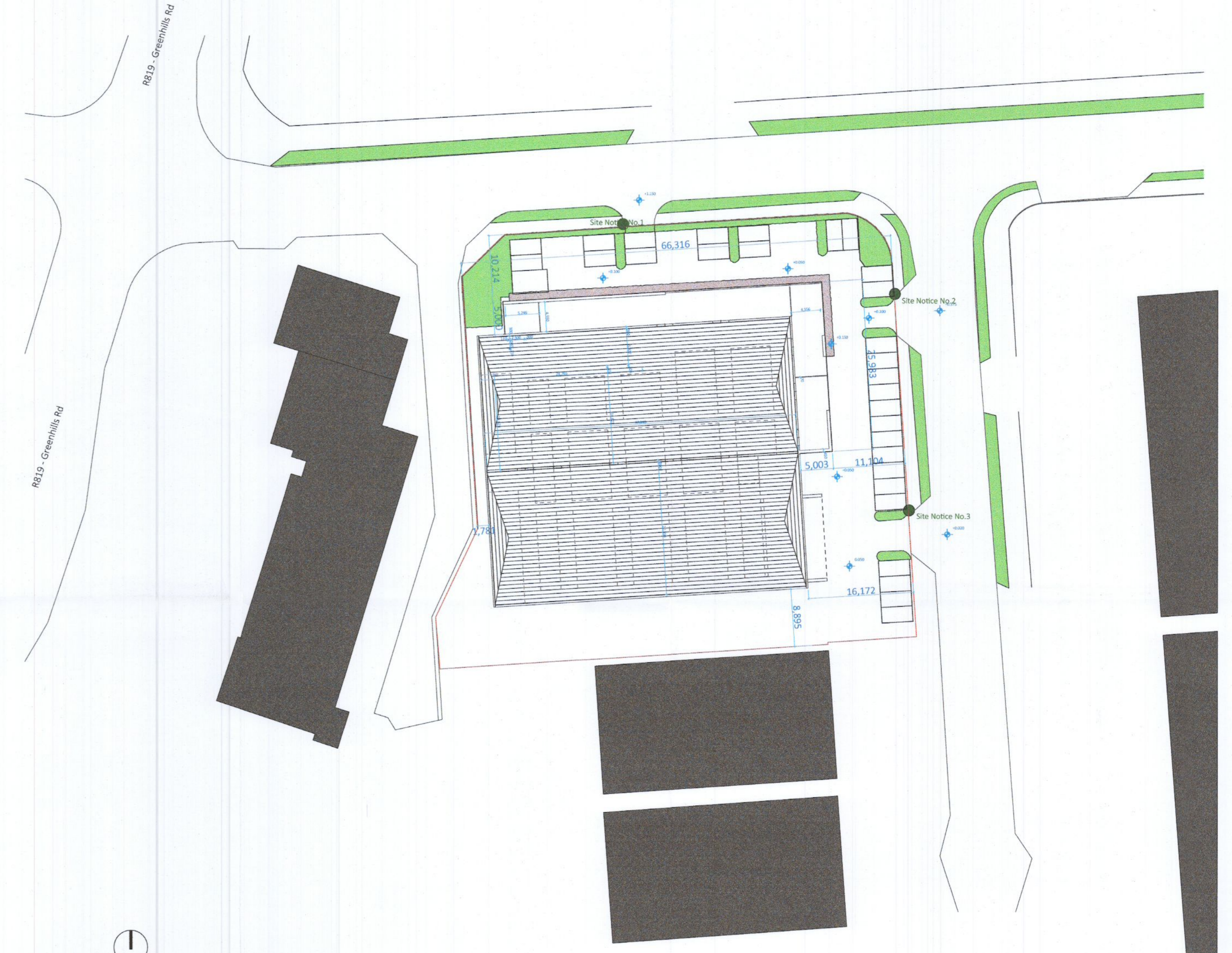

Proposed Site Layout
 Scale 1:500

DRAWING KEY: []
 DRAWING NOTES:
 DRAWING SCALE:
 AS INDICATED

DRAWING STATUS: PLANNING			
DESIGN	DESIGN IN	DESIGN AT	PROVISION

PAUL O'LOUGHLIN + ASSOCIATES
 DALKEY - SANDYFORD W - WWW.PAULOLOUGHLIN.COM
 T - 087 258 5660 E - INFO@PAULOLOUGHLIN.COM

PROJECT ADDRESS:
 17 HIBERNIAN INDUSTRIAL ESTATE,
 GREENHILLS RD, TALLAGHT, DUBLIN 24,
 D24K163

PROJECT REF NUMBER 22-05	DRAWING NUMBER 22-05-PL - 004
FIRST ISSUED 02.05.2022	DRAWING NAME Existing and Proposed Site Layouts
CLIENT GALLUSWOOD LTD	LATEST REVISION