

THIS DRAWING IS ISSUED BY PAUL O'LOUGHLIN + ASSOCIATES (POL+A) AND SHOULD NOT BE USED FOR ANYTHING OTHER THAN ITS ORIGINAL INTENDED USE.  
 THIS DRAWING IS PROTECTED BY COPYRIGHT AND IS NOT TO BE REPRODUCED, COPIED OR MANIPULATED IN ANY WAY WITHOUT WRITTEN CONSENT FROM POL+A.  
 DO NOT SCALE FROM THIS DRAWING.

SITE AREA  
 Total Site Area - 4420sq m

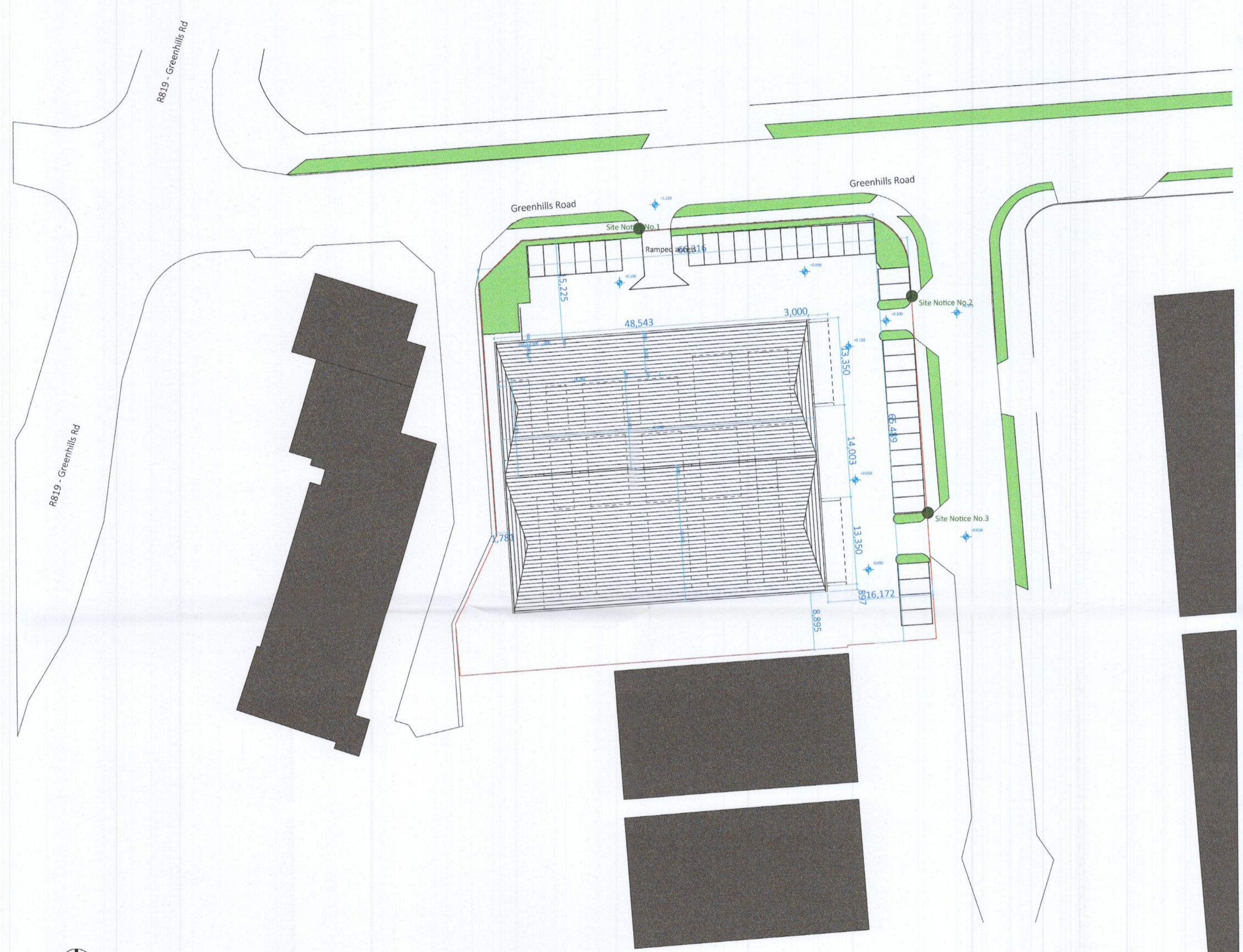

Existing Site Layout  
 Scale 1:500

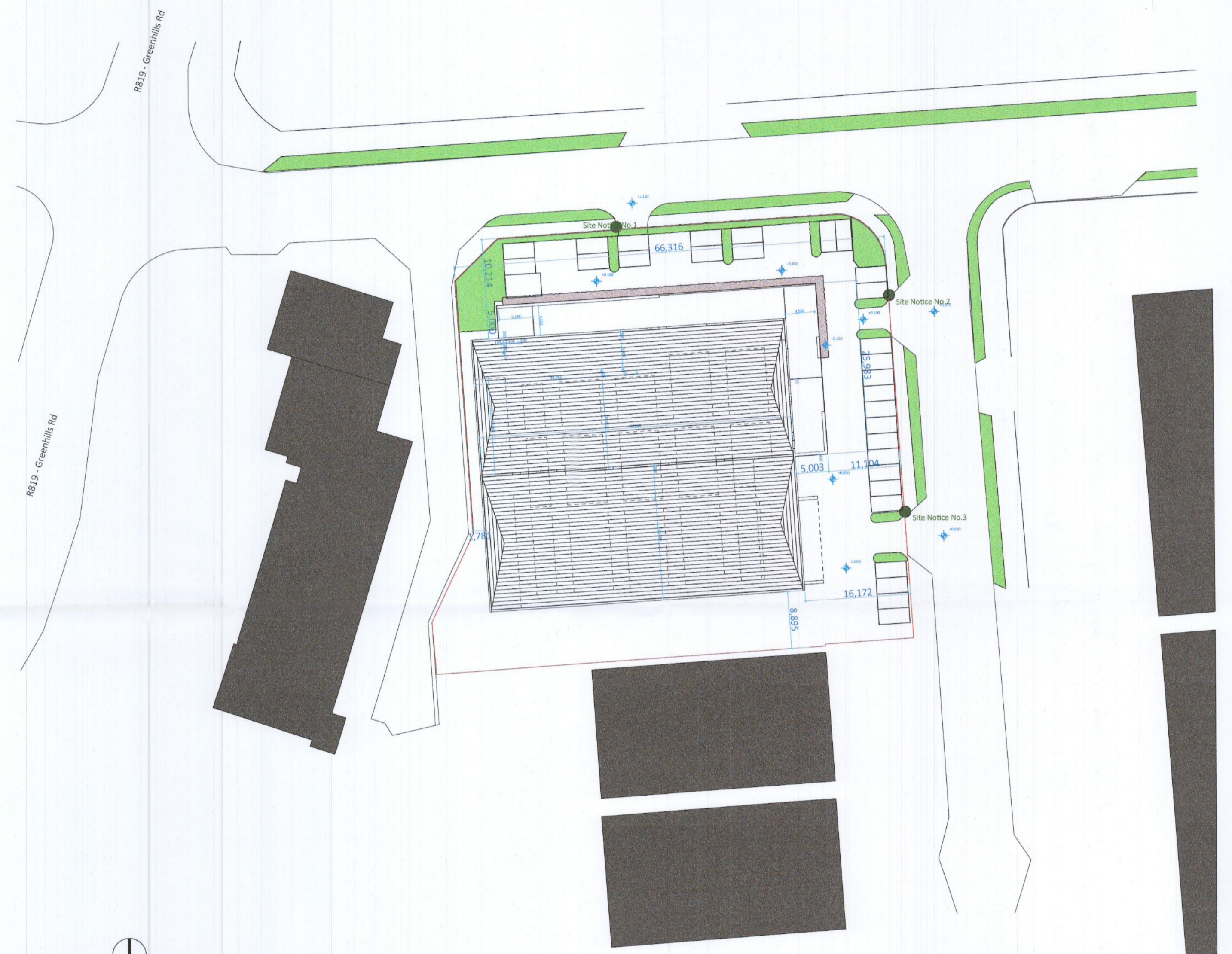

Proposed Site Layout  
 Scale 1:500

DRAWING KEY:	DRAWING NOTES:
DRAWING SCALE:	As Indicated @ A1

Drawing Status: <b>PLANNING</b>			
PROPOSED	ISSUED FOR PERMIT	ISSUED BY:	DISCRETION:

<b>PAUL O'LOUGHLIN + ASSOCIATES</b> ARCHITECTS - CONSTRUCTION - INTERIORS DUBLIN 7, IRELAND    WWW.PAULOLOUGHLIN.COM T: +353 208 5460    E: INFO@PAULOLOUGHLIN.COM	
PROJECT ADDRESS: <b>17 HIBERNIAN INDUSTRIAL ESTATE,          GREENHILLS RD, TALLAGHT, DUBLIN 24,          D24K163</b>	
PROJECT REF NUMBER: <b>22-05</b>	DRAWING NUMBER: <b>22-05-PL - 004</b>
FIRST ISSUED: <b>02.06.2022</b>	DRAWING NAME: <b>Existing and Proposed          Site Layouts</b>
CLIENT: <b>GALLUSWOOD LTD</b>	LATEST REVISION: